

NOTES:

PURCHASED ITEM

MATL: 18-8 SS

5/16"-18 X 1" FHSCS

Hex Size: 3/16"

Head Diameter: 0.656"

Head Height: 0.198"

Head Angle: 82°

Thread Fit: Class 3A

TO HAVE NYLON THD LOCK PATCH

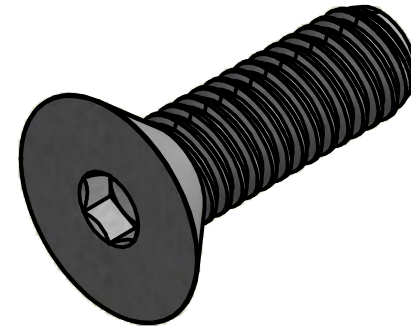

N/A	A	ADDED NYLON PATCH	5/21/12	MJC
ZONE	REV	DESCRIPTION	DATE	APPROVED
REVISION HISTORY				

TOLERANCE UNLESS OTHERWISE SPECIFIED
 DECIMALS 0.00 = +/- 0.010
 DECIMALS 0.000 = +/- 0.005
 FRACTIONS 1/X = +/- 1/32
 ANGLES = +/- 1
 BREAK ALL SHOWN CORNERS W/ 1/32 R UNLESS OTHERWISE SPECIFIED

DRAWN MJC	10/6/2008
CHECKED	
QA	
MFG	
APPROVED	



BANJO CORPORATION
 150 BANJO DRIVE, CRAWFORDSVILLE, IN 47933

TITLE
 5/16-18 X 1" FHSCS

SIZE	DWG TYPE	DWG NO	REV
A	ENG	17130	A
SCALE		SHEET 1 OF 1	