

$\phi 7\frac{7}{16}$ ON A
 $\phi 6\frac{3}{4}$ B.C.
 SPACED 60° AS SHOWN

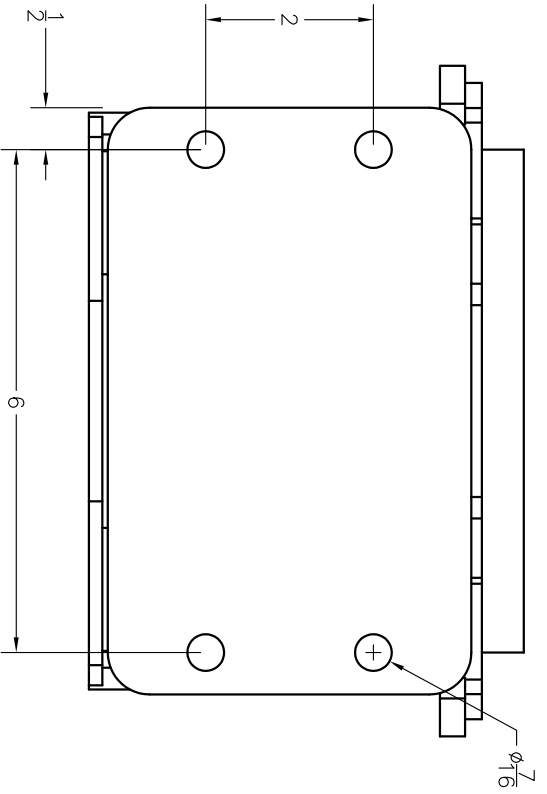

THIS DRAWING AND ALL INFORMATION CONTAINED HEREIN ARE THE PROPERTY OF BANJO CORPORATION. NO PART OF THIS DRAWING OR ANY INFORMATION CONTAINED HEREIN IS TO BE REPRODUCED OR TRANSMITTED IN ANY FORM OR BY ANY MEANS, ELECTRONIC OR MECHANICAL, INCLUDING PHOTOCOPYING, RECORDING, OR BY ANY INFORMATION STORAGE AND RETRIEVAL SYSTEM, WITHOUT THE WRITTEN PERMISSION OF BANJO CORPORATION. THIS DRAWING IS SUBJECT TO CHANGE WITHOUT NOTICE.

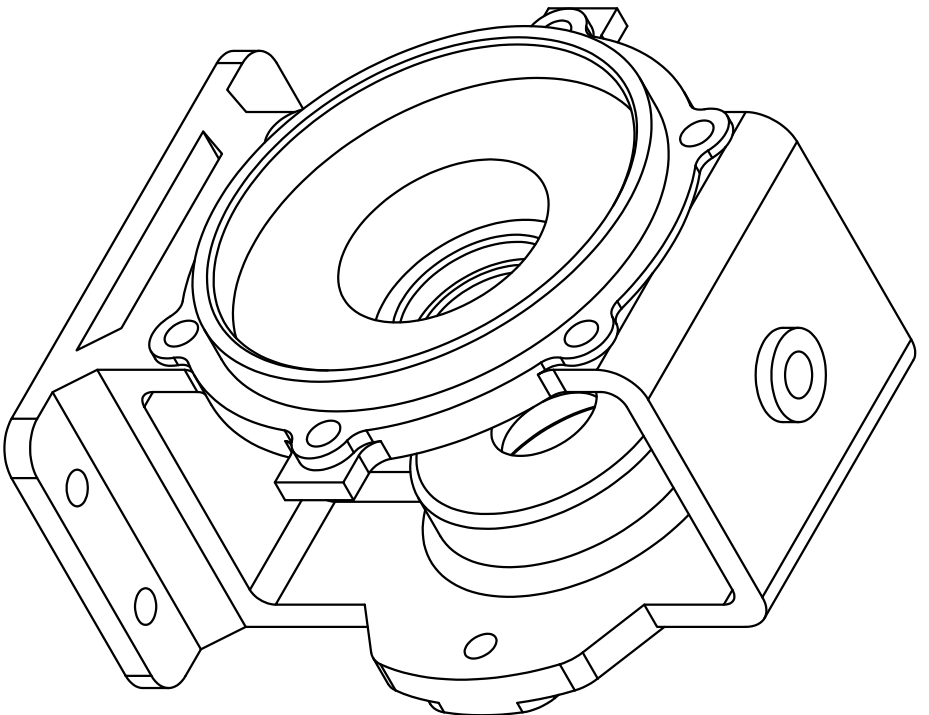

BANJO CORPORATION
 150 BANJO DR. • CRAWFORDSVILLE, IN 47933

PART NO. 18049

TITLE
 HYD. MOTOR ADAPTER