

Parts List			
ITEM	QTY	PART NUMBER	DESCRIPTION
1	1	12777	1/2" DRAIN PLUG
2	4	12901	5/16" FLAT WASHER
4	1	15022	2" PUMP HANDLE
5	1	17010	1/2-13 HEX NUT
6	1	17018	PUMP ADAPTER GASKET
7	1	17033	Z-RAIL (PAIR)
8	4	17034	5/16-18 X 1-1/2" HHCS
9	1	17123	CI PUMP KEYED CLAMP
10	1	17200A	NEW 2" CI WET SEAL ASSEMBLY
10-1	1	12777	1/2" DRAIN PLUG
10-2	1	17009B	5/8-18 IMPELLER NUT
10-3	1	17018	PUMP ADAPTER GASKET
10-4	1	17032	1/4" NPT DRAIN PLUG
10-5	4	17040	5/16-24 X 1" HHCS
10-6	1	17201A	WET SEAL RESERVOIR, NEW
10-7	1	17202	COVER PLATE
10-8	1	17206A	ADAPTER SHAFT
10-9	1	17208	PUMP IMPELLER
10-10	1	17235	MECH. SEAL ASSY.
10-11	6	17242	5/16-18 x 1 15/16" STUD
10-12	1	UV15163	AS568A -114 O-RING, EPDM, BLACK
10-13	4	V10118	5/16" LOCKWASHER
11	1	17226	2" WET SEAL PUMP HOUSING SUB-ASSY
12	1	E5H	5.5 HP HONDA GX160
13	1	UV15163	AS568A -114 O-RING, EPDM, BLACK
14	10	V10118	5/16" LOCKWASHER
15	10	V10119	5/16"-18 SS NUT

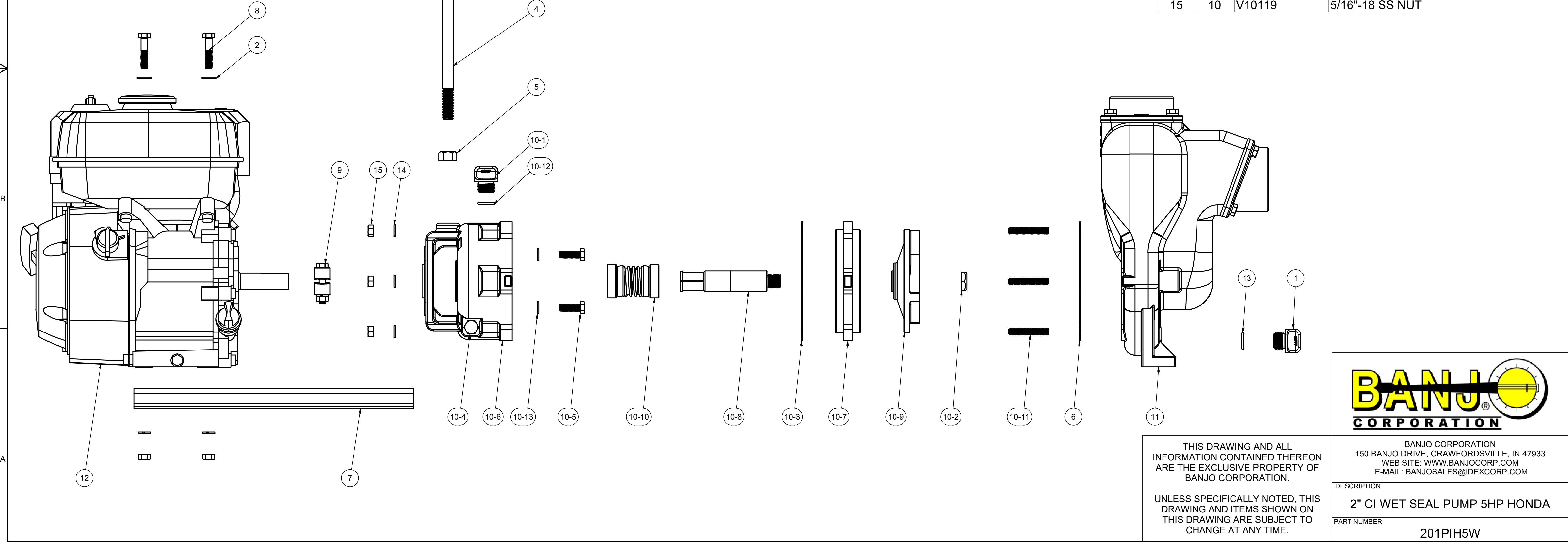

THIS DRAWING AND ALL INFORMATION CONTAINED THEREON ARE THE EXCLUSIVE PROPERTY OF BANJO CORPORATION.

UNLESS SPECIFICALLY NOTED, THIS DRAWING AND ITEMS SHOWN ON THIS DRAWING ARE SUBJECT TO CHANGE AT ANY TIME.

BANJO CORPORATION
 150 BANJO DRIVE, CRAWFORDSVILLE, IN 47933
 WEB SITE: WWW.BANJO.CORP.COM
 E-MAIL: BANJOSALES@DEXCORP.COM

DESCRIPTION
2" CI WET SEAL PUMP 5HP HONDA

PART NUMBER
201PIH5W