

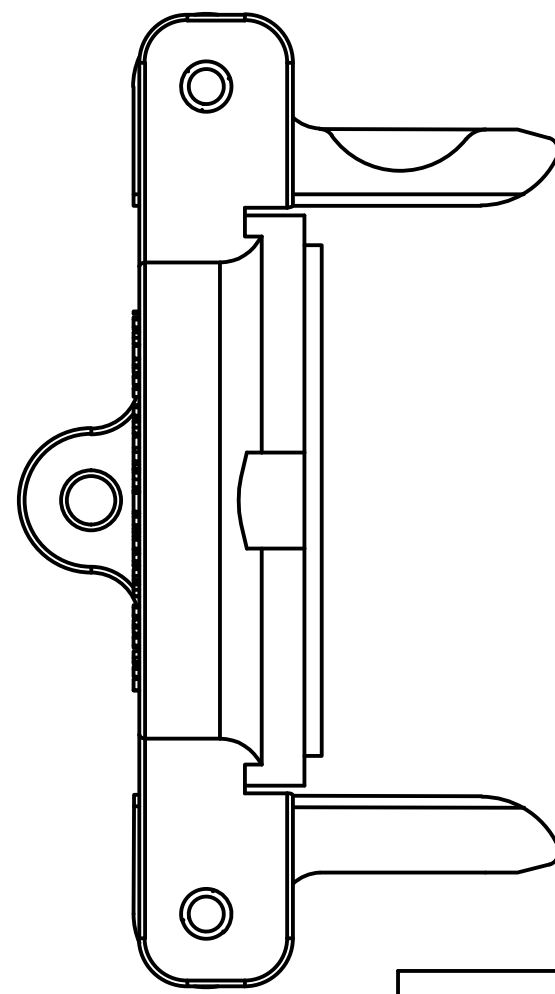

Parts List			
ITEM	QTY	PART NUMBER	DESCRIPTION
1	2	200P	CAM ARM PIN
2	1	DB20311V	2" Drymate Dust Cap Gasket
3	1	DB20312AP	2" SS DM PLUG BODY, MACHINED
4	1	DB20314	2" Drymate Plug Insert
5	2	DM20300	2" DRYMATE PROFILE INSERT

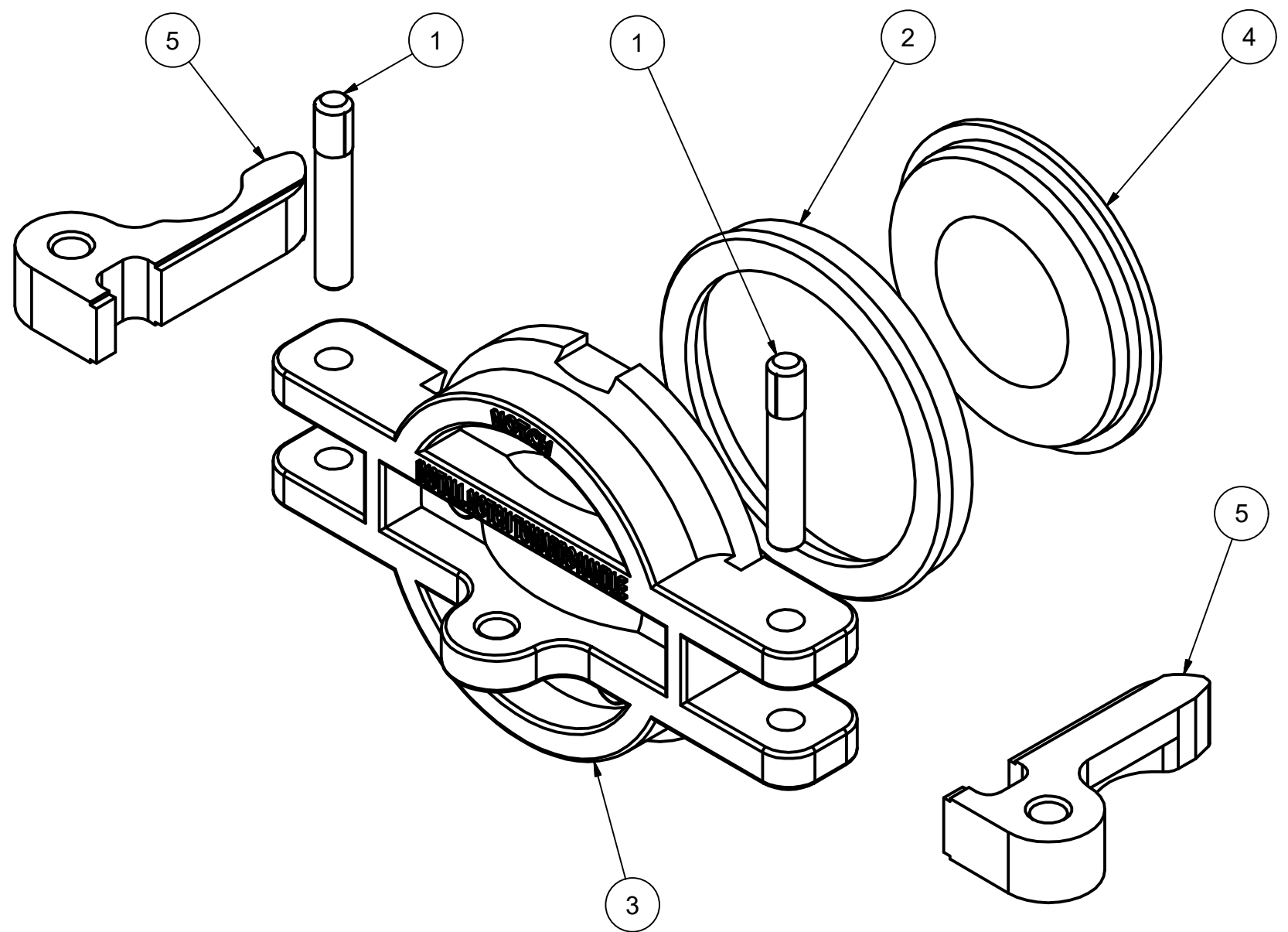

THIS DRAWING AND ALL INFORMATION CONTAINED THEREON ARE THE EXCLUSIVE PROPERTY OF BANJO CORPORATION.

UNLESS SPECIFICALLY NOTED, THIS DRAWING AND ITEMS SHOWN ON THIS DRAWING ARE SUBJECT TO CHANGE AT ANY TIME.

	
<b>BANJO CORPORATION</b> 150 BANJO DRIVE, CRAWFORDSVILLE, IN 47933 WEB SITE: WWW.BANJOCORP.COM E-MAIL: BANJOSALES@IDEXCORP.COM	
DESCRIPTION	2" DRYMATE PLUG ASSY
PART NUMBER	DM200APL