

4

3

2

1

PARTS LIST

ITEM	QTY	PART NUMBER	DESCRIPTION
1	2	200P	CAM ARM PIN
2	1	DB20311V	2" Drymate Dust Cap Gasket
3	1	DB20312P	2" POLY DRY-MATE PLUG BODY, MACHINED
4	1	DB20314	2" Drymate Plug Insert
5	2	DM20300	2" DRYMATE PROFILE INSERT

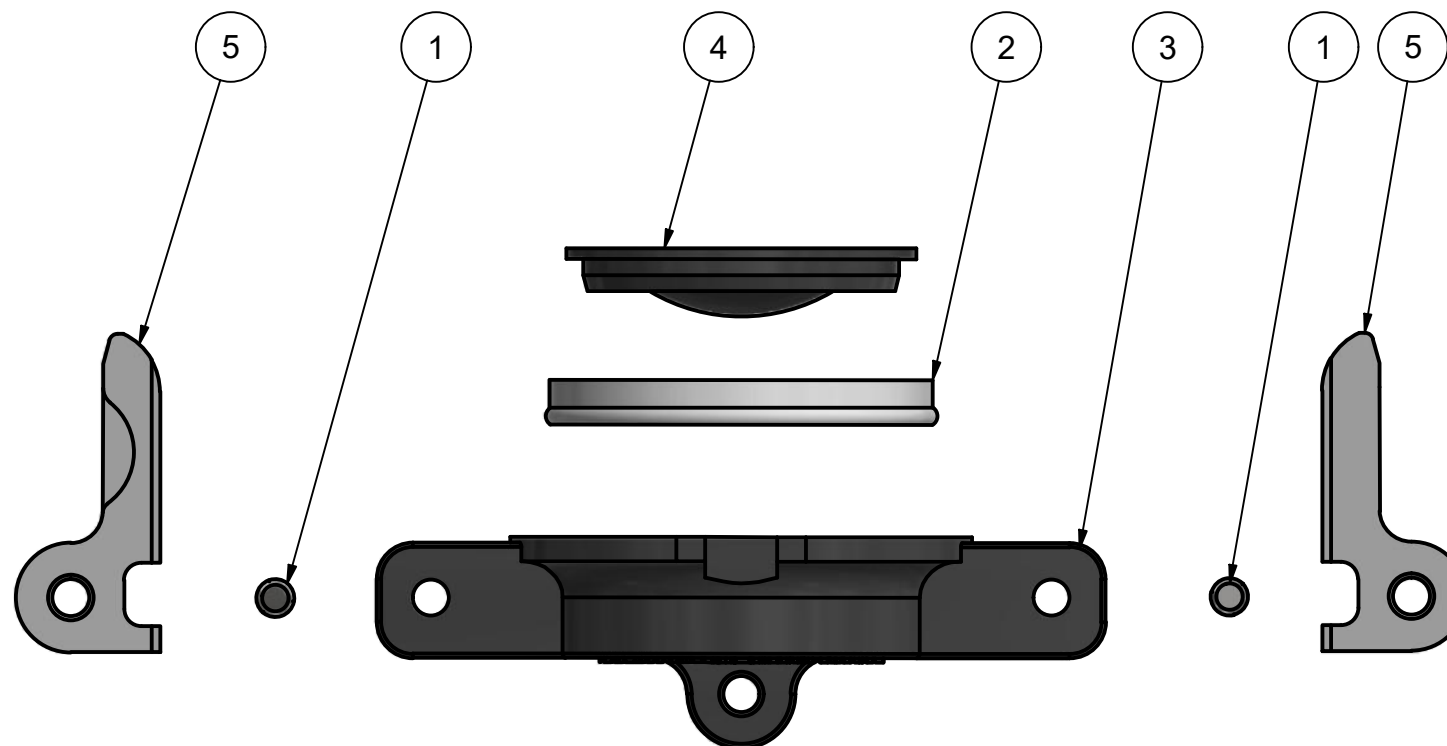
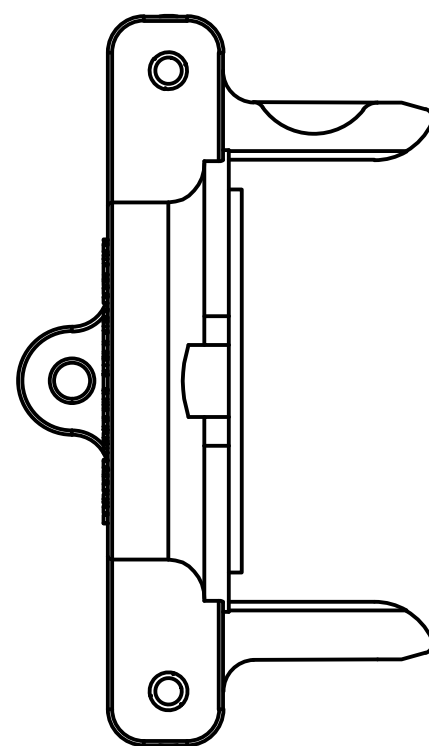
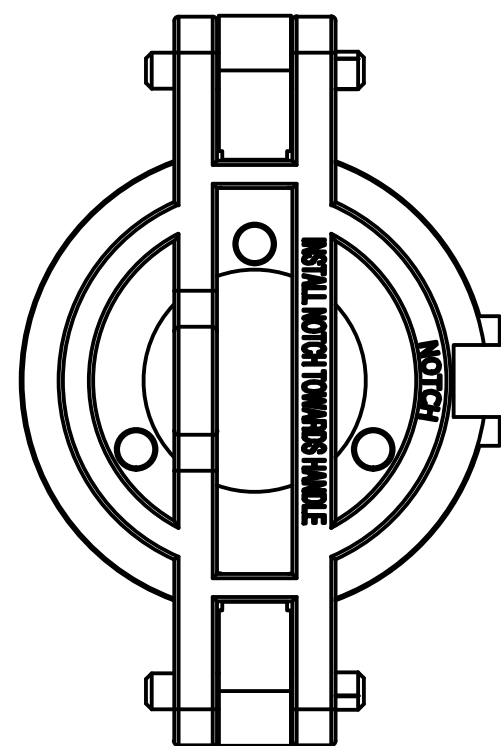

**BANJO CORPORATION**

150 BANJO DRIVE, CRAWFORDSVILLE, IN 47933  
 WEB SITE: WWW.BANJOCORP.COM  
 E-MAIL: BANJOSALES@IDEXCORP.COM

DESCRIPTION

2" DRYMATE PLUG

PART NUMBER

DM200PL

THIS DRAWING AND ALL INFORMATION CONTAINED THEREON ARE THE EXCLUSIVE PROPERTY OF BANJO CORPORATION.

UNLESS SPECIFICALLY NOTED, THIS DRAWING AND ITEMS SHOWN ON THIS DRAWING ARE SUBJECT TO CHANGE AT ANY TIME.

4

3

2

1

B

B

A

A