

PARTS LIST			
ITEM	QTY	PART NUMBER	DESCRIPTION
1	2	DB20281	DRY MATE HANDLE INTERLOCK SPRING
2	1	DM220PL	2" FP DM DUST PLUG
3	1	DM25001	DM220 SEAL BACK RING
4	1	DM25002	DM SPIRAL RETAINING RING, SS 316
5	2	DM25004	CLAMP ARM GROOVE PIN
6	2	DM25009	DM CLAMP ARM
7	2	DM25010A	2" FP DRYMATE CLAMP LEVER 3/8" PIN, SS
8	4	DM25018A	2" FP DRYMATE CLAMP PIN
9	4	DM25020	2" FP DRYMATE CLAMP PIN SET SCREW
10	1	DM25151SS	2" FP SS DM STEM
11	1	DM25153SSF	2" FP DRYMATE FEMALE HANDLE
12	1	DM25154SS	2" FP FEMALE DRYMATE INTERLOCK
13	1	DM25204SS	DM220 BODY GASKET
14	1	DM25254FSS	2" FP FEMALE SS DM BODY, MACHINED
15	1	DM25255SSHF	2" FP DM SS HOLLOW BALL FEMALE
16	1	DM25256BSS	2" FEMALE BSPP FP DRYMATE SS ENDPLATE
17	1	DM25258FV1	2" FP DM FILLED VALVE BODY SEAT
18	1	DM25258FV2	2" FP DM FILLED VALVE EP SEAT
19	1	DM25288FSS	HANDLE INTERLOCK
20	1	DM25289SS	2" FP DRYMATE LOCKING YOKE
21	1	DM25294	2" FP DM FACE SEAL
22	1	VSS15020	5/8"-18 SS JAM NUT
23	1	VSS15021	5/8" LOCKWASHER
24	1	VSS15060	THRUST WASHER, ID 0.676", PTFE
25	1	VSS15159	1 1/2" SS GLAND NUT
26	1	VSS15160	2" SS DM V-PACKING

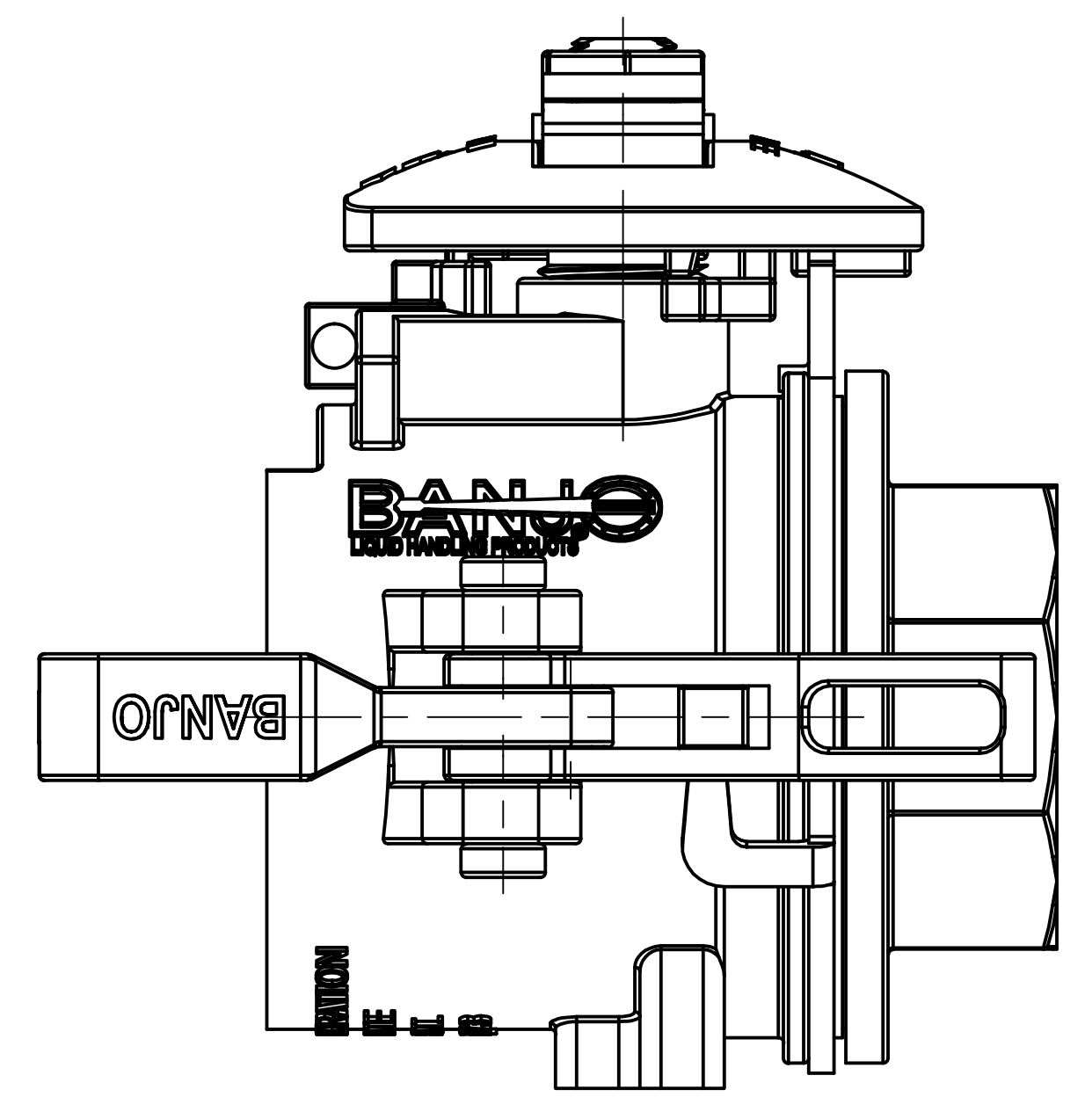
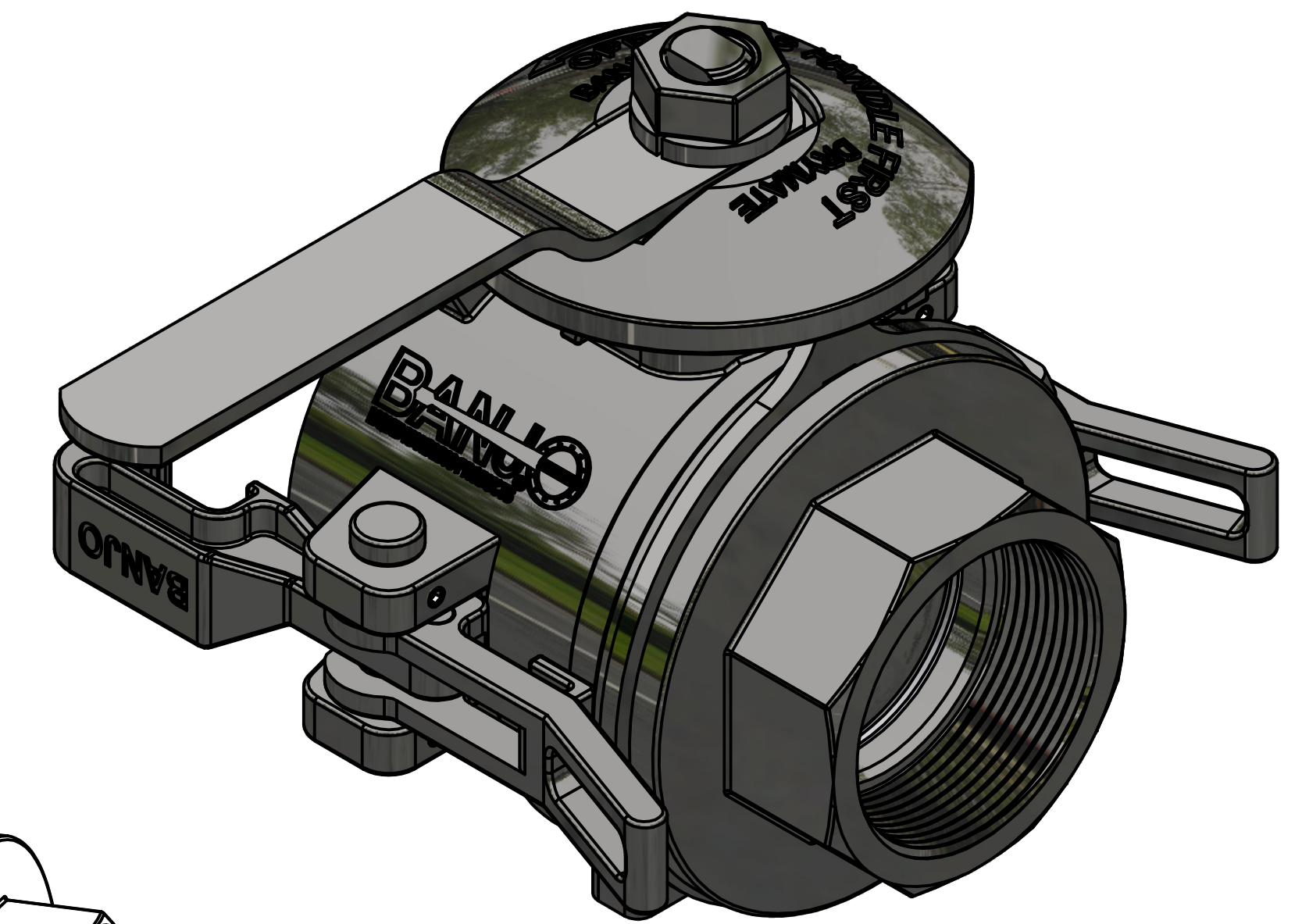
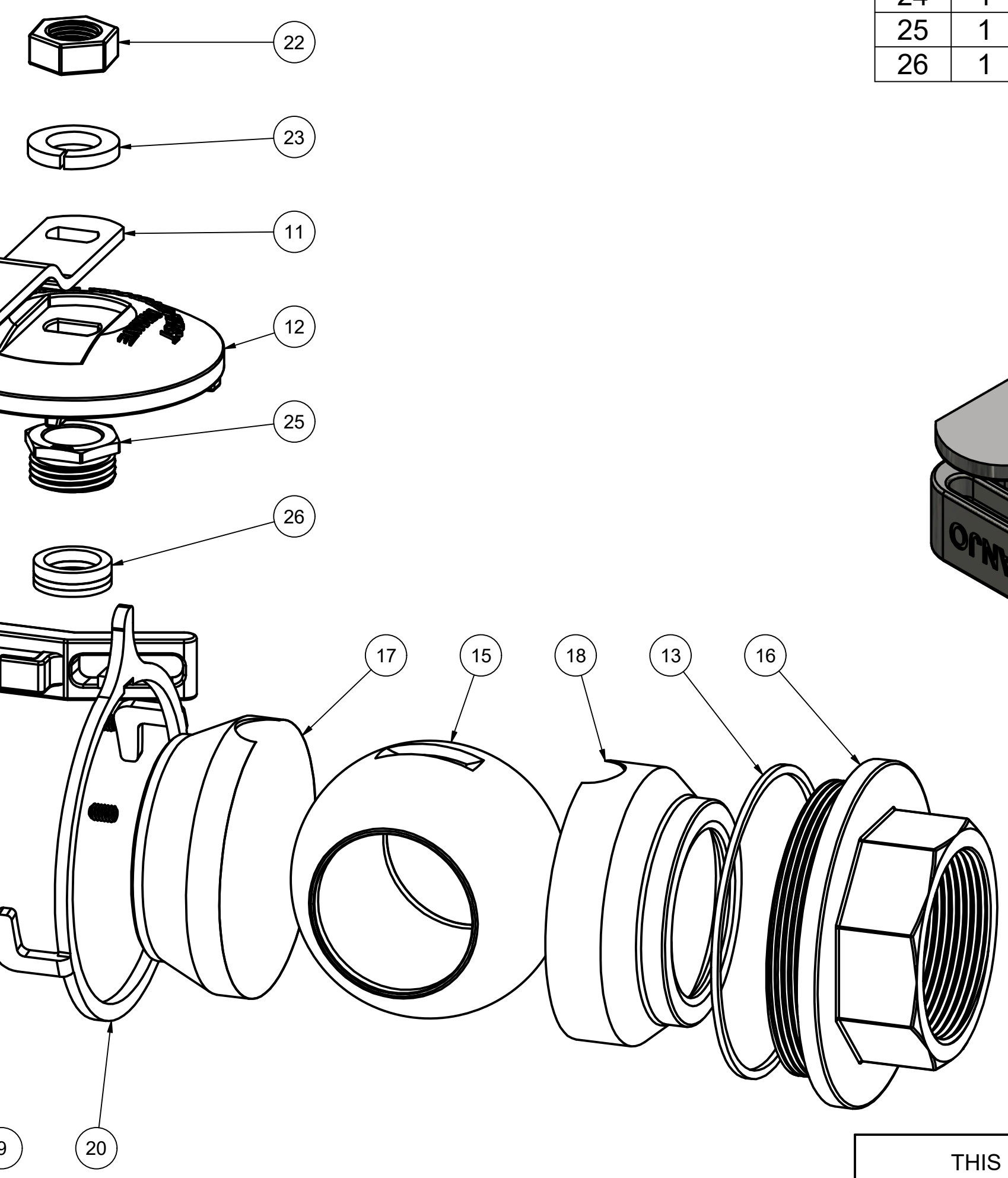

THIS DRAWING AND ALL INFORMATION CONTAINED THEREON ARE THE EXCLUSIVE PROPERTY OF BANJO CORPORATION.

UNLESS SPECIFICALLY NOTED, THIS DRAWING AND ITEMS SHOWN ON THIS DRAWING ARE SUBJECT TO CHANGE AT ANY TIME.

BANJO CORPORATION  
 150 BANJO DRIVE, CRAWFORDSVILLE, IN 47933  
 WEB SITE: WWW.BANJO.CORP.COM  
 E-MAIL: BANJOSALES@DEXCORP.COM

DESCRIPTION  
 2" SS FP FEMALE x FEMALE BSPP w/ FKM SEALS

PART NUMBER  
 DM220DBSS