

Parts List				
ITEM	QTY	PART NUMBER	DESCRIPTION	
1	1	F1	DPC Female Body	
2	1	F2	Outer Plunger	
3	1	F3	Sleeve Stop	
4	1	F4	Sleeve	
5	1	F5	Female DPC Endcap	
6	1	F6	SPRING RETAINER	
7	1	F7	SPRING RETAINING WIRE	
8	1	F8	CAM SLEEVE	
9	3	F9	Cam Pin	
10	2	F10	2-121 O-ring, FKM	
11	1	F11	Female Sleeve Spring	
12	1	F12	FMLE OUTER PLUNGER SPRING	
13	1	F13	Female Cam Sleeve Spring	

FKM SEALS.
NO USER SERVICEABLE PARTS.

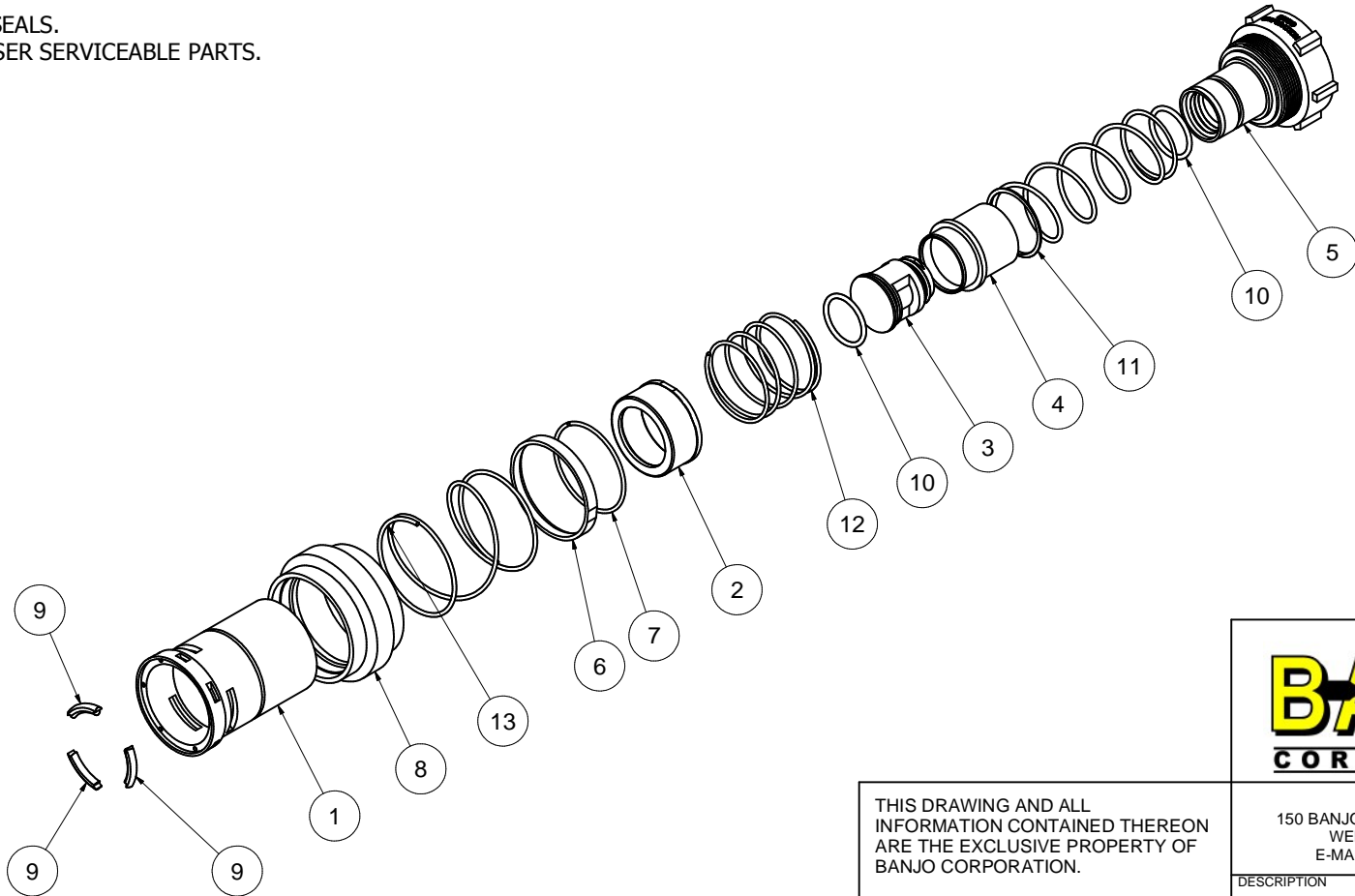

THIS DRAWING AND ALL INFORMATION CONTAINED THEREON ARE THE EXCLUSIVE PROPERTY OF BANJO CORPORATION.

UNLESS SPECIFICALLY NOTED, THIS DRAWING AND ITEMS SHOWN ON THIS DRAWING ARE SUBJECT TO CHANGE AT ANY TIME.

BANJO CORPORATION
150 BANJO DRIVE, CRAWFORDSVILLE, IN 47933
WEB SITE: WWW.BANJOCORP.COM
E-MAIL: BANJOSALES@IDEXCORP.COM

DESCRIPTION
FEMALE DQD ASSEMBLY

PART NUMBER
DPCF100