

Parts List			
ITEM	QTY	PART NUMBER	DESCRIPTION
1	1	M1B	1" MALE BAYONET BODY W/ 2" NPT, MACHINED
2	1	M2	DPC PLUNGER
3	1	M3	ADAPTER INELT, 1"
4	1	M4	AS568A -126 O-RING, FKM, BROWN
5	1	M5	AS568A -130 O-RING, FKM, BROWN
6	1	M6B	MALE PLUNGER SPRING
7	1	M7	LANYARD (NS)
8	1	MC1X	MALE DPC CAP
9	1	MC2	BAYONETTE DPC CAP GASKET

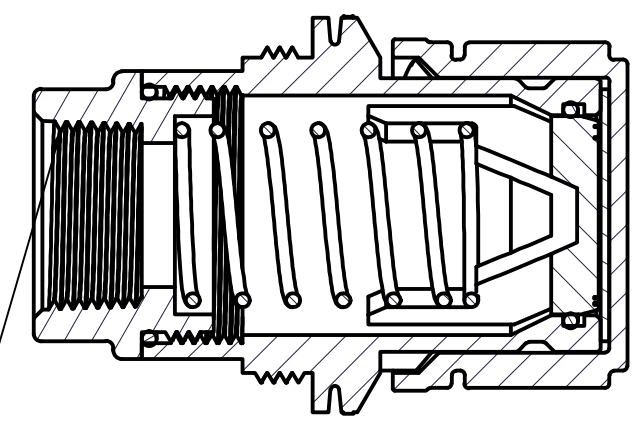
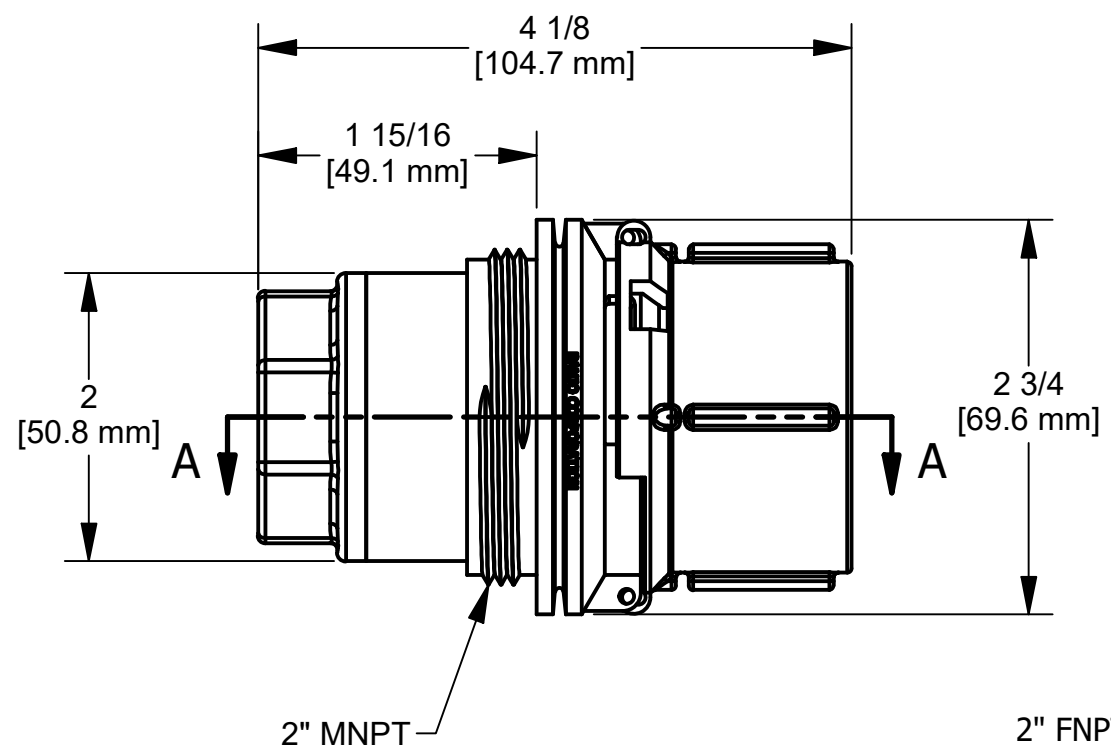
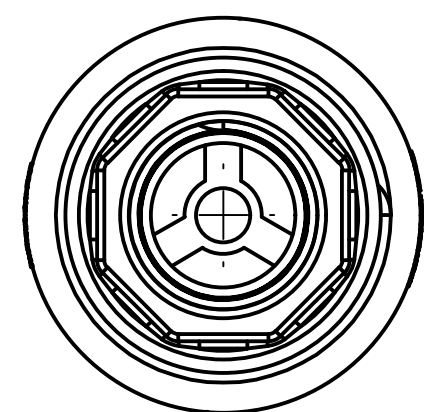

SECTION A-A

NOTES:
SEALS: FKM
NO USER SERVICEABLE PARTS.

THIS DRAWING AND ALL INFORMATION CONTAINED THEREON ARE THE EXCLUSIVE PROPERTY OF BANJO CORPORATION.
UNLESS SPECIFICALLY NOTED, THIS DRAWING AND ITEMS SHOWN ON THIS DRAWING ARE SUBJECT TO CHANGE AT ANY TIME.

BANJO
CORPORATION

BANJO CORPORATION
150 BANJO DRIVE, CRAWFORDSVILLE, IN 47933
WEB SITE: WWW.BANJOCORP.COM
E-MAIL: BANJOSALES@IDEXCORP.COM

DESCRIPTION
1" MALE DQD ASSEMBLY

PART NUMBER
DPCMT100