

4

3

2

1

PARTS LIST

ITEM	QTY	PART NUMBER	DESCRIPTION
2	1	EVP20001	EV U-PIN
3	1	EVX075BLX	EVX 3/4" NPT BL BOLTED VALVE ONLY
1	1	EP21A10310	EVX ACT 0.75S WWC 3W

WIRING:
 RED = +12VDC
 BLACK = GND
 WHITE = +12VDC (OPEN), 0VDC (CLOSE)

WIRE LENGTH: 18" ± 1"

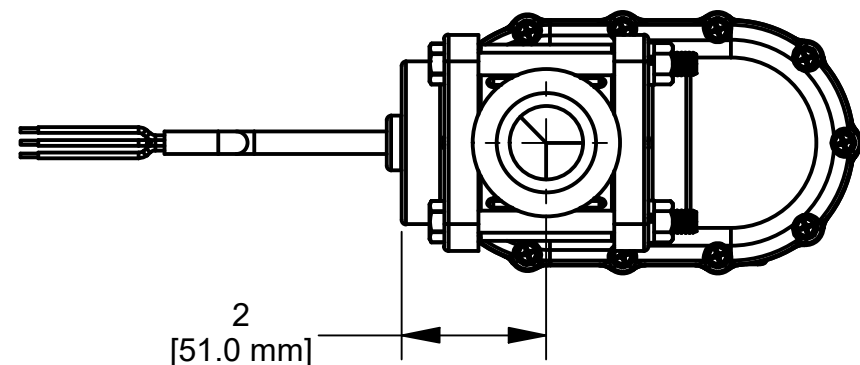
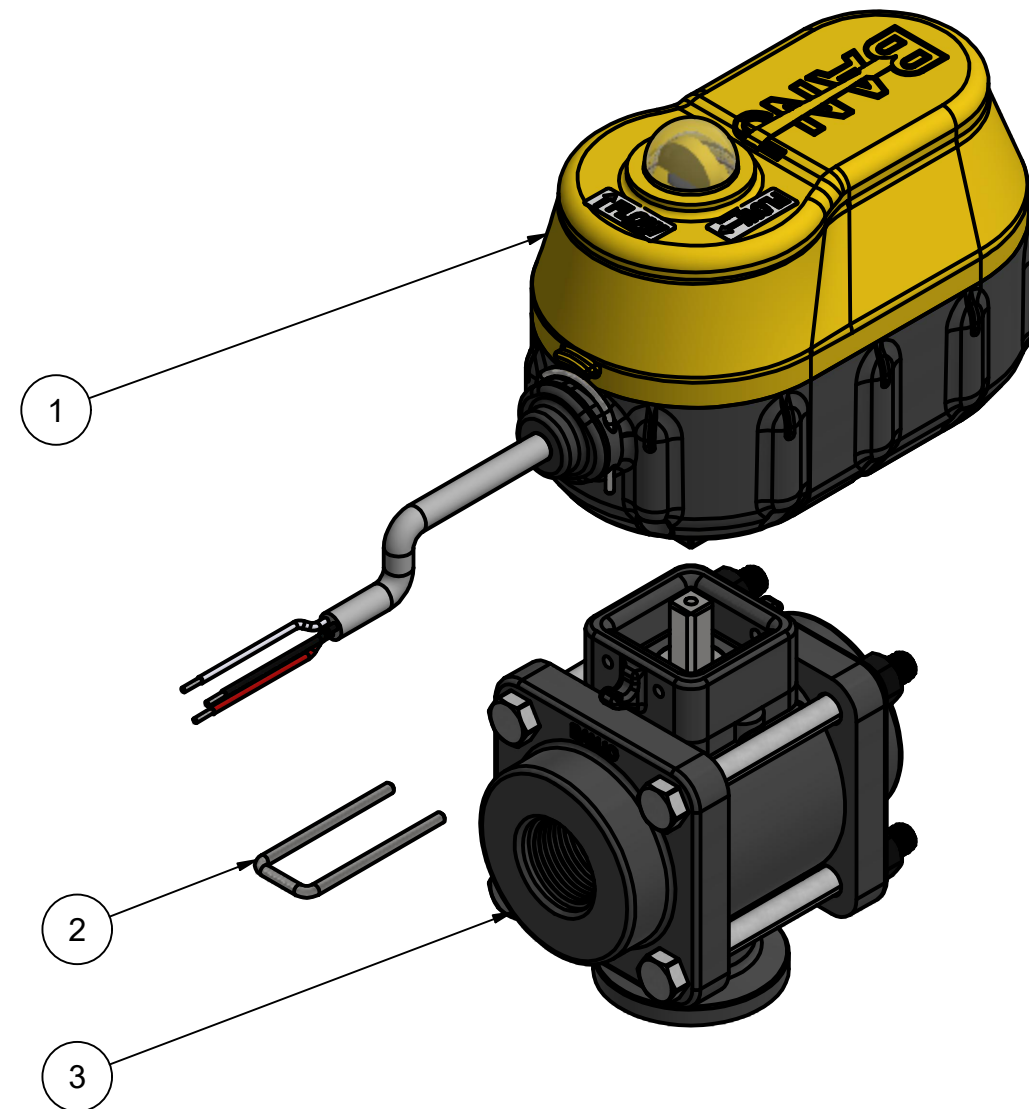
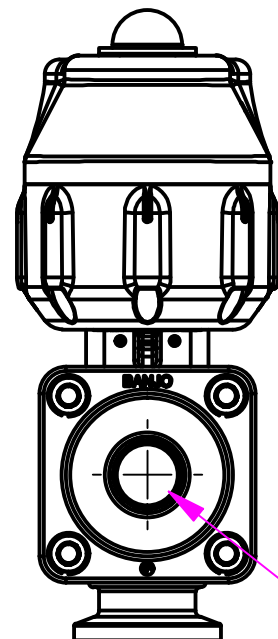
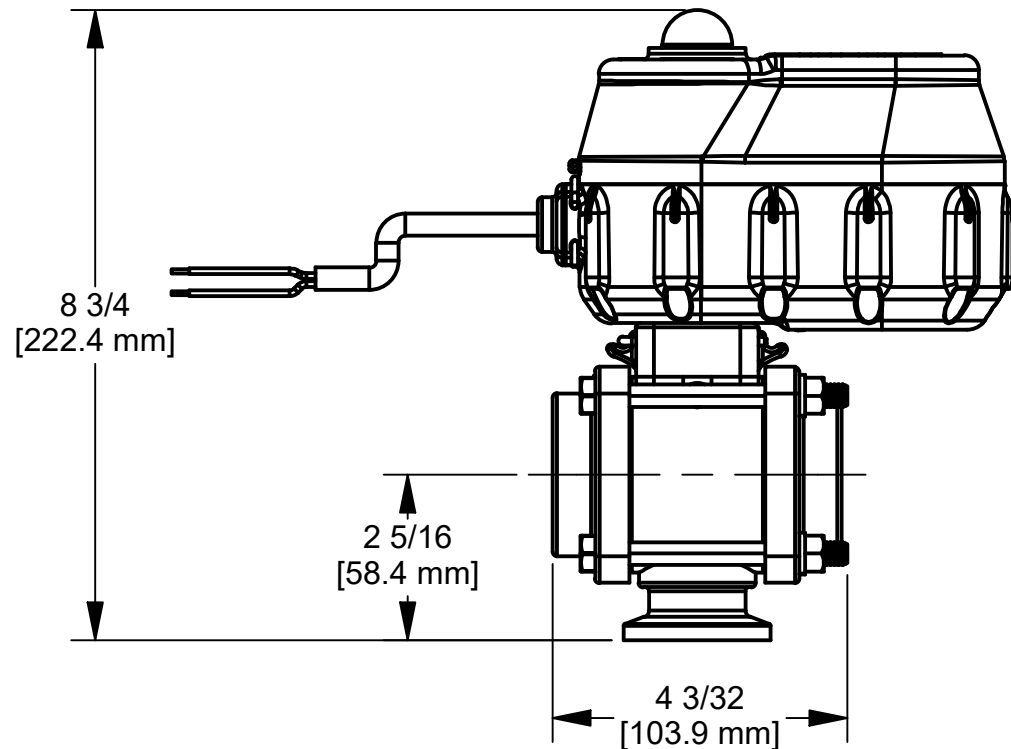
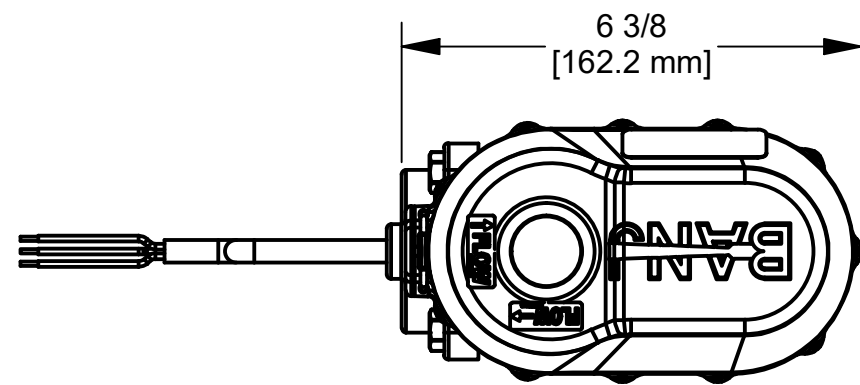

4

3

2

1



BANJO CORPORATION
 150 BANJO DRIVE, CRAWFORDSVILLE, IN 47933
 WEB SITE: WWW.BANJOCORP.COM
 E-MAIL: BANJOSALES@IDEXCORP.COM

DESCRIPTION
 EVX 0.75"PORT BL 3/4SEC 3W

PART NUMBER
 EVX075BL

THIS DRAWING AND ALL INFORMATION CONTAINED THEREON ARE THE EXCLUSIVE PROPERTY OF BANJO CORPORATION.
 UNLESS SPECIFICALLY NOTED, THIS DRAWING AND ITEMS SHOWN ON THIS DRAWING ARE SUBJECT TO CHANGE AT ANY TIME.