

4 1/8
[104.5 mm]

WIRING:
 RED = +12VDC
 BLACK = GND
 WHITE = +12VDC (OPEN), 0VDC (CLOSE)

WIRE LENGTH: 18" ± 1"

Parts List			
ITEM	QTY	PART NUMBER	DESCRIPTION
1	1	EP21A10310	EVX ACT 0.75S WWC 3W
2	1	EVP20001	EV U-PIN
3	1	EVX125SLX	EVX 1.25" NPT SL VALVE ONLY

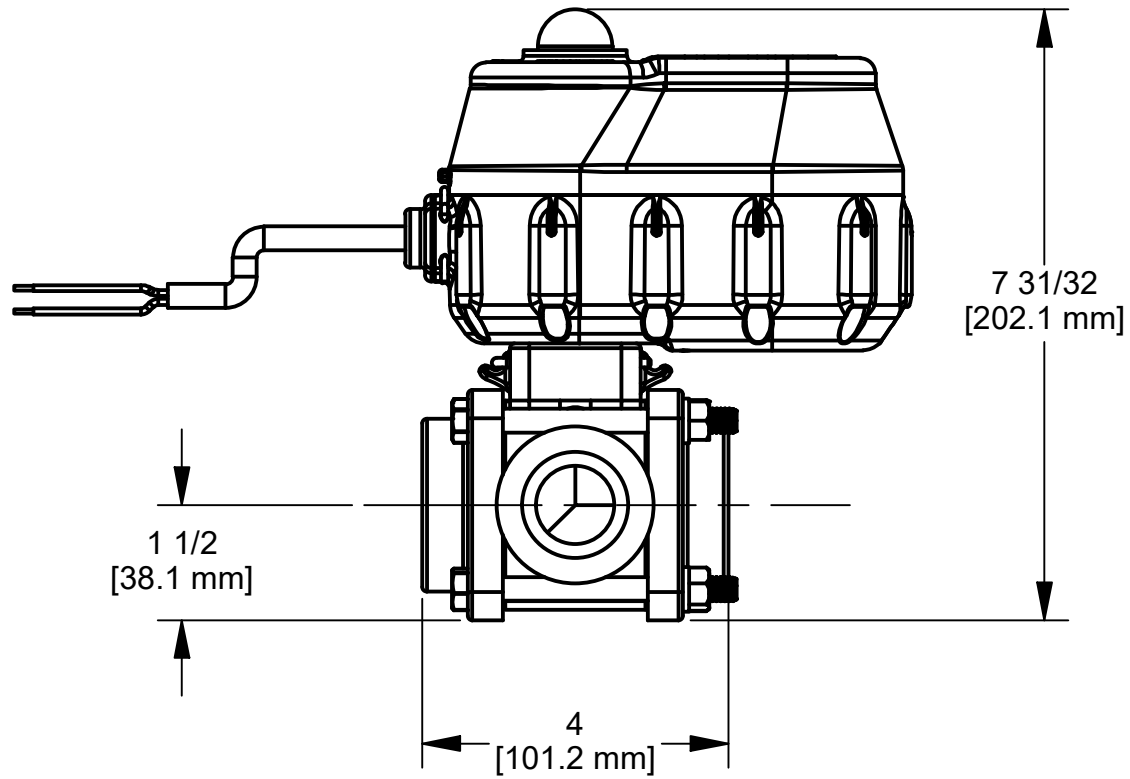

7 31/32
[202.1 mm]

1 1/2
[38.1 mm]

4
[101.2 mm]

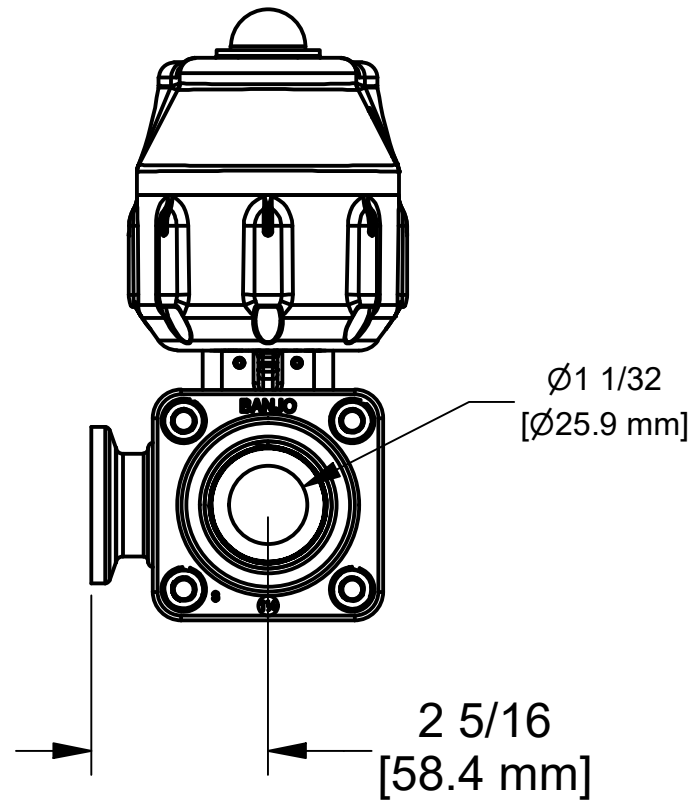

Ø1 1/32
[Ø25.9 mm]

2 5/16
[58.4 mm]

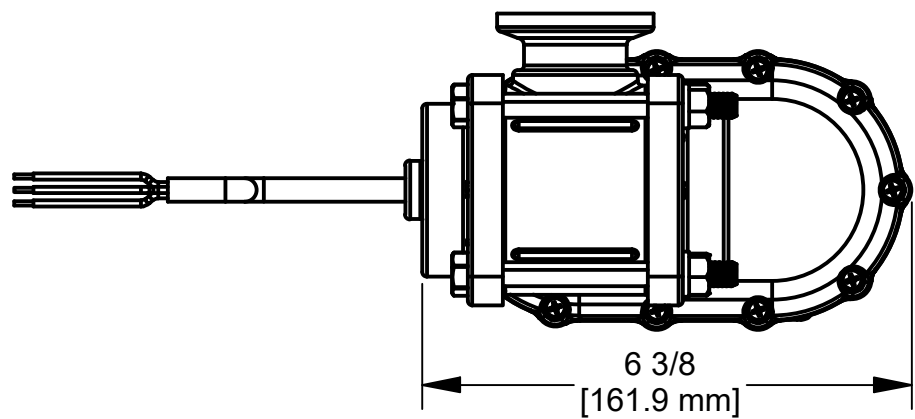
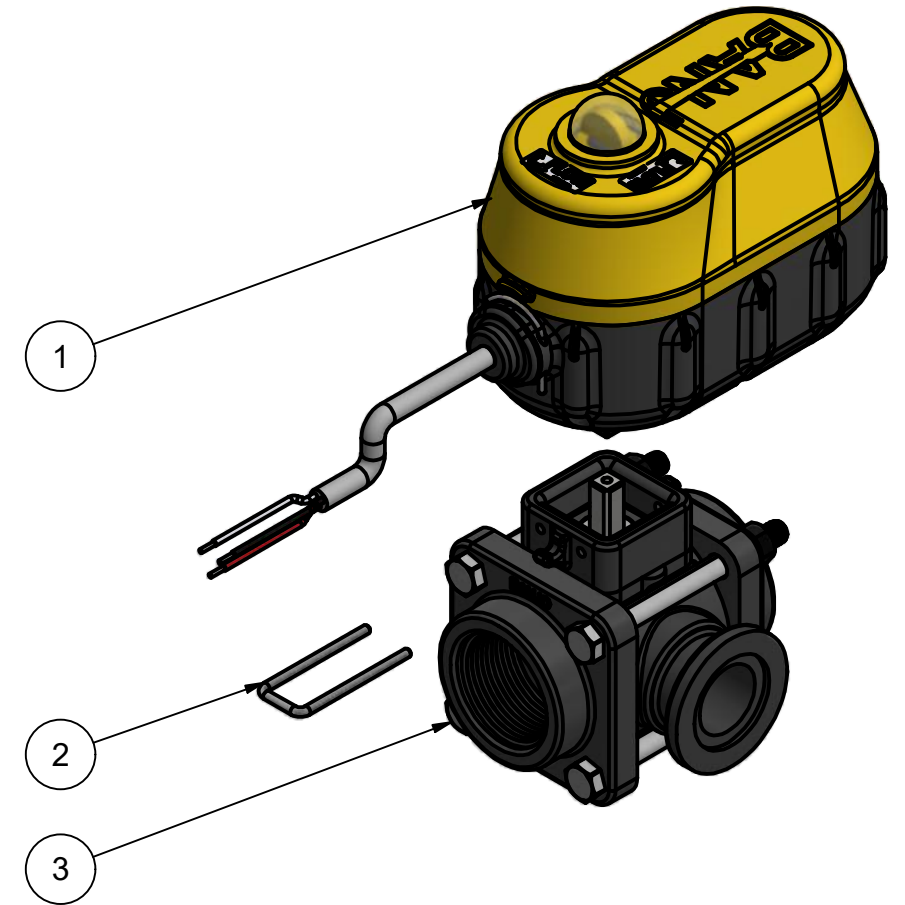

6 3/8
[161.9 mm]

THIS DRAWING AND ALL INFORMATION CONTAINED THEREON ARE THE EXCLUSIVE PROPERTY OF BANJO CORPORATION.

UNLESS SPECIFICALLY NOTED, THIS DRAWING AND ITEMS SHOWN ON THIS DRAWING ARE SUBJECT TO CHANGE AT ANY TIME.



BANJO CORPORATION
 150 BANJO DRIVE, CRAWFORDSVILLE, IN 47933
 WEB SITE: WWW.BANJOCORP.COM
 E-MAIL: BANJOSALES@IDEXCORP.COM

DESCRIPTION
 EVX 1.25"NPT SL 0.75S WWC 3W

PART NUMBER
 EVX125SL