

WIRING:
 PIN A: RED = +12VDC
 PIN B: BLACK = GND
 PIN C: WHITE = +12VDC (OPEN), 0VDC (CLOSE)

WIRE LENGTH: 8" ± 1"

PARTS LIST			
ITEM	QTY	PART NUMBER	DESCRIPTION
1	1	EP31B10310H	EVX ACT 1.5S WWC 3W, 8" CABLE
2	1	EVP20001	EV U-PIN
3	1	EVX201X	EVX 2" NPT SP 2 WAY BOLTED VALVE ONLY
4	3	VE001	CABLE SEAL
5	3	VE002	MALE TERMINAL
6	1	VE003	3 Conductor Female Shroud

*TO PURCHASE ACTUATOR ONLY WITH CONNECTOR:
 PART NUMBER IS: **EP31B10310HC3**

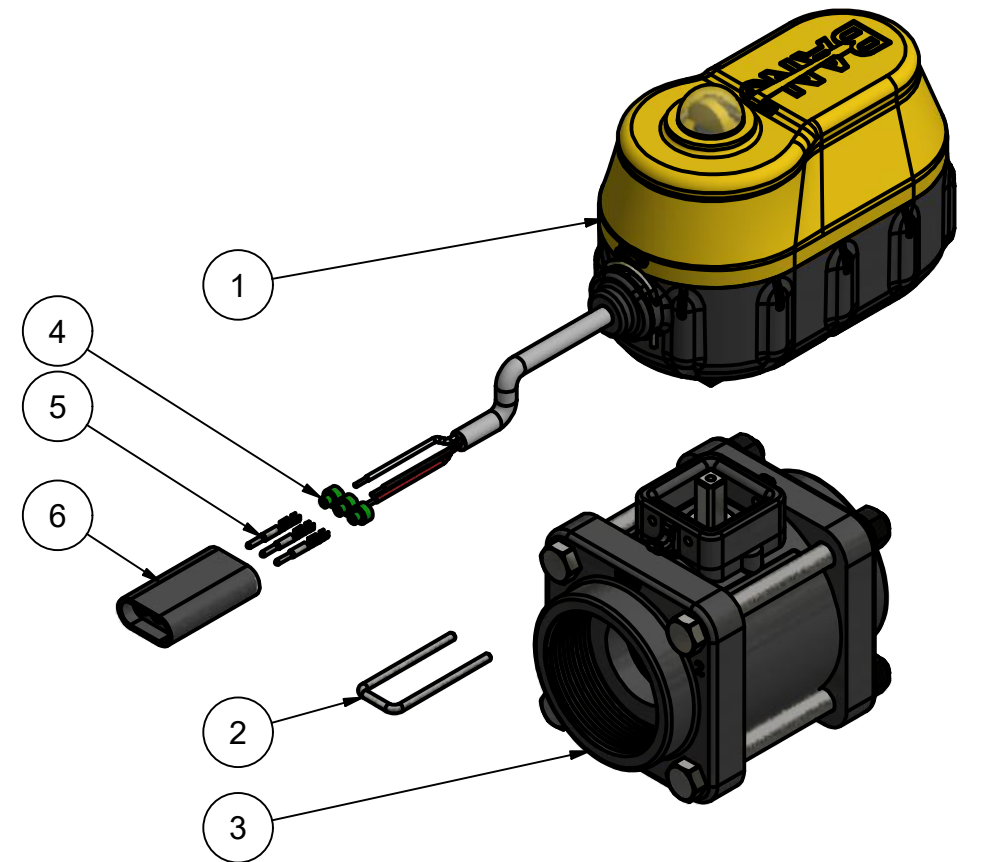
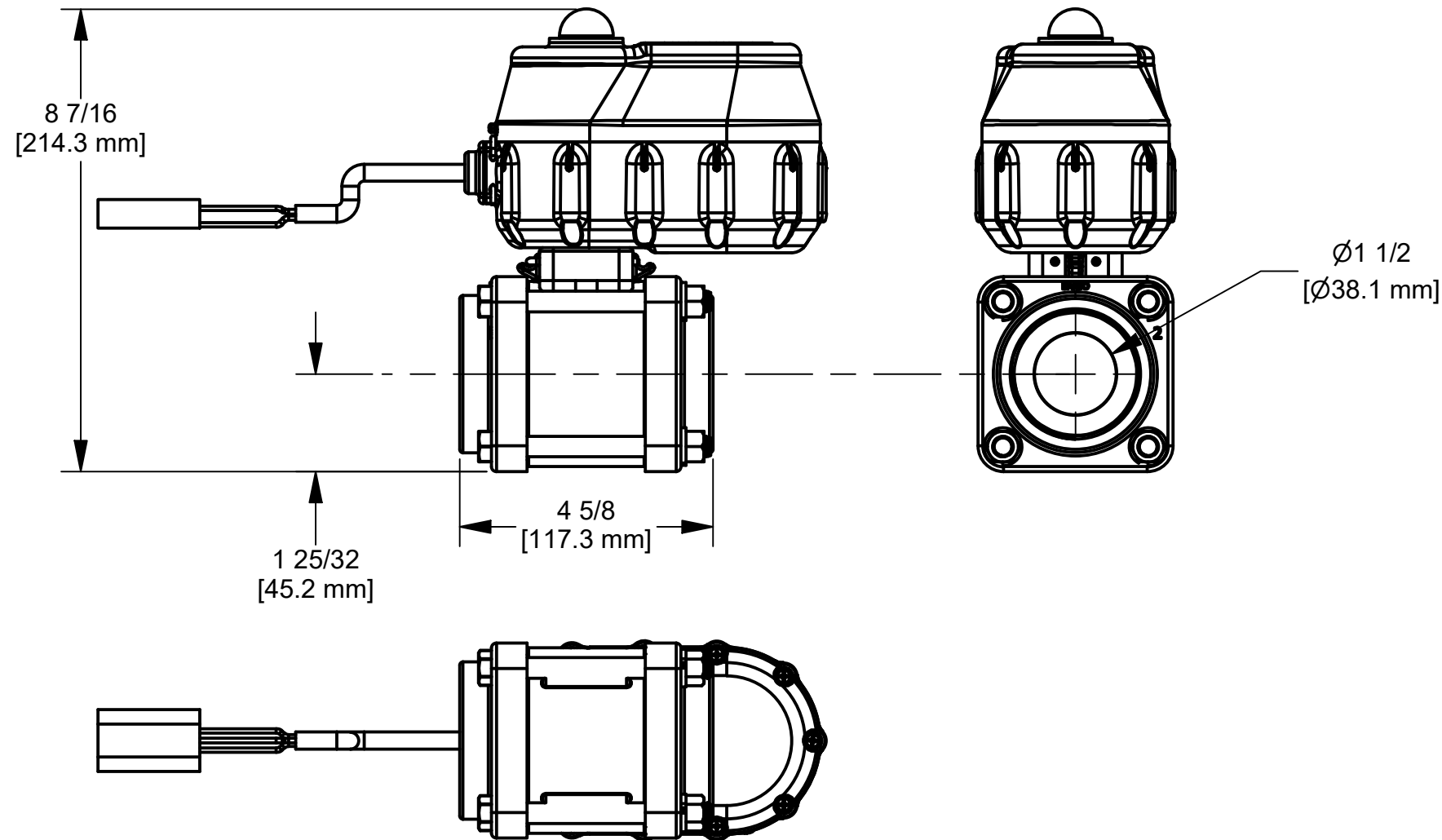

THIS DRAWING AND ALL INFORMATION CONTAINED THEREON ARE THE EXCLUSIVE PROPERTY OF BANJO CORPORATION.

UNLESS SPECIFICALLY NOTED, THIS DRAWING AND ITEMS SHOWN ON THIS DRAWING ARE SUBJECT TO CHANGE AT ANY TIME.

BANJO CORPORATION

BANJO CORPORATION
 150 BANJO DRIVE, CRAWFORDSVILLE, IN 47933
 WEB SITE: WWW.BANJOCORP.COM
 E-MAIL: BANJOSALES@IDEXCORP.COM

DESCRIPTION
 EVX 2" NPT SP BOLTED 1.5S ARBBCW

PART NUMBER
 EVX201A