

5 1/4
[133.2 mm]

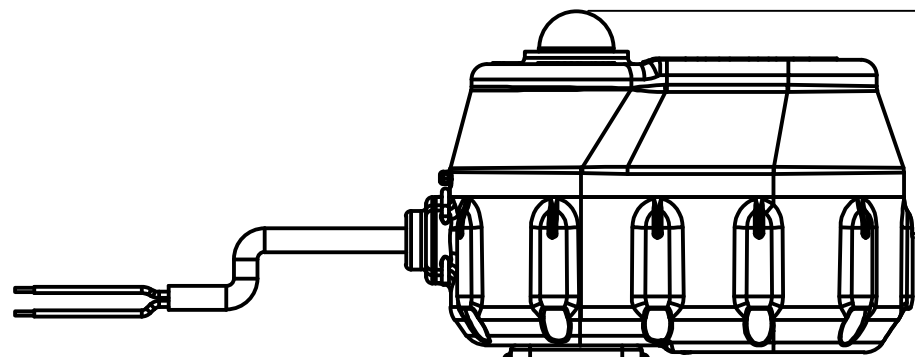

9 5/32
[232.6 mm]

2 1/8
[54.0 mm]

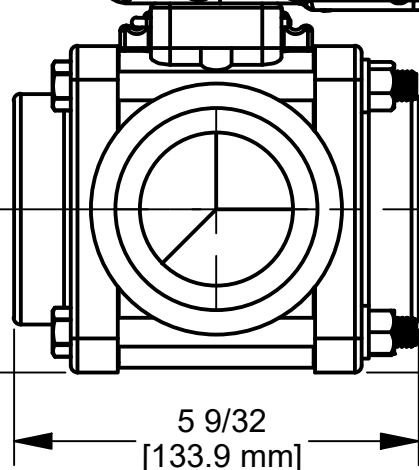

5 9/32
[133.9 mm]

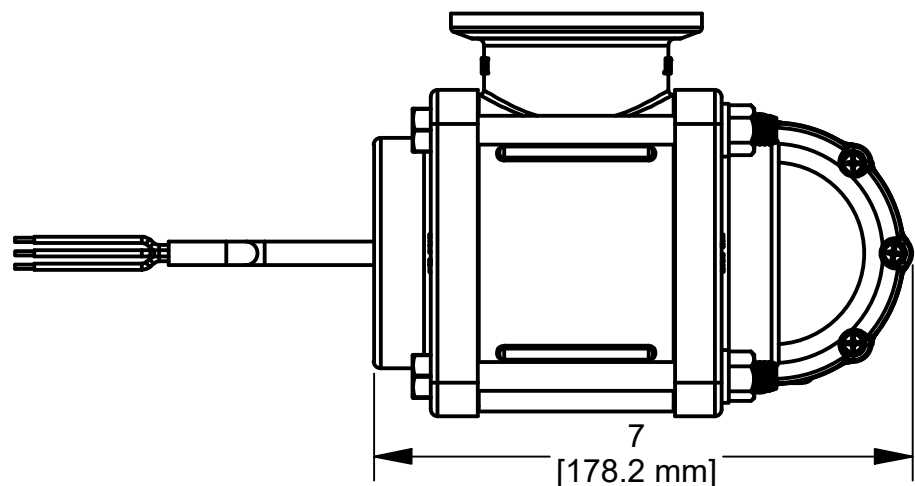

7
[178.2 mm]

WIRING:
RED = +12VDC
BLACK = GND
WHITE = +12VDC (OPEN), 0VDC (CLOSE)

WIRE LENGTH: 18" ± 1"

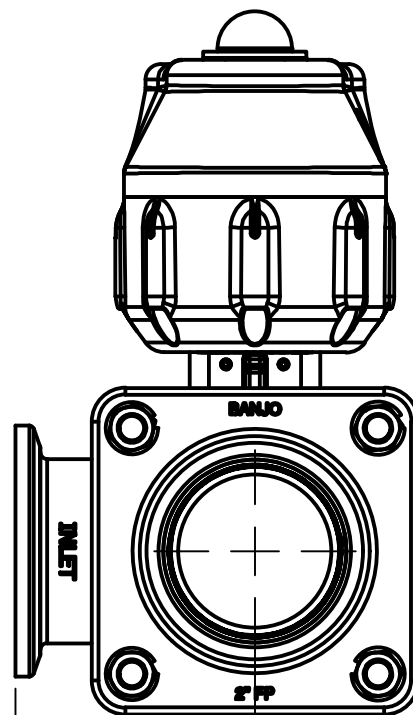

3 1/8
[79.2 mm]

Parts List			
ITEM	QTY	PART NUMBER	DESCRIPTION
1	1	EP31B10310	EVX ACT 1.5S WWC 3W
2	1	EVP20001	EV U-PIN
3	1	EVX220SLX	EVX 2" NPT FP SL VALVE ONLY

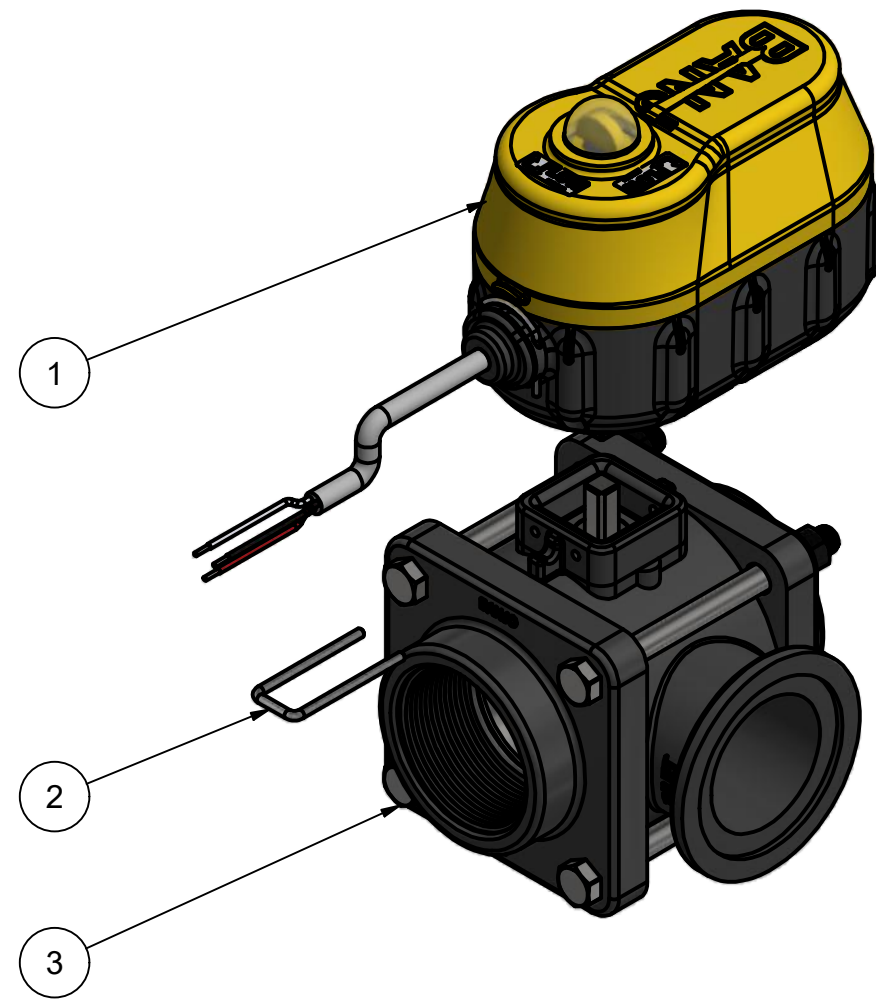

THIS DRAWING AND ALL INFORMATION CONTAINED THEREON ARE THE EXCLUSIVE PROPERTY OF BANJO CORPORATION.

UNLESS SPECIFICALLY NOTED, THIS DRAWING AND ITEMS SHOWN ON THIS DRAWING ARE SUBJECT TO CHANGE AT ANY TIME.



BANJO CORPORATION
150 BANJO DRIVE, CRAWFORDSVILLE, IN 47933
WEB SITE: WWW.BANJOCORP.COM
E-MAIL: BANJOSALES@IDEXCORP.COM

DESCRIPTION
EVX 2"NPT FP SL 0.75S WWC 3W

PART NUMBER
EVX220SL