

Parts List			
ITEM	QTY	PART NUMBER	DESCRIPTION
1	1	150(200)D	CAM LEVER COUPLING DECAL
2	1	200G	2" Coupling Gasket
3	2	200KL	2" Locking Cam Arm
4	2	200PKL	CAM ARM PIN
5	1	200XMD	2" FML CPLG X 2" NPT

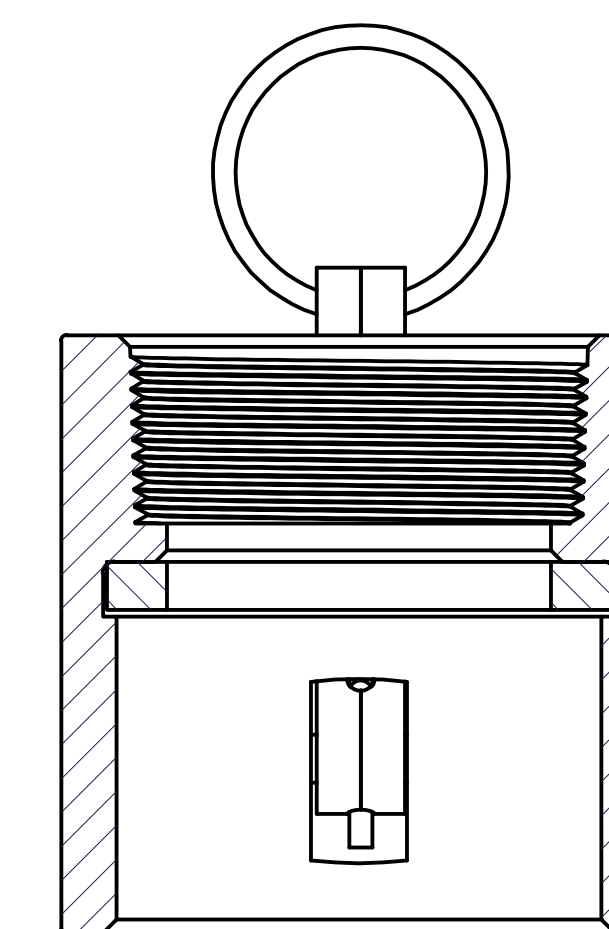

SECTION D-D  
SCALE 1 : 1

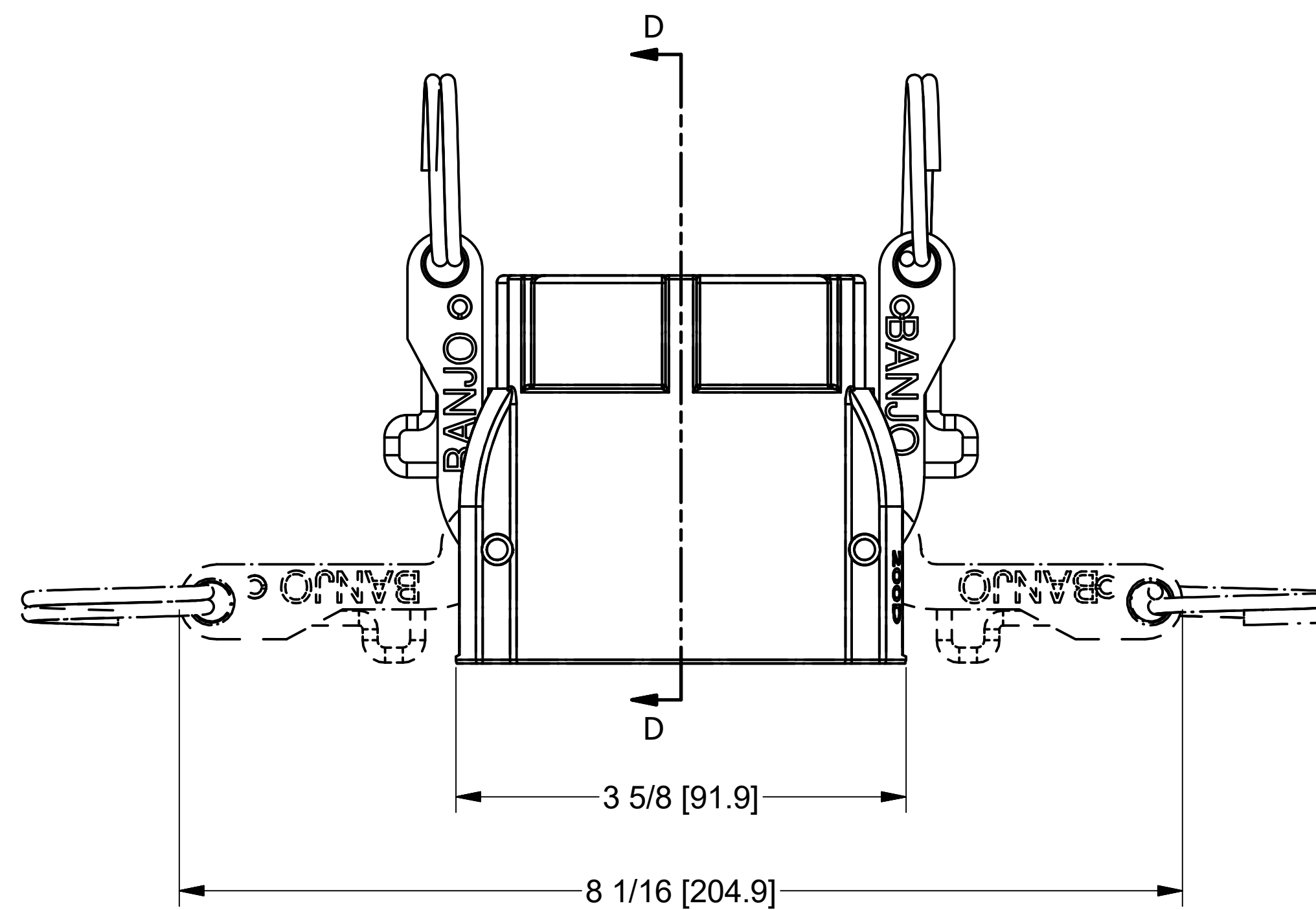
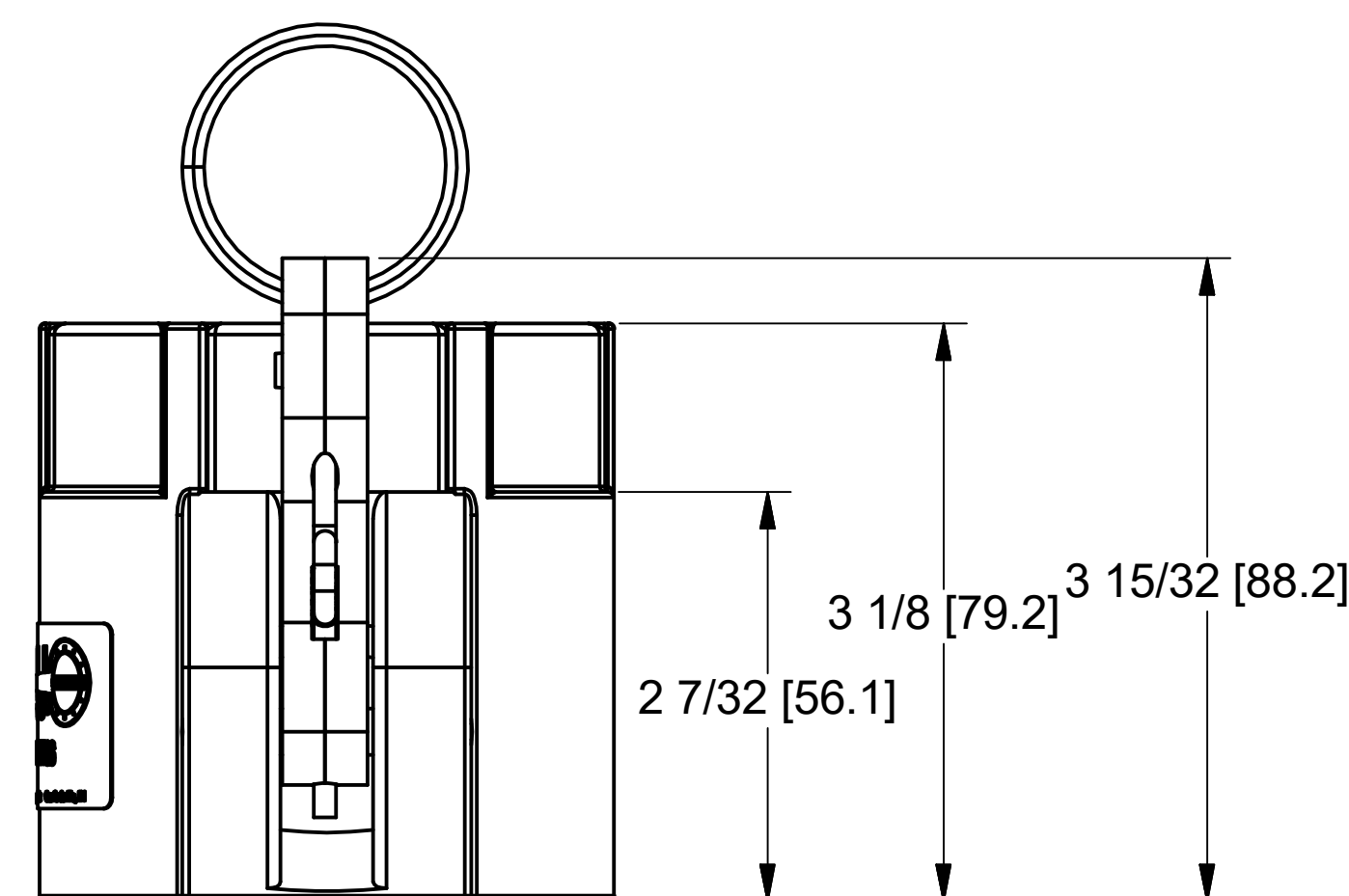
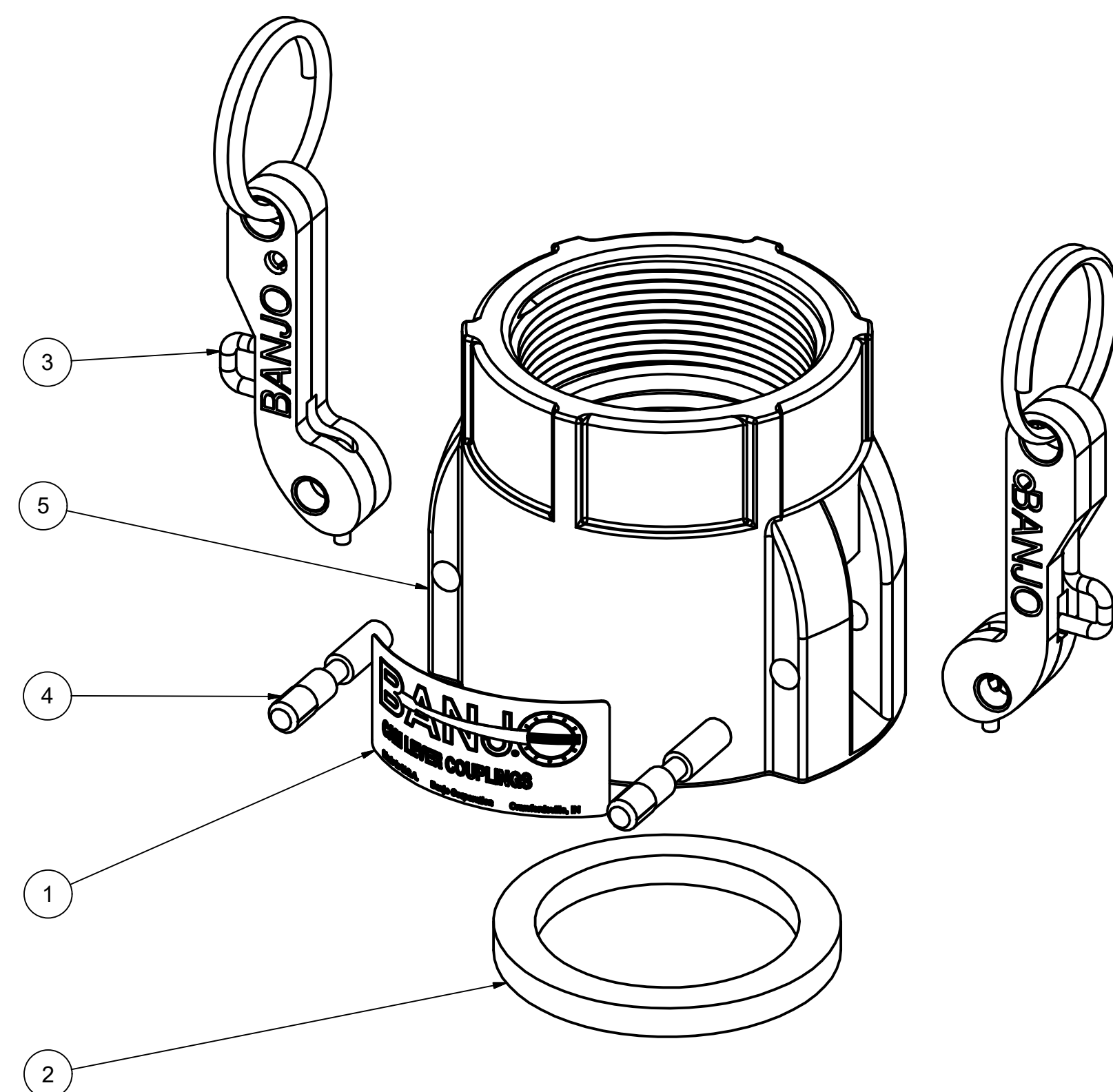

THIS DRAWING AND ALL INFORMATION CONTAINED THEREON ARE THE EXCLUSIVE PROPERTY OF BANJO CORPORATION.

UNLESS SPECIFICALLY NOTED, THIS DRAWING AND ITEMS SHOWN ON THIS DRAWING ARE SUBJECT TO CHANGE AT ANY TIME.



**BANJO CORPORATION**  
150 BANJO DRIVE, CRAWFORDSVILLE, IN 47933  
WEB SITE: WWW.BANJOCORP.COM  
E-MAIL: SALES1@BANJOCORP.COM

DESCRIPTION  
2" Female Coupling X 2" Female NPT W/  
Locking Cam Arms

PART NUMBER  
L200D