

7 15/16
[201.9 mm]

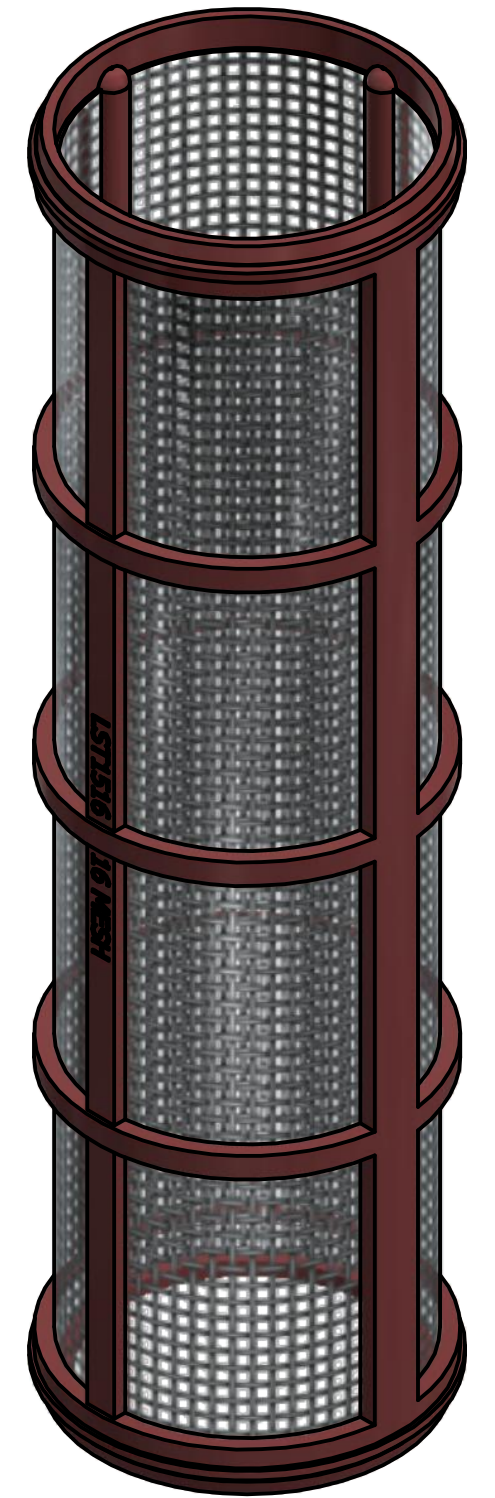
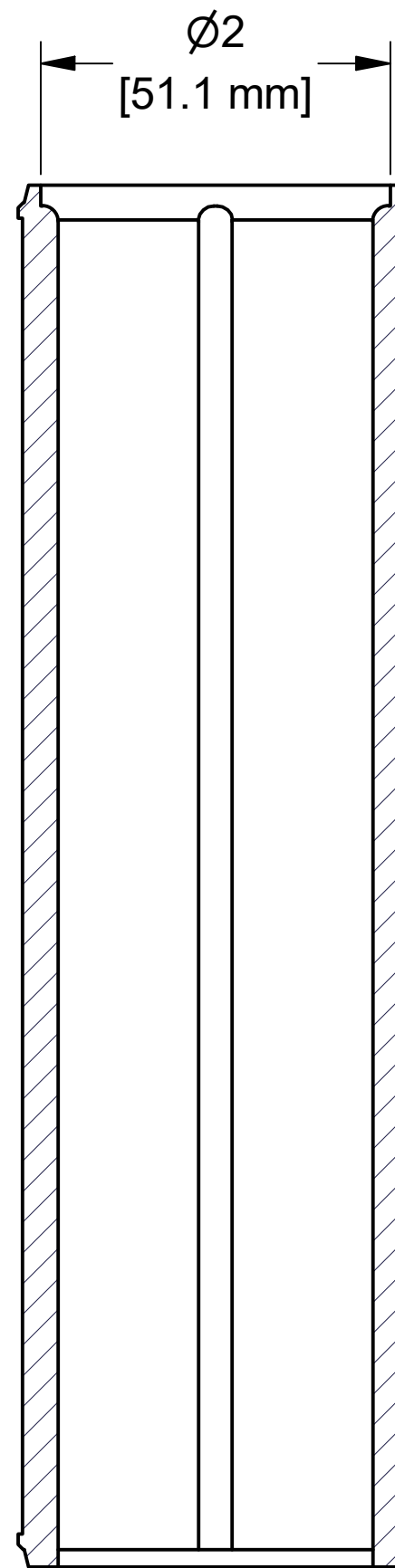
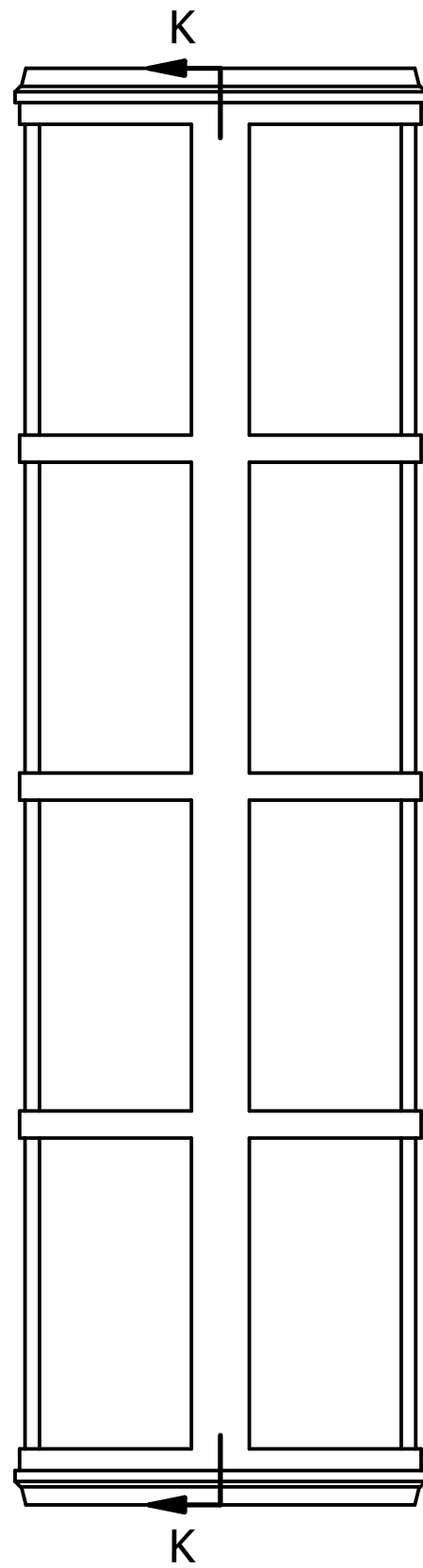

NOTE:

MATL: POLY RIBBED W/ 316SS SCREEN
"P" SERIES ALL PP SCREEN

PART NO.	MICRON	WIRE Ø	OPENING	RIB COLOR
LST1516	1190	.018	.044	BROWN RED (RAL #3011)
LST1530	595	.012	.021	FLAME RED (RAL #3000)
LST1550	297	.009	.011	GENTIAN BLUE (RAL #5010)
LST1580	177	.0055	.007	ZINC YELLOW (RAL #1018)
LST15100	149	.0045	.005	TRAFFIC GREEN (RAL #6024)



THIS DRAWING AND ALL INFORMATION CONTAINED THEREON ARE THE EXCLUSIVE PROPERTY OF BANJO CORPORATION.

UNLESS SPECIFICALLY NOTED, THIS DRAWING AND ITEMS SHOWN ON THIS DRAWING ARE SUBJECT TO CHANGE AT ANY TIME.

BANJO CORPORATION 150 BANJO DRIVE, CRAWFORDSVILLE, IN 47933 WEB SITE: WWW.BANJOCORP.COM E-MAIL: BANJOSALES@IDEXCORP.COM	
DESCRIPTION	1 1/2" LST SCREEN
PART NUMBER	LST1516