

Parts List			
ITEM	QTY	PART NUMBER	DESCRIPTION
1	1	EV3300	3/4 Sec, 3 Wire, EV Actuator Assy
2	1	FC100	1" HI TORQUE CLAMP
3	1	MEV100BLXR1	1" BL Manifold Valve SubAssy
4	1	MVE004	MVE Mounting Breather
5	1	VE016	Deutsch Connector DT04-4P
6	1	VE017	Deutsch DT Wedgelock W4P
7	3	VE018	Deutsch Pin SZ 16-18 AWG
8	1	VE021	Deutsch Plug 114017
9	1	VEL1020	VE "BL" Sticker
10	1	VEL1021	VE "BL" Sticker

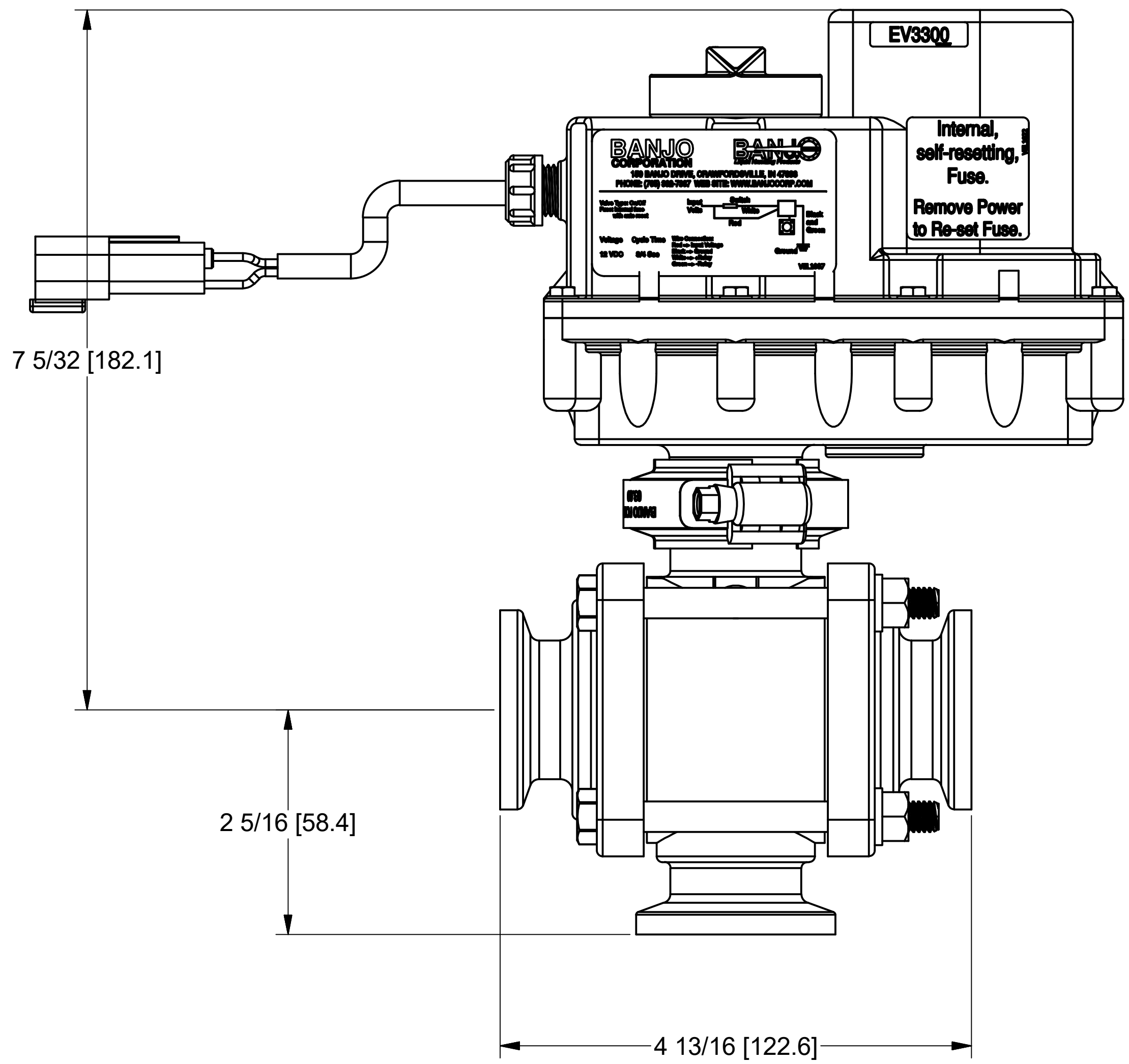
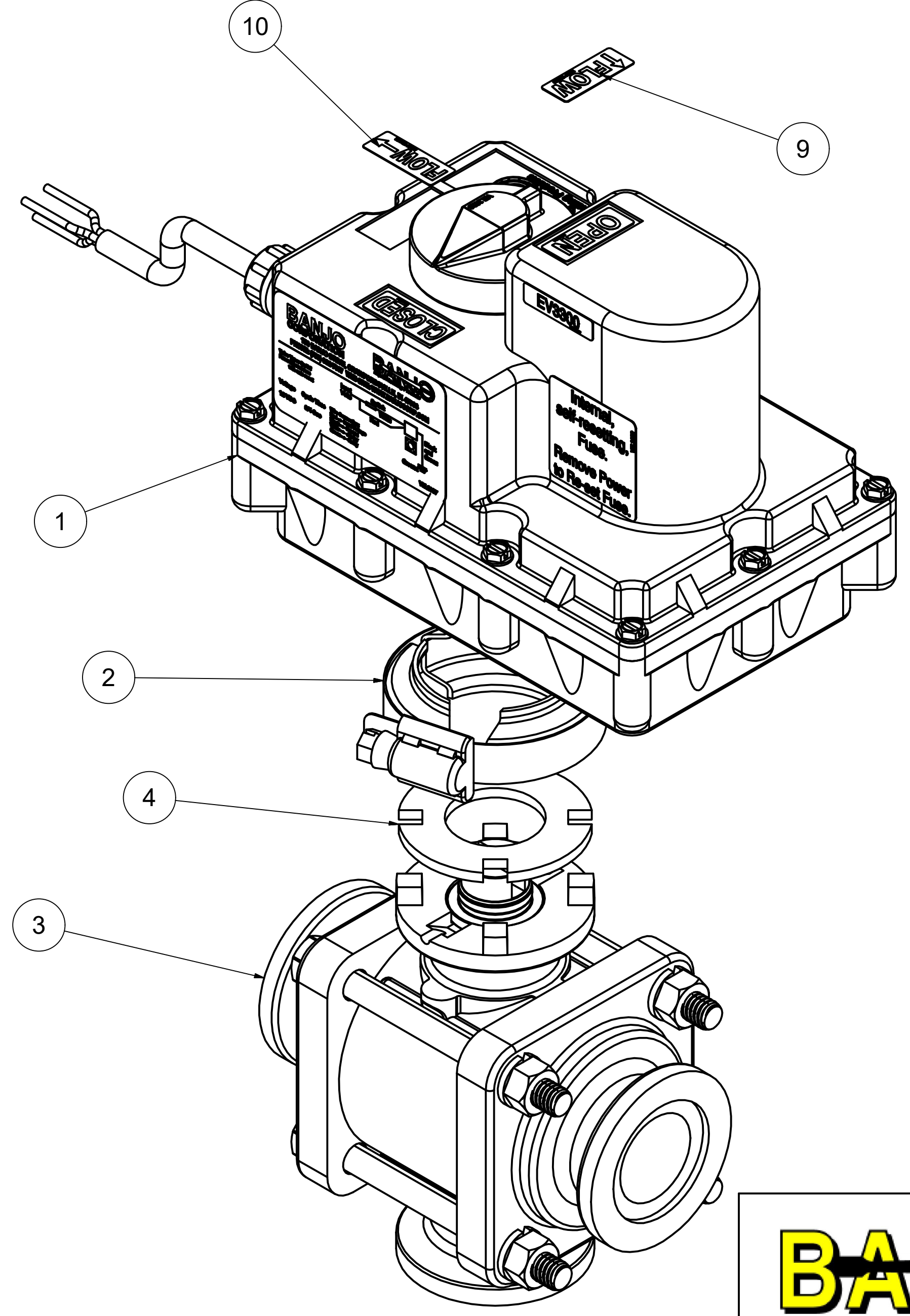
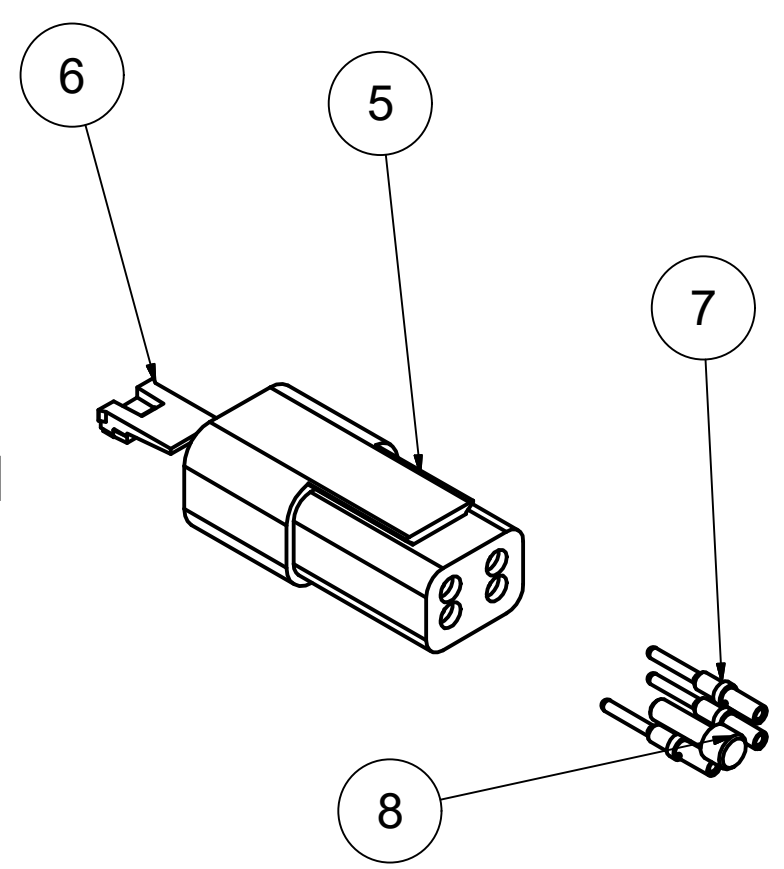
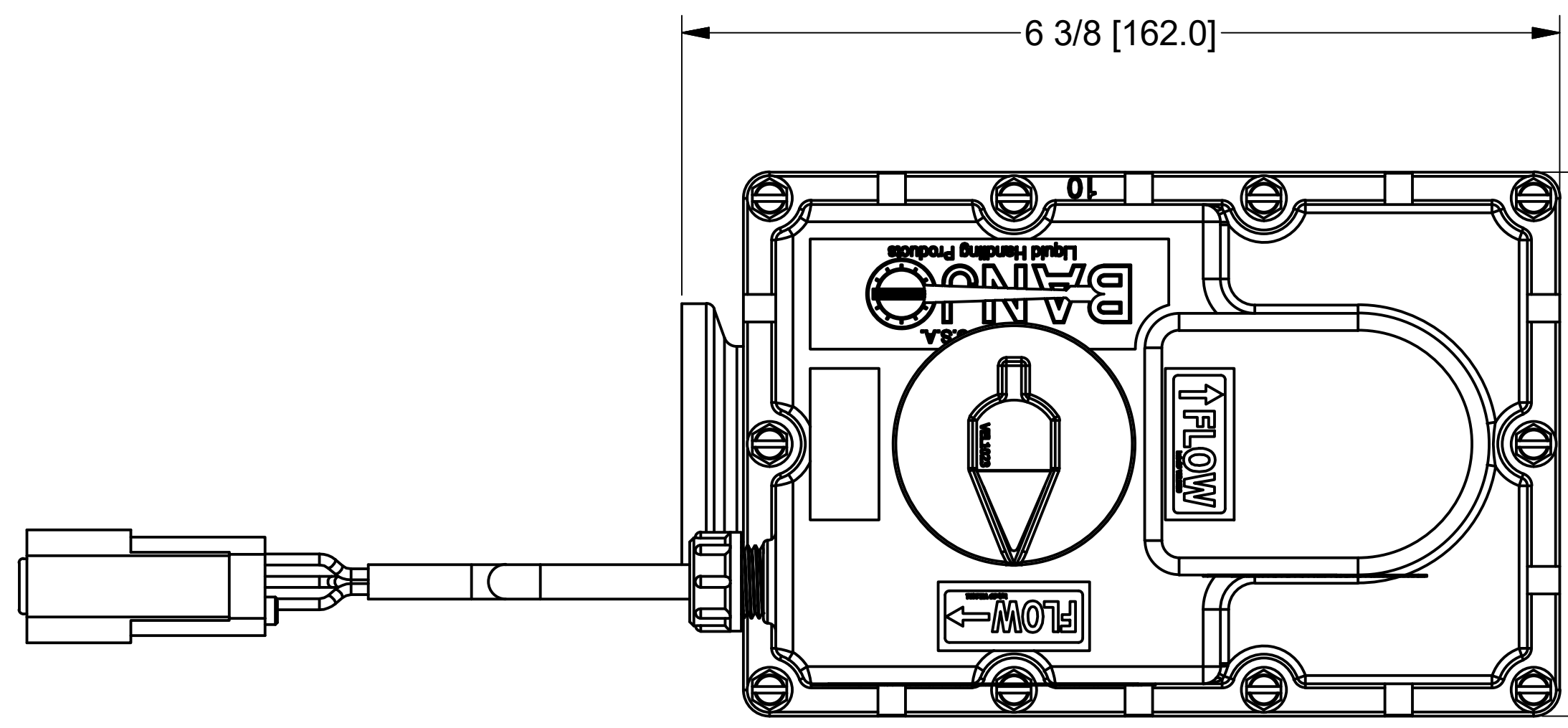

NOTE:
 WIRING, 3 WIRE
 PIN 1 = BLACK = GROUND
 PIN 2 = PLUG
 PIN 3 = WHITE = SIGNAL
 PIN 4 = RED = +12 VDC

THIS DRAWING AND ALL INFORMATION CONTAINED THEREON ARE THE EXCLUSIVE PROPERTY OF BANJO CORPORATION.
 UNLESS SPECIFICALLY NOTED, THIS DRAWING AND ITEMS SHOWN ON THIS DRAWING ARE SUBJECT TO CHANGE AT ANY TIME.

BANJO CORPORATION
 150 BANJO DRIVE, CRAWFORDSVILLE, IN 47933
 WEB SITE: WWW.BANJOCORP.COM
 E-MAIL: BANJOSALES@IDEXCORP.COM

DESCRIPTION
 1" BL Manifold Electric Valve 3/4 Sec, 3 Wire, On/Off

PART NUMBER
 MEV101BLCF