

4

3

2

1

NOTES:

CABLE LENGTH: 18" ±1" FROM HOUSING.

WIRING:

RED = +12VDC  
BLACK = GND  
WHITE = +12VDC (OPEN), 0VDC (CLOSE)

Parts List

ITEM	QTY	PART NUMBER	DESCRIPTION
1	1	EP21A10310	EVX ACT 0.75S WWC 3W
2	1	EVP20001	EV U-PIN
3	1	MEVX100HX	MEVX 1"FP STUBBY VALVE ONLY

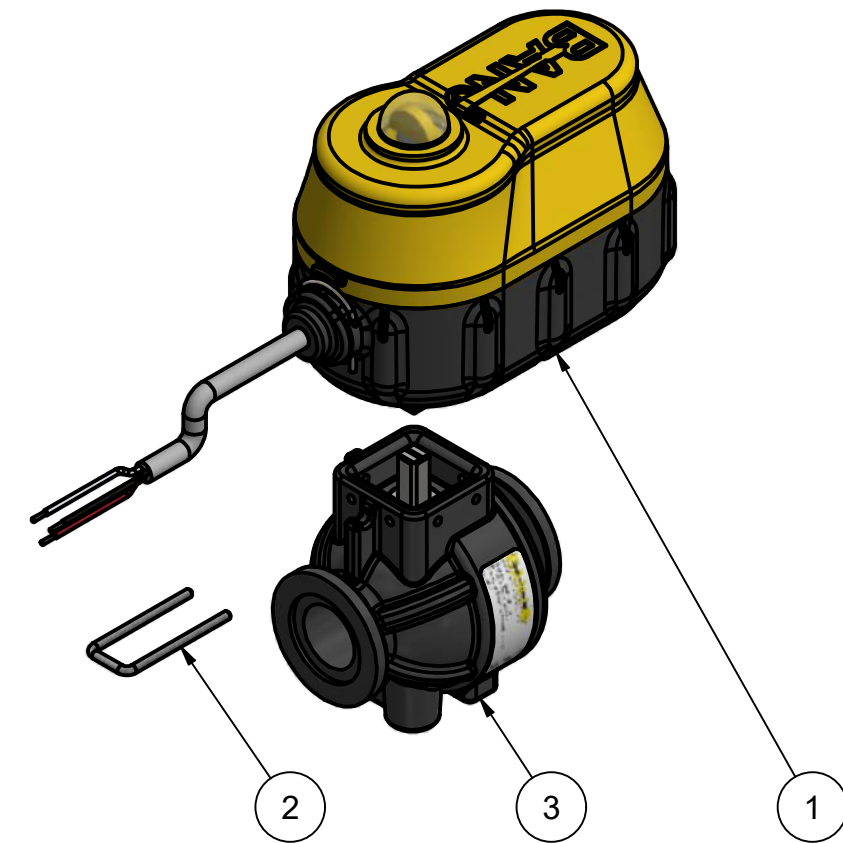
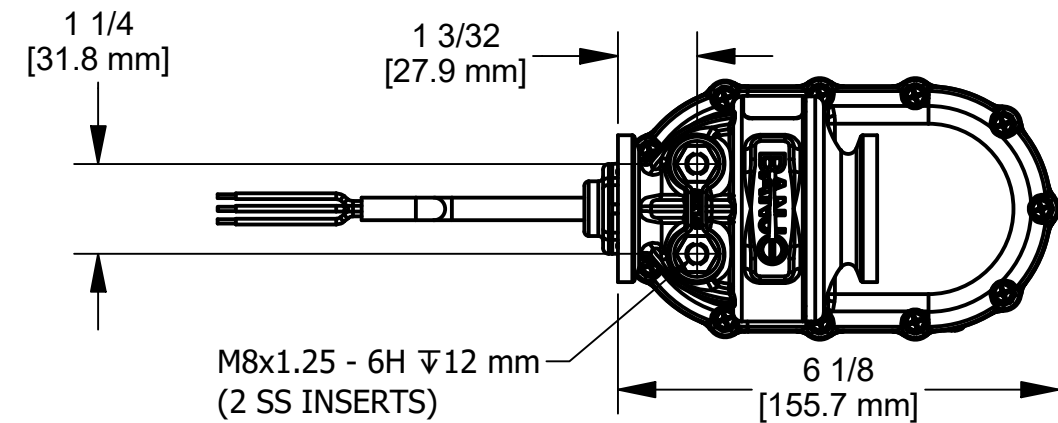
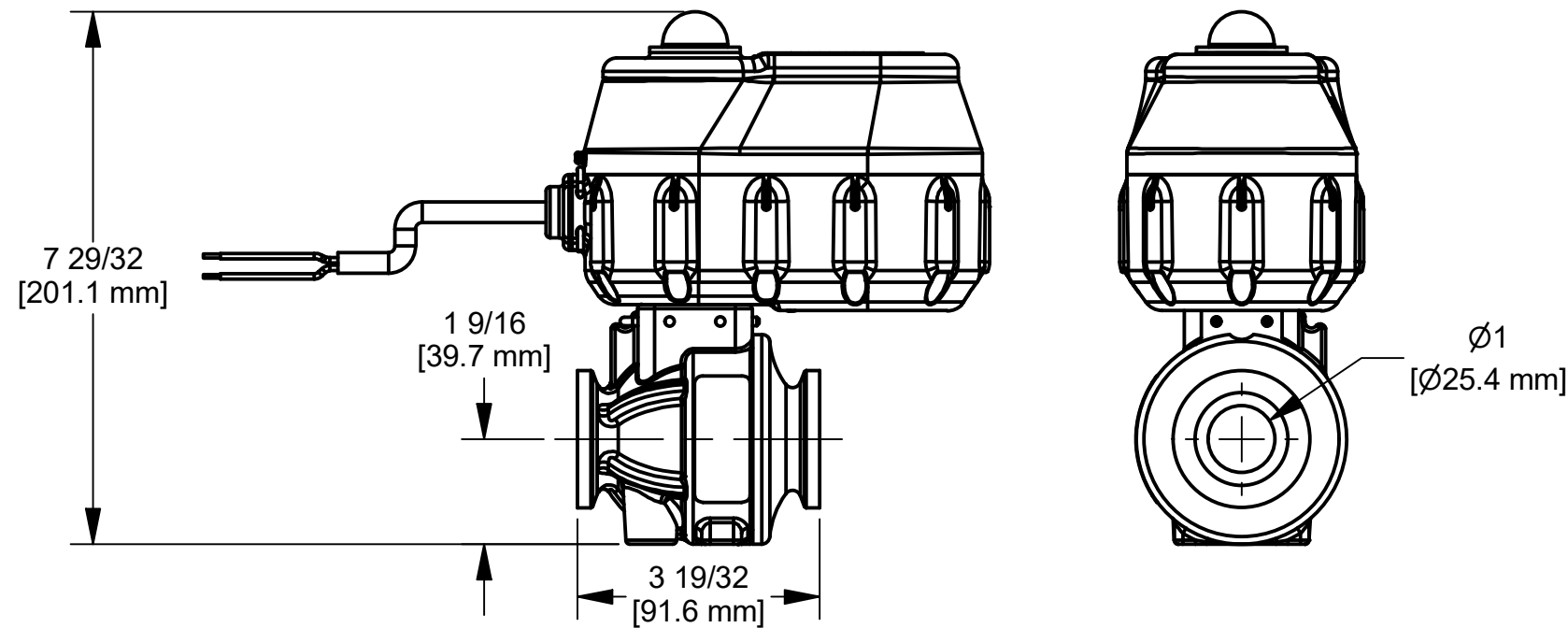
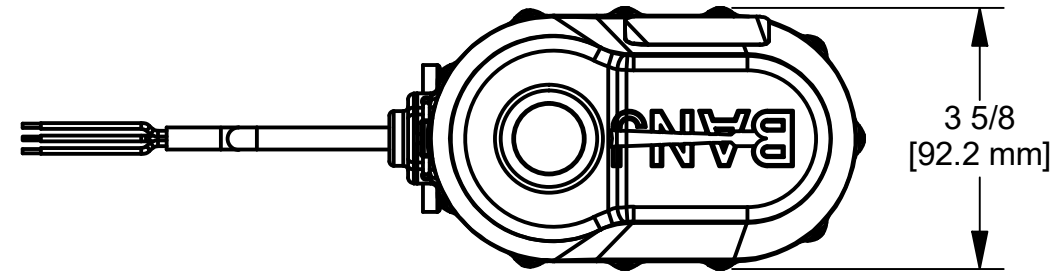

**BANJO CORPORATION**  
 150 BANJO DRIVE, CRAWFORDSVILLE, IN 47933  
 WEB SITE: WWW.BANJOCORP.COM  
 E-MAIL: BANJOSALES@IDEXCORP.COM

DESCRIPTION  
**MEVX 1"FP 0.75S WWC 3W**

PART NUMBER  
**MEVX100**

THIS DRAWING AND ALL INFORMATION CONTAINED THEREON ARE THE EXCLUSIVE PROPERTY OF BANJO CORPORATION.  
 UNLESS SPECIFICALLY NOTED, THIS DRAWING AND ITEMS SHOWN ON THIS DRAWING ARE SUBJECT TO CHANGE AT ANY TIME.

4

3

2

1