

NOTES:

WIRING:
 RED = +24VDC
 WHITE = +24VDC (OPEN), 0VDC (CLOSE)
 BLACK = GND

WIRE LENGTH: 18" ±1" FROM HOUSING.

| PARTS LIST | | | |
|------------|-----|-------------|-----------------------------|
| ITEM | QTY | PART NUMBER | DESCRIPTION |
| 2 | 1 | EVP20001 | EV U-PIN |
| 3 | 1 | MEVX100HX | MEVX 1"FP STUBBY VALVE ONLY |
| 1 | 1 | EP22A10320 | EVX ACT 0.75S WWC 3W 24V |

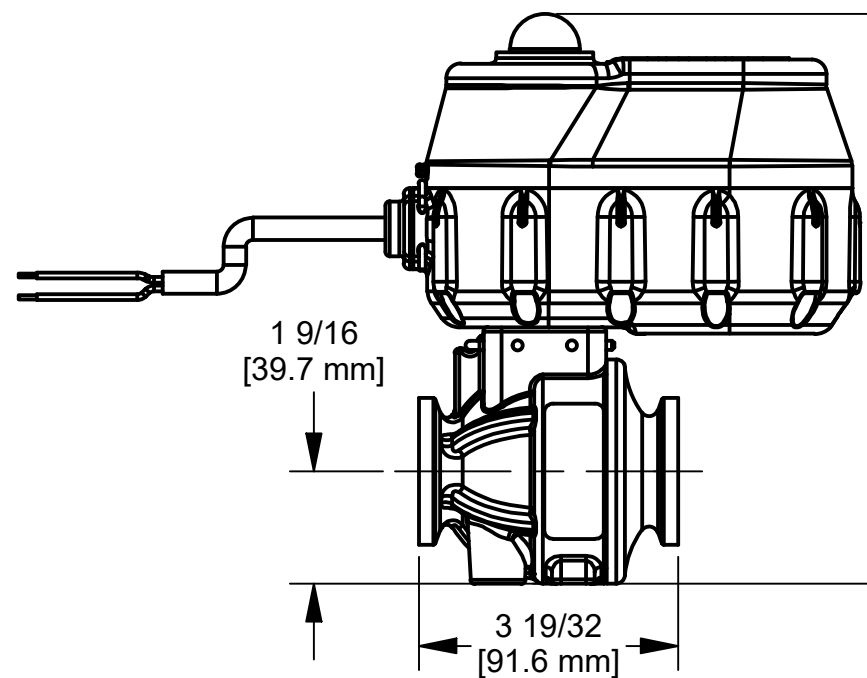

7 29/32
[201.1 mm]

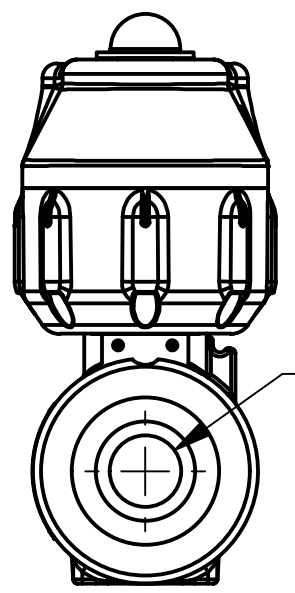

Ø1
[Ø25.4 mm]

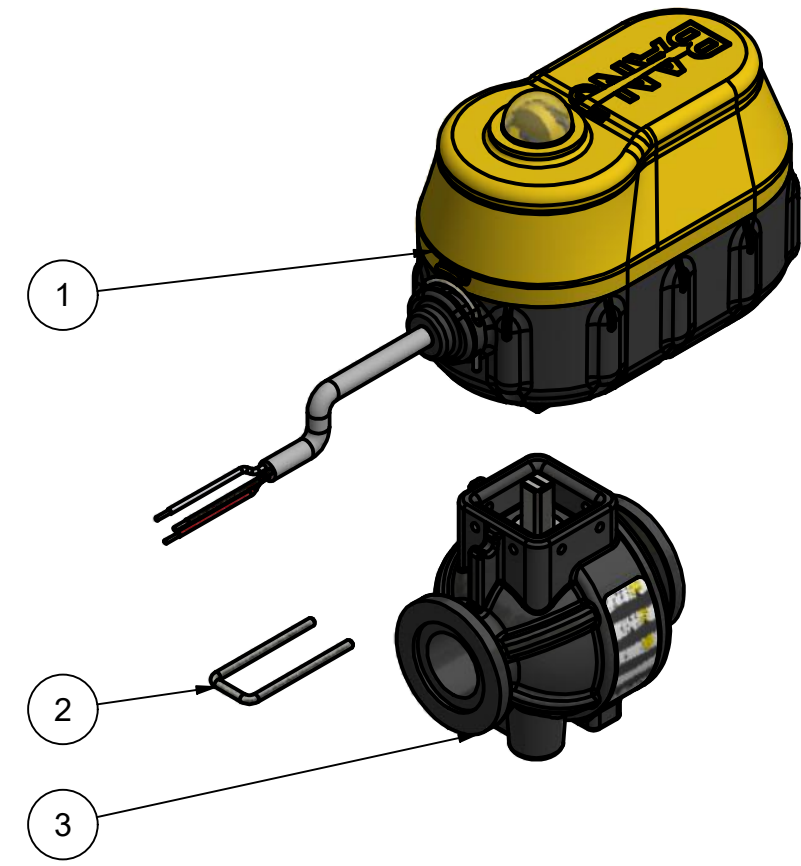
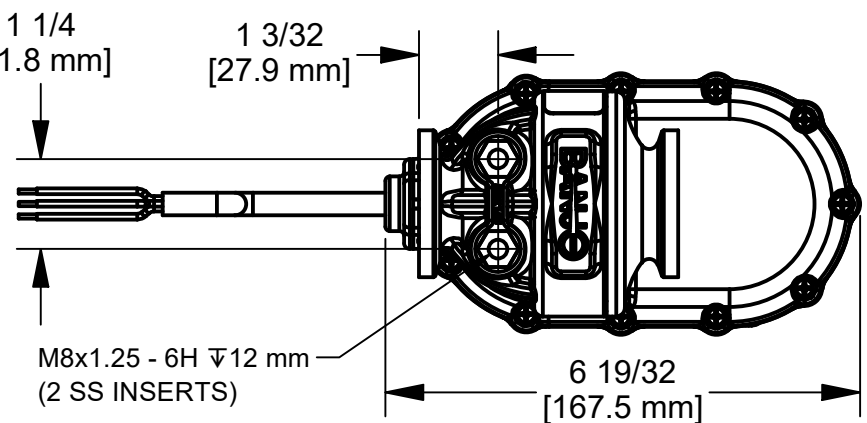

THIS DRAWING AND ALL INFORMATION CONTAINED THEREON ARE THE EXCLUSIVE PROPERTY OF BANJO CORPORATION.

UNLESS SPECIFICALLY NOTED, THIS DRAWING AND ITEMS SHOWN ON THIS DRAWING ARE SUBJECT TO CHANGE AT ANY TIME.

BANJO
CORPORATION

BANJO CORPORATION
 150 BANJO DRIVE, CRAWFORDSVILLE, IN 47933
 WEB SITE: WWW.BANJOCORP.COM
 E-MAIL: BANJOSALES@IDEXCORP.COM

DESCRIPTION
 MEVX 1"FP 0.75S WWC 3W 24V

PART NUMBER
 MEVX10024