

WIRING:
 PIN A: RED = +24VDC
 PIN B: BLACK = GND
 PIN C: WHITE = +24VDC (OPEN), 0VDC (CLOSE)

CONNECTOR: DT04-3P

WIRE LENGTH: 18" ±1" FROM HOUSING.

| PARTS LIST | | | |
|------------|-----|-------------|------------------------------------|
| ITEM | QTY | PART NUMBER | DESCRIPTION |
| 1 | 1 | EP22A10320 | EVX ACT 0.75S WWC 3W 24V |
| 2 | 1 | EVP20001 | EV U-PIN |
| 3 | 1 | MEVX100HX | MEVX 1"FP STUBBY VALVE ONLY |
| 4 | 3 | VE018 | Deutsch Pin SZ 16-18 AWG |
| 5 | 1 | VE019 | DEUTSCH IPD 3 WAY RECEPT DT SERIES |
| 6 | 1 | VE020 | Deutsch DT Wedglock W3P |

*TO PURCHASE ACTUATOR ONLY WITH CONNECTOR:
 PART NUMBER IS: **EP22A10320C10**

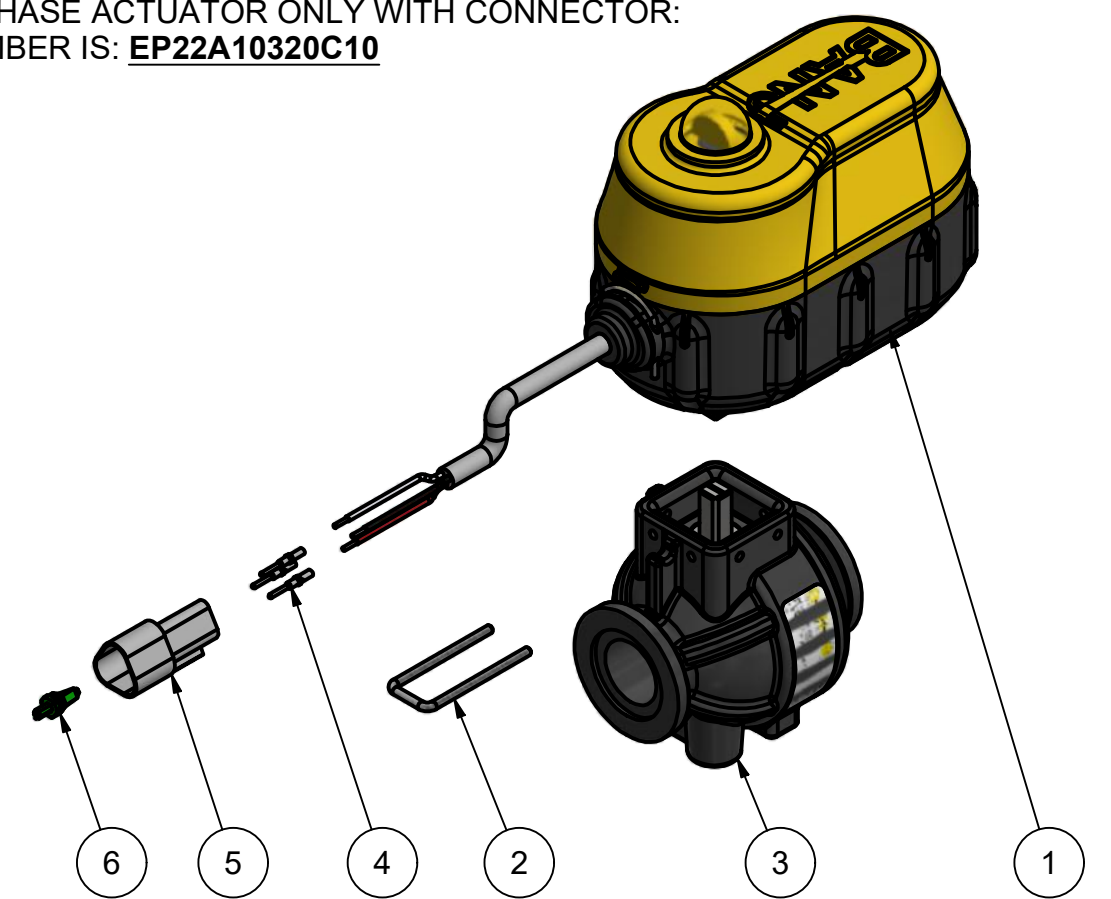
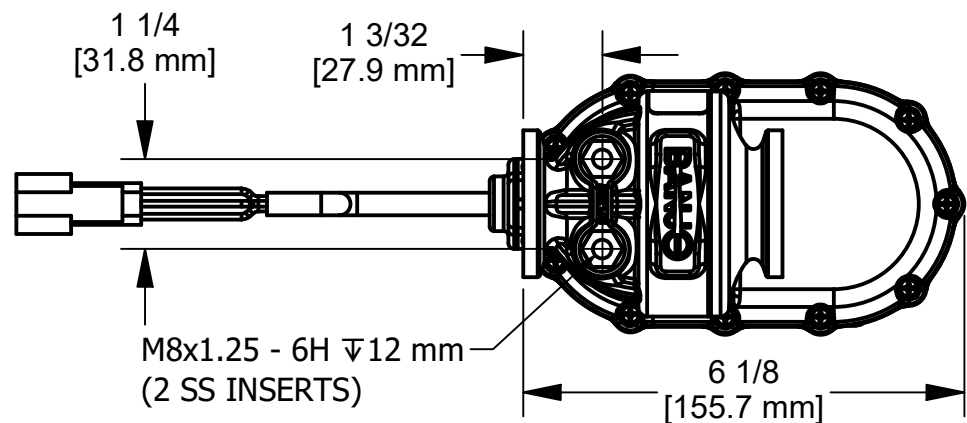
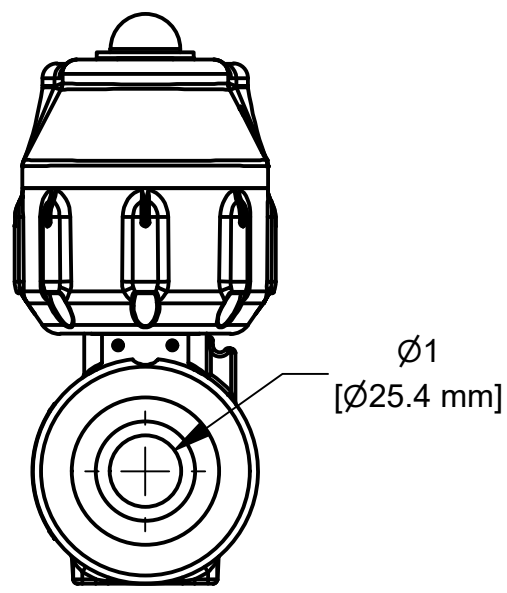
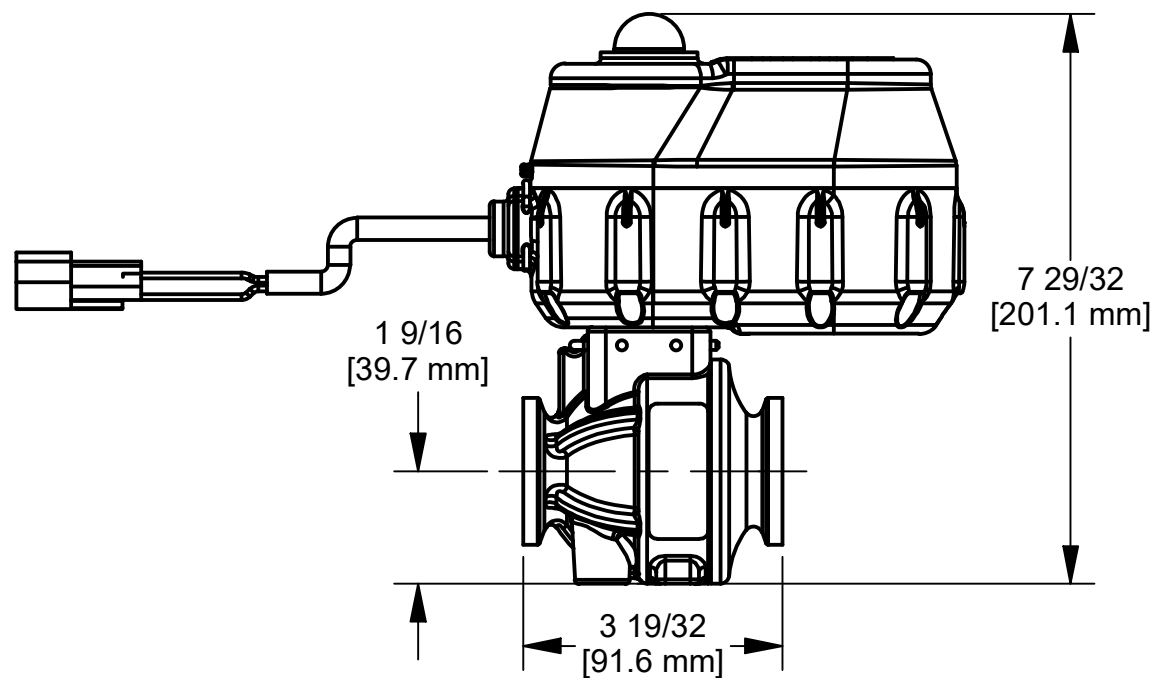

THIS DRAWING AND ALL INFORMATION CONTAINED THEREON ARE THE EXCLUSIVE PROPERTY OF BANJO CORPORATION.

UNLESS SPECIFICALLY NOTED, THIS DRAWING AND ITEMS SHOWN ON THIS DRAWING ARE SUBJECT TO CHANGE AT ANY TIME.

BANJO CORPORATION

150 BANJO DRIVE, CRAWFORDSVILLE, IN 47933
 WEB SITE: WWW.BANJOCORP.COM
 E-MAIL: BANJOSALES@IDEXCORP.COM

DESCRIPTION
MEVX 1"FP 0.75S WWC 24V ARBBCW

PART NUMBER
MEVX10024A