

WIRING:

PIN 1: BLACK = GND
 PIN 2: RED = +12VDC
 PIN 3: WHITE = +12VDC (OPEN @ PORT 1)
 0VDC (OPEN @ PORT 2)

FLOW LABELS TO BE ORIENTED AS SHOWN

Parts List			
ITEM	QTY	PART NUMBER	DESCRIPTION
1	1	EP21A10310	EVX ACT 0.75S WWC 3W
2	1	EVP20001	EV U-PIN
3	1	MEVX100BLX	1" EVX BL MANIFOLD VALVE
4	1	VE025	AMP 3 PIN TAB CONNECTOR 282105-1
5	3	VE026	AMP MINI MIC TAB 183024-1
6	3	VE027	AMP SINGLE WIRE SEAL 281934-2
7	1	VEL1020	VE "BL" Sticker
8	1	VEL1021	VE "BL" Sticker

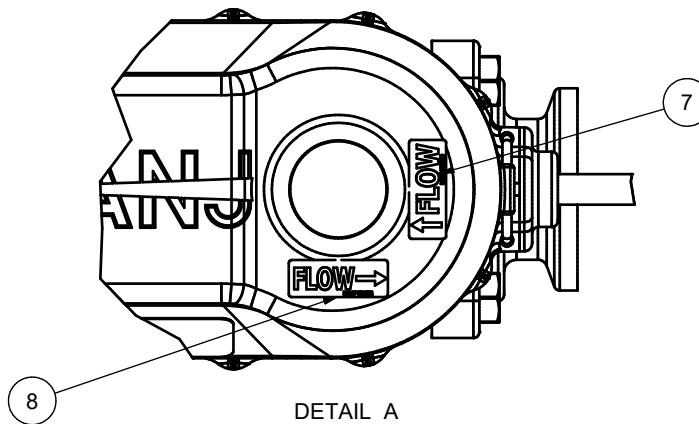
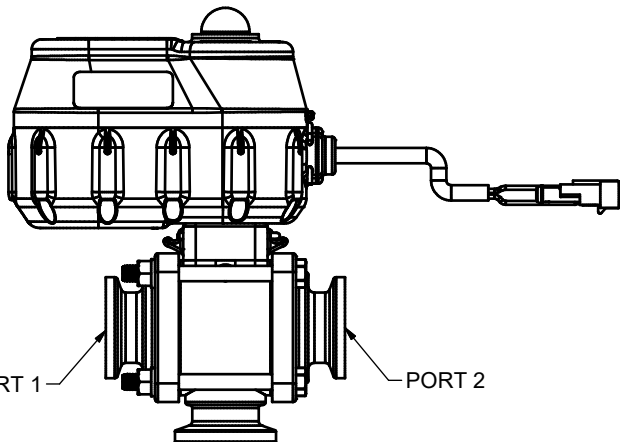

DETAIL A
SCALE 3 / 4

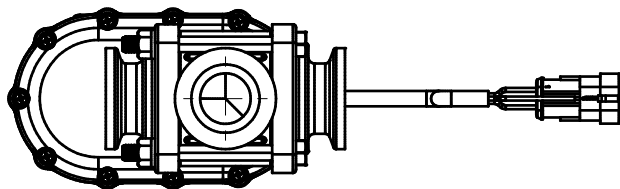
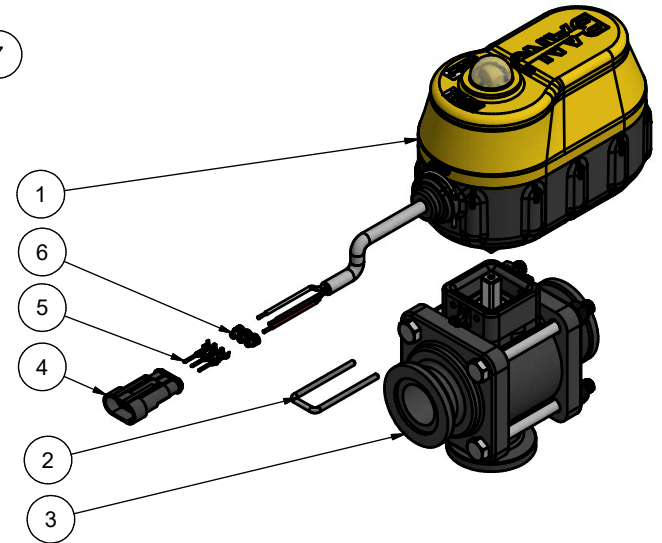

UNLESS OTHERWISE SPECIFIED
 ALL DIMENSIONS ARE IN INCHES
 GENERAL TOLERANCES:
 MOLDED 0.01 = ±0.025 MACHINED/PURCHASED 0.00 = ±0.010
 0.000 = ±0.010 0.000 = ±0.005
 FRACTIONS 1/16 = ±1/32
 ANGLES ±#°
 BREAK ALL SHOWN CORNERS W/ R1/32

DRAWN LS 20/01/2022

APPROVED

PRINT REVIEWED

MATERIAL

FINISH SCALE 3 / 8



BANJO CORPORATION

150 BANJO DRIVE, CRAWFORDSVILLE, IN 47933
 DESCRIPTION

MEVX 1"FP 0.75S WWC 3W 1B2R3W

DWG NO MEVX100BLA.idw DWG TYPE ENG REV 00

PART NO MEVX100BLA SIZE B SHEET 1 OF 2

ZONE	REV	DESCRIPTION	ECN	DATE	APPROVED
	00	INITIAL RELEASE	40471	01/20/22	LS

REVISION HISTORY

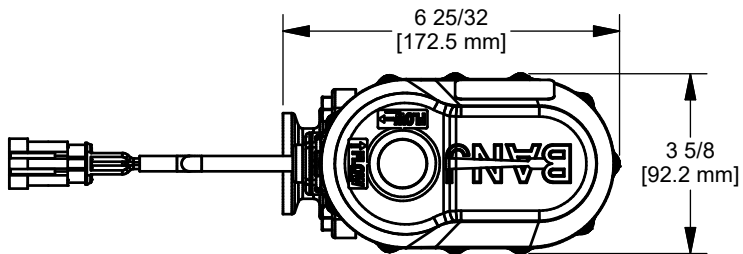

WIRING:

PIN 1: BLACK = GND
 PIN 2: RED = +12VDC
 PIN 3: WHITE = +12VDC (OPEN @ PORT 1)
 0VDC (OPEN @ PORT 2)

WIRE LENGTH: 18" ± 1"

Parts List			
ITEM	QTY	PART NUMBER	DESCRIPTION
1	1	EP21A10310	EVX ACT 0.75S WWC 3W
2	1	EVP20001	EV U-PIN
3	1	MEVX100BLX	1" EVX BL MANIFOLD VALVE
4	1	VE025	AMP 3 PIN TAB CONNECTOR 282105-1
5	3	VE026	AMP MINI MIC TAB 183024-1
6	3	VE027	AMP SINGLE WIRE SEAL 281934-2
7	1	VEL1020	VE "BL" Sticker
8	1	VEL1021	VE "BL" Sticker

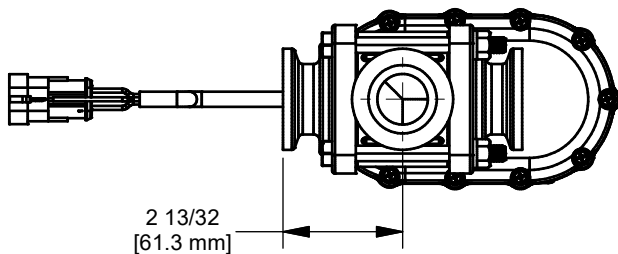
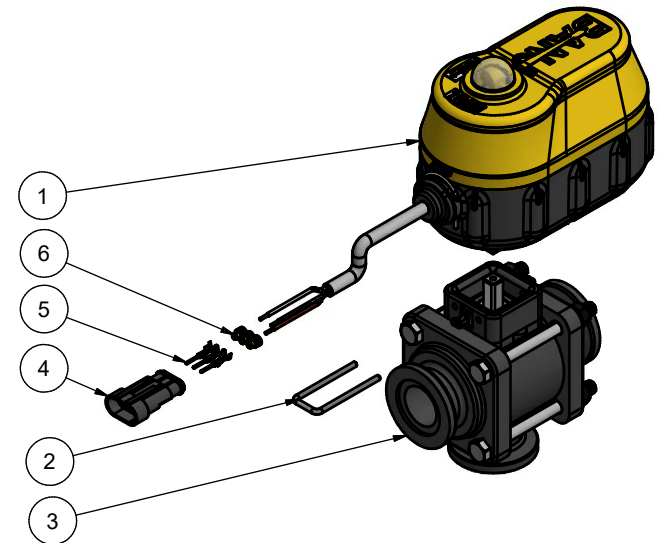
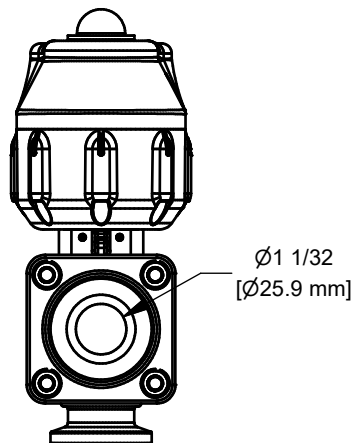
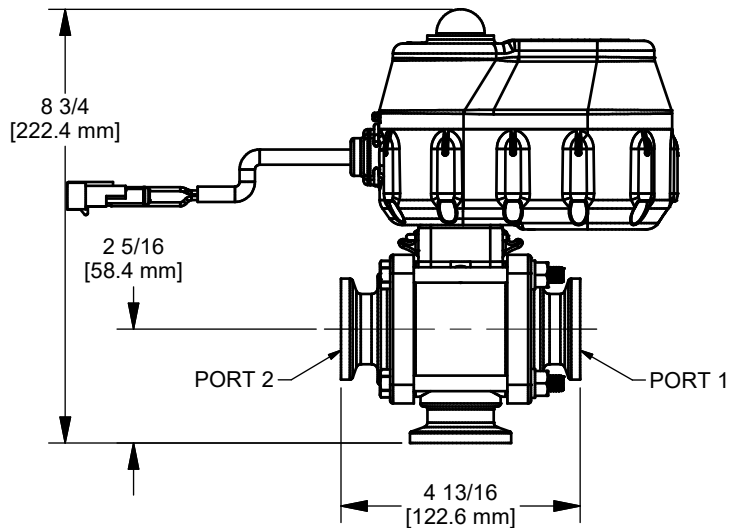

THIS DRAWING AND ALL INFORMATION CONTAINED THEREON ARE THE EXCLUSIVE PROPERTY OF BANJO CORPORATION.

UNLESS SPECIFICALLY NOTED, THIS DRAWING AND ITEMS SHOWN ON THIS DRAWING ARE SUBJECT TO CHANGE AT ANY TIME.



BANJO CORPORATION

150 BANJO DRIVE, CRAWFORDSVILLE, IN 47933
 WEB SITE: WWW.BANJOCORP.COM
 E-MAIL: BANJOSALES@IDEXCORP.COM

DESCRIPTION	MEVX 1"FP 0.75S WWC 3W 1B2R3W
PART NUMBER	MEVX100BLA