

4

3

2

1

NOTES:

CABLE LENGTH: 18" ±1" FROM HOUSING.

WIRING:

RED = +12VDC
BLACK = GND
WHITE = +12VDC (OPEN), 0VDC (CLOSE)
GREEN = +12VDC FEEDBACK (OPEN)
BROWN = +12VDC FEEDBACK (CLOSED)

Parts List

ITEM	QTY	PART NUMBER	DESCRIPTION
1	1	EP21A10513	EVX ACT 0.75S WWC 5W OPEN/CLOSE VERIFY
2	1	EVP20001	EV U-PIN
3	1	MEVX100HX	MEVX 1"FP STUBBY VALVE ONLY

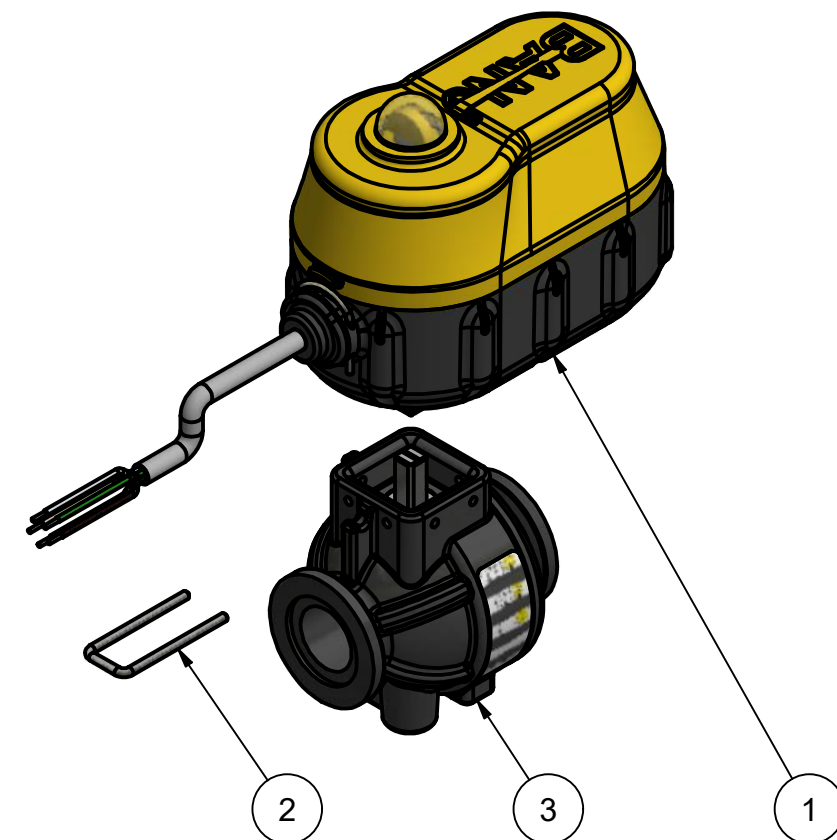
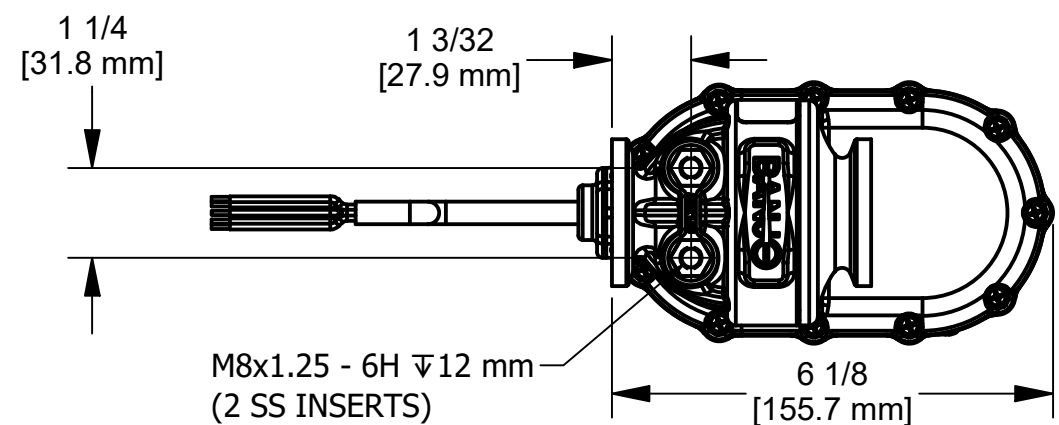
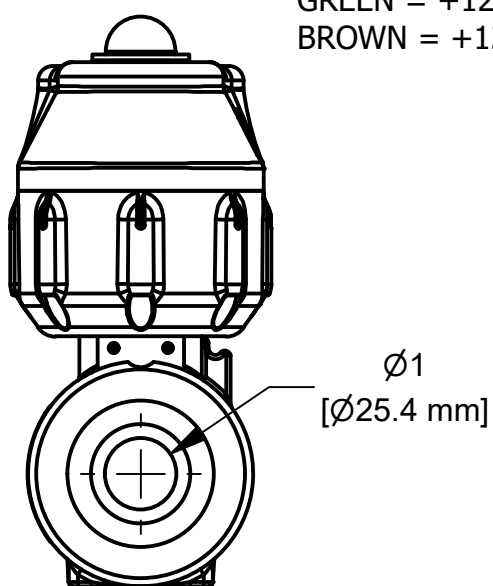
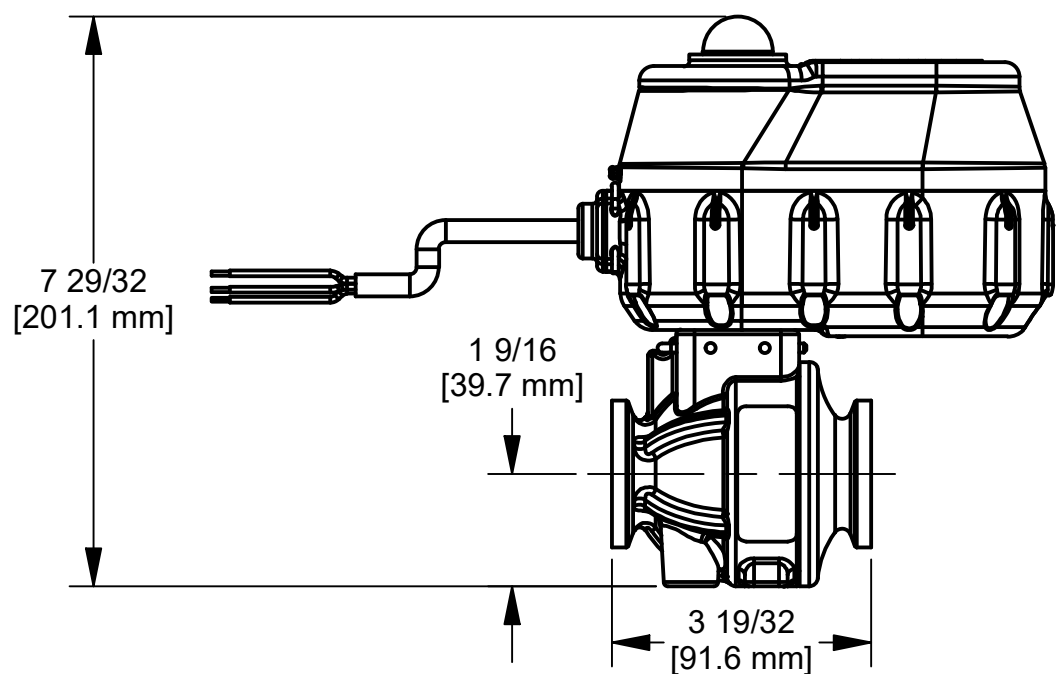
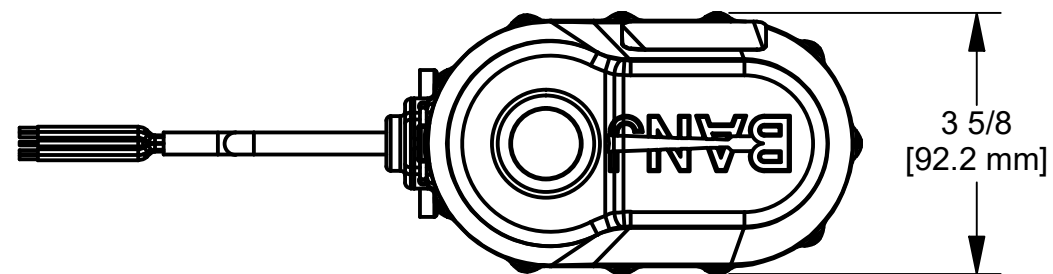

THIS DRAWING AND ALL INFORMATION CONTAINED THEREON ARE THE EXCLUSIVE PROPERTY OF BANJO CORPORATION.

UNLESS SPECIFICALLY NOTED, THIS DRAWING AND ITEMS SHOWN ON THIS DRAWING ARE SUBJECT TO CHANGE AT ANY TIME.



BANJO CORPORATION
150 BANJO DRIVE, CRAWFORDSVILLE, IN 47933
WEB SITE: WWW.BANJOCORP.COM
E-MAIL: BANJOSALES@IDEXCORP.COM

DESCRIPTION
MEVX 1"FP 0.75S WWC 5W OPEN/CLOSE VERIFY

PART NUMBER
MEVX100F3

4

3

2

1