

WIRING:

PIN 1: RED = +12VDC
 PIN 2: WHITE = +12VDC (OPEN), 0VDC (CLOSE)
 PIN 3: BLACK = GND
 PIN 4: PLUG

WIRE LENGTH: 18" ± 1"

Parts List			
ITEM	QTY	PART NUMBER	DESCRIPTION
1	1	EP21A10310	EVX ACT 0.75S WWC 3W
2	1	EVP20001	EV U-PIN
3	1	MEVX100SLX	1" EVX SL MANIFOLD VALVE
4	1	VE016	Deutsch Connector DT04-4P
5	1	VE017	Deutsch DT Wedgelock W4P
6	3	VE018	Deutsch Pin SZ 16-18 AWG
7	1	VE021	Deutsch Plug 114017

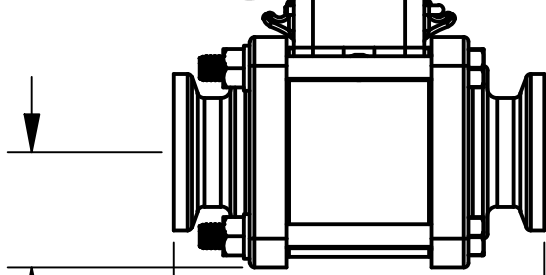
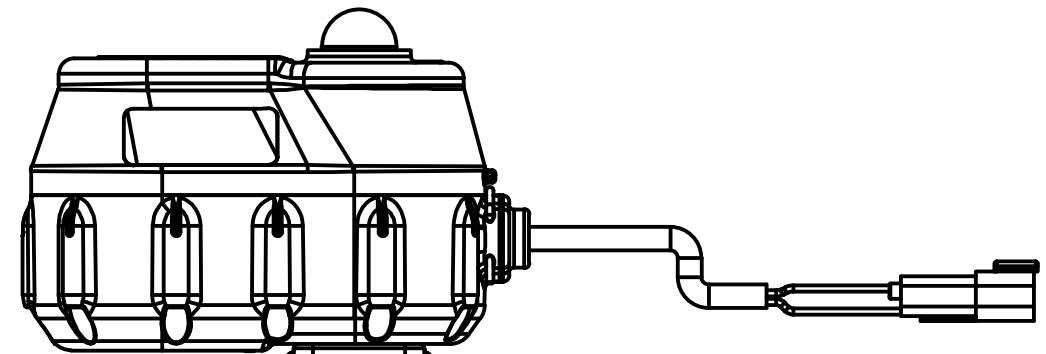

1 1/2
[38.1 mm]

4 13/16
[122.6 mm]

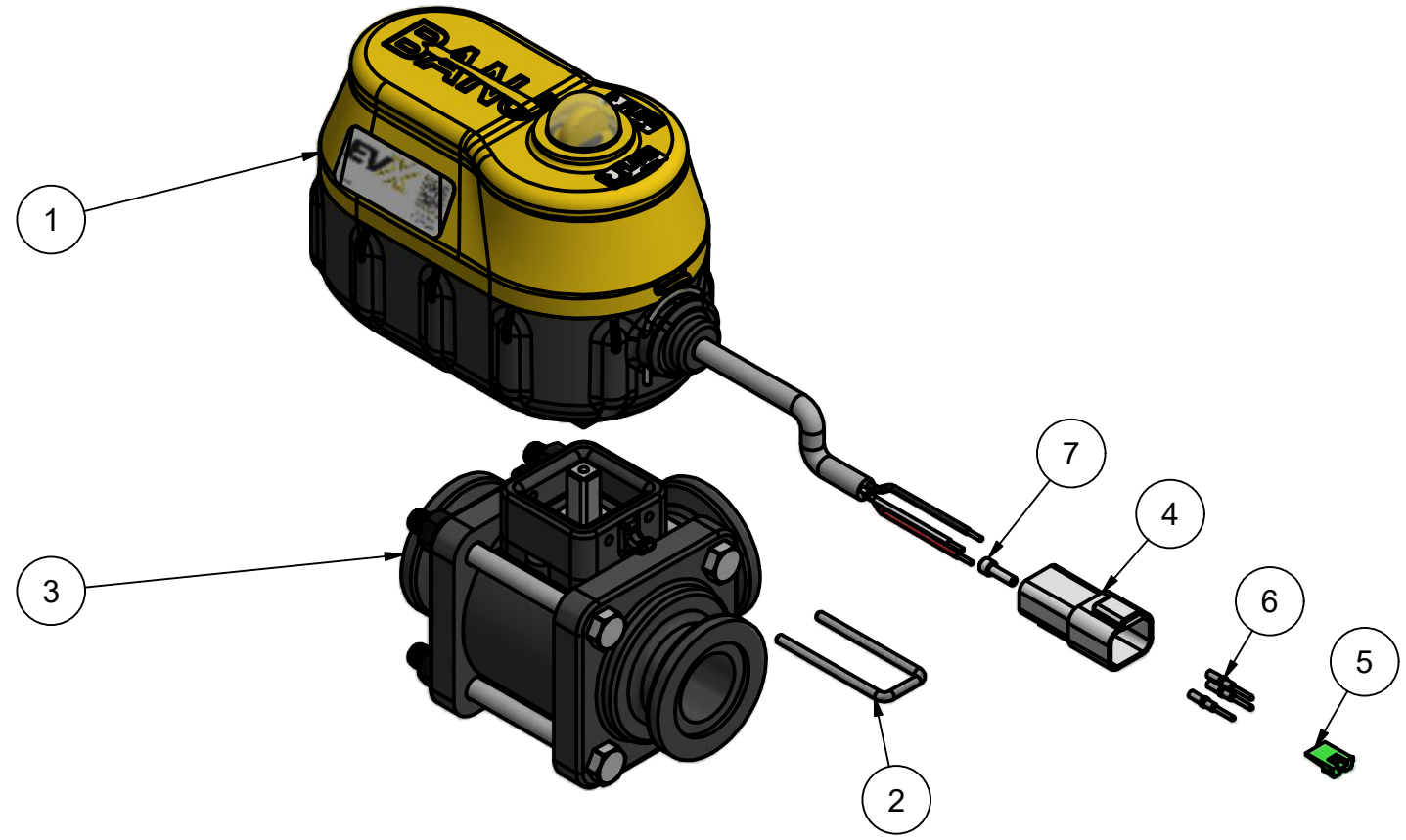
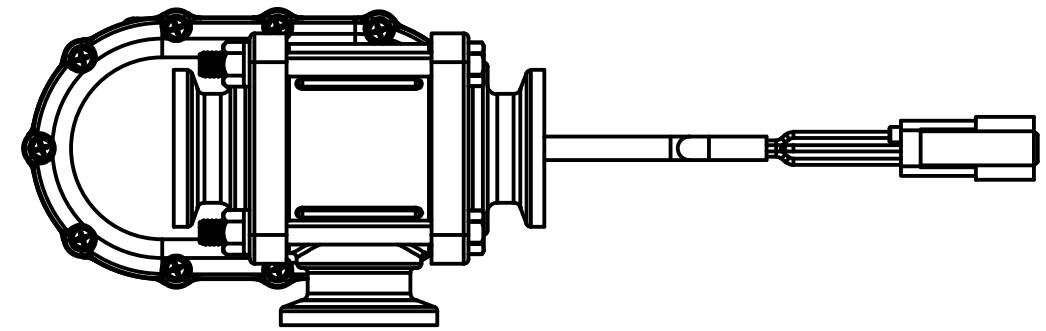

THIS DRAWING AND ALL INFORMATION CONTAINED THEREON ARE THE EXCLUSIVE PROPERTY OF BANJO CORPORATION.

UNLESS SPECIFICALLY NOTED, THIS DRAWING AND ITEMS SHOWN ON THIS DRAWING ARE SUBJECT TO CHANGE AT ANY TIME.



BANJO CORPORATION
 150 BANJO DRIVE, CRAWFORDSVILLE, IN 47933
 WEB SITE: WWW.BANJOCORP.COM
 E-MAIL: BANJOSALES@IDEXCORP.COM

DESCRIPTION
 MEVX 1" FP BL 0.75SEC 1B2R3G4W

PART NUMBER
 MEVX100SLA