

WIRING:
 RED = +12VDC
 BLACK = GND
 WHITE = +12VDC (OPEN), 0VDC (CLOSE)
 GREEN = +12VDC FEEDBACK (OPEN)
 BROWN = +12VDC FEEDBACK (CLOSED)

WIRE LENGTH: 18" ± 1"

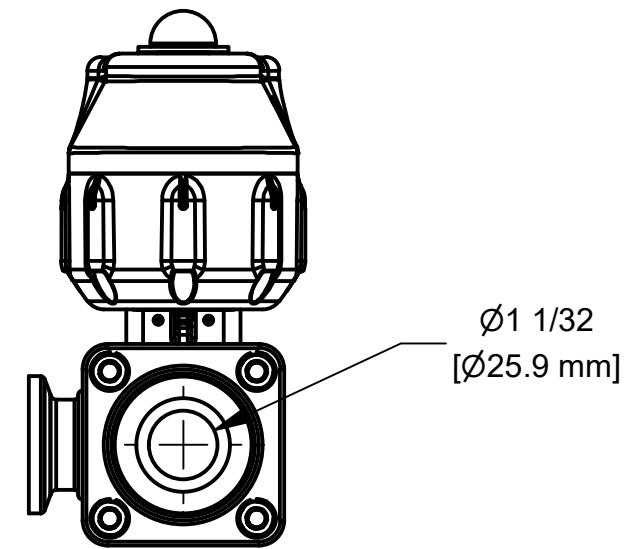

Parts List			
ITEM	QTY	PART NUMBER	DESCRIPTION
2	1	EVP20001	EV U-PIN
3	1	MEVX100SLX	1" EVX SL MANIFOLD VALVE
1	1	EP21A10513	EVX ACT 0.75S WWC 5W OPEN/CLOSE VERIFY

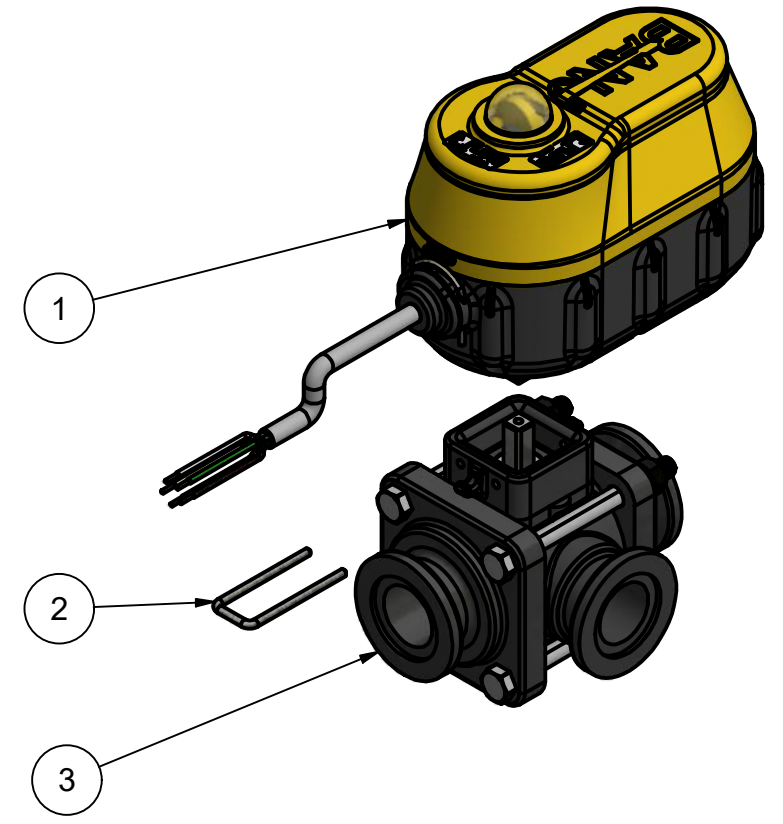

THIS DRAWING AND ALL INFORMATION CONTAINED THEREON ARE THE EXCLUSIVE PROPERTY OF BANJO CORPORATION.

UNLESS SPECIFICALLY NOTED, THIS DRAWING AND ITEMS SHOWN ON THIS DRAWING ARE SUBJECT TO CHANGE AT ANY TIME.

BANJO CORPORATION
 150 BANJO DRIVE, CRAWFORDSVILLE, IN 47933
 WEB SITE: WWW.BANJOCORP.COM
 E-MAIL: BANJOSALES@IDEXCORP.COM

DESCRIPTION	MEVX 1"FP SL 0.75S WWC 5W OPEN/CLOSE VERIFY
PART NUMBER	MEVX100SLF3