

4

3

2

1

Parts List

ITEM	QTY	PART NUMBER	DESCRIPTION
1	1	EP22A10320	EVX ACT 0.75S WWC 3W 24V
2	1	EVP20001	EV U-PIN
3	1	MEVX101X	1" EVX 2-WAY BOLTED MANIFOLD VALVE

NOTES:

CABLE LENGTH: 18" ±1" FROM HOUSING.

WIRING:

RED = +24VDC
 BLACK = GND
 WHITE = +24VDC (OPEN), 0VDC (CLOSE)

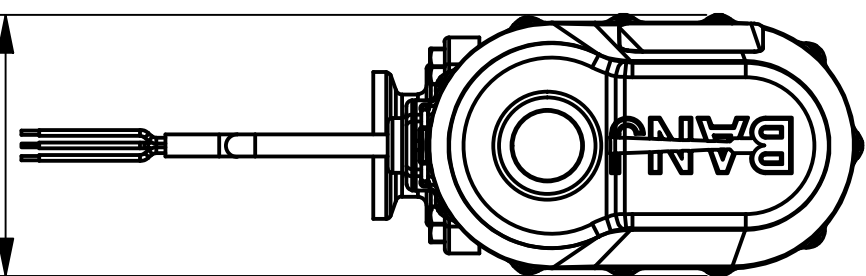

3 5/8
[92.2 mm]

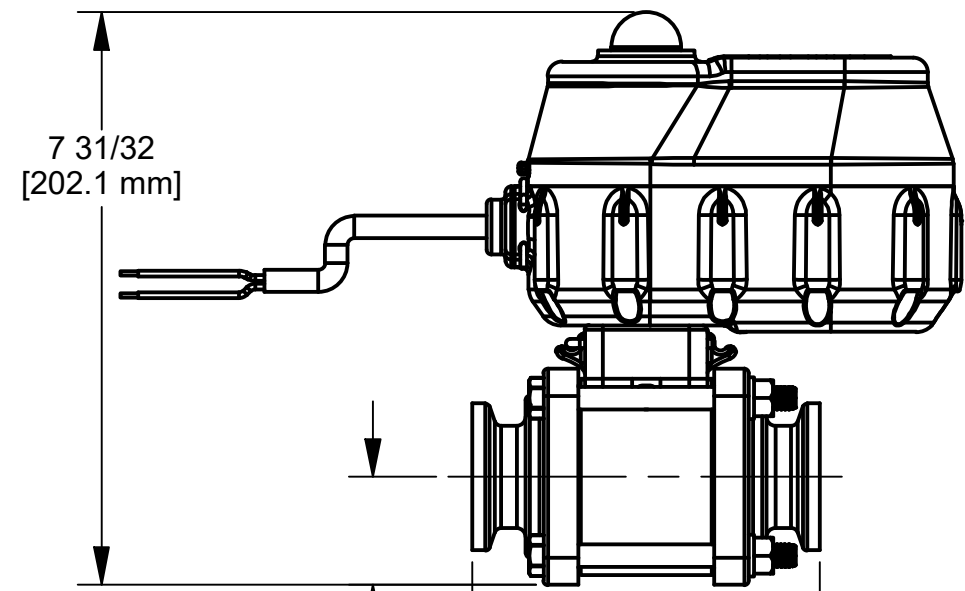

7 31/32
[202.1 mm]

1 1/2
[38.1 mm]

4 13/16
[122.6 mm]

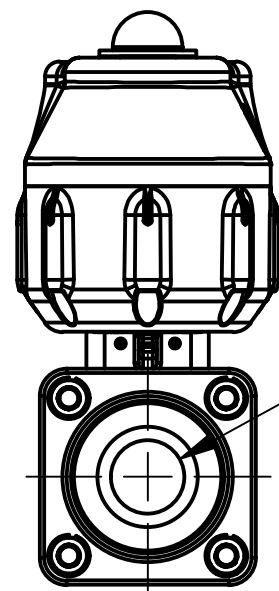

Ø1 1/32
[Ø25.9 mm]

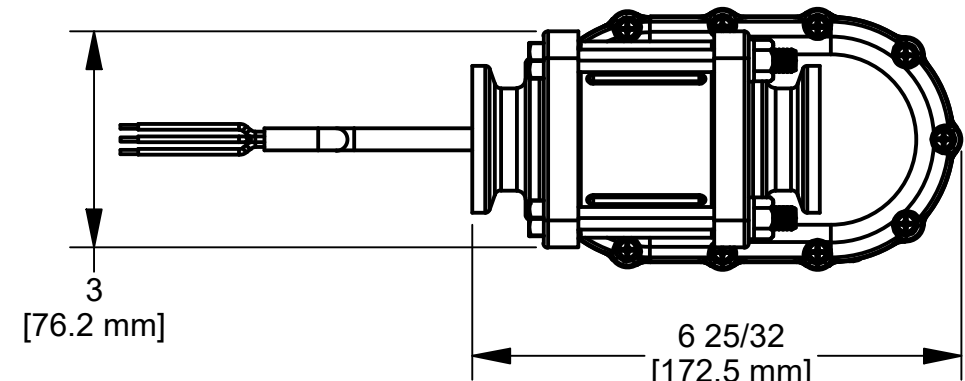
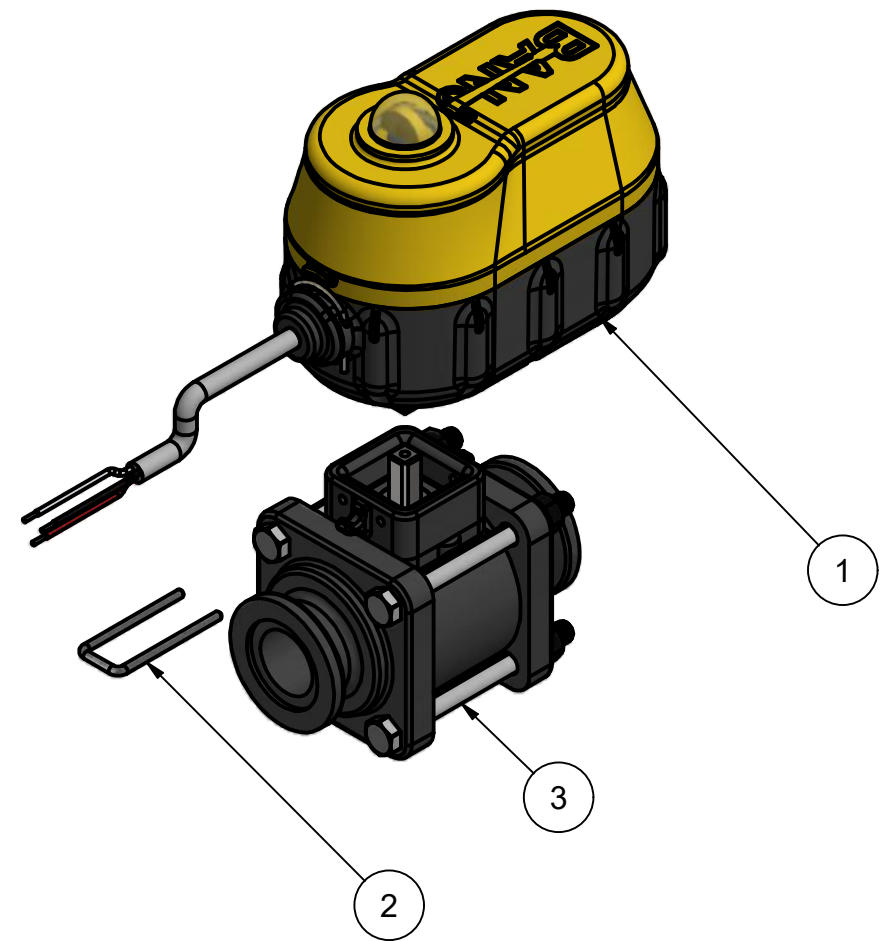

3
[76.2 mm]

6 25/32
[172.5 mm]



BANJO CORPORATION
 150 BANJO DRIVE, CRAWFORDSVILLE, IN 47933
 WEB SITE: WWW.BANJOCORP.COM
 E-MAIL: BANJOSALES@IDEXCORP.COM

DESCRIPTION
 MEVX 1"FP BOLTED 0.75S 3W WWC 24V

PART NUMBER
 MEVX10124

THIS DRAWING AND ALL INFORMATION CONTAINED THEREON ARE THE EXCLUSIVE PROPERTY OF BANJO CORPORATION.

UNLESS SPECIFICALLY NOTED, THIS DRAWING AND ITEMS SHOWN ON THIS DRAWING ARE SUBJECT TO CHANGE AT ANY TIME.