

Parts List			
ITEM	QTY	PART NUMBER	DESCRIPTION
1	2	EP21A10310	EVX ACT 0.75S WWC 3W
2	2	EVP20001	EV U-PIN
3	2	FC100	1" HI TORQUE CLAMP
4	1	FC200	2" HI TORQUE CLAMP
5	2	M101G	1" Manifold Gasket w/ Rib
6	2	M200100TEE	2" Manifold Tee w/ 1" Side Port
7	1	M201G	2" Manifold Gasket w/ Rib
8	2	MEVX101X	1" EVX 2-WAY BOLTED MANIFOLD VALVE
9	6	VE001	CABLE SEAL
10	6	VE002	MALE TERMINAL
11	2	VE003	3 Conductor Female Shroud

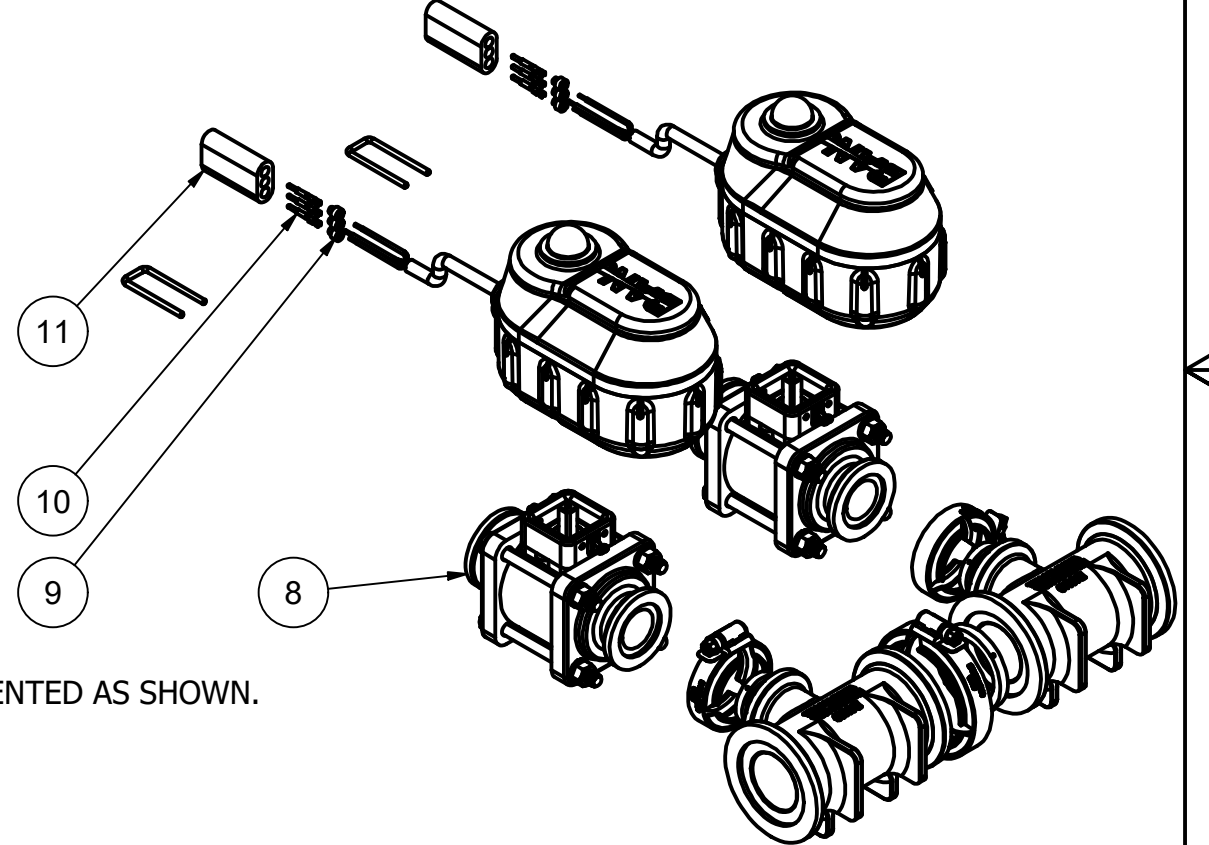

NOTES:

CLAMPS MUST BE ORIENTED AS SHOWN.

WIRING:

PIN A: RED = +12VDC  
 PIN B: BLACK = GND  
 PIN C: WHITE = +12VDC (OPEN), 0VDC (CLOSE)

WIRE LENGTH: 18" ± 1"

THIS DRAWING AND ALL INFORMATION CONTAINED THEREON ARE THE EXCLUSIVE PROPERTY OF BANJO CORPORATION.  
 UNLESS SPECIFICALLY NOTED, THIS DRAWING AND ITEMS SHOWN ON THIS DRAWING ARE SUBJECT TO CHANGE AT ANY TIME.

**BANJO CORPORATION**  
 BANJO CORPORATION  
 150 BANJO DRIVE, CRAWFORDSVILLE, IN 47933  
 WEB SITE: WWW.BANJOCORP.COM  
 E-MAIL: BANJOSALES@IDEXCORP.COM

DESCRIPTION  
 MEVX 1" FP 2-BANK 2" IN/1"FP OUT, BOLTED

PART NUMBER  
 MEVX1012A