

GAP DISTANCE BETWEEN
BOTTOM OF TEE AND
BOTTOM OF VALVE

0.280

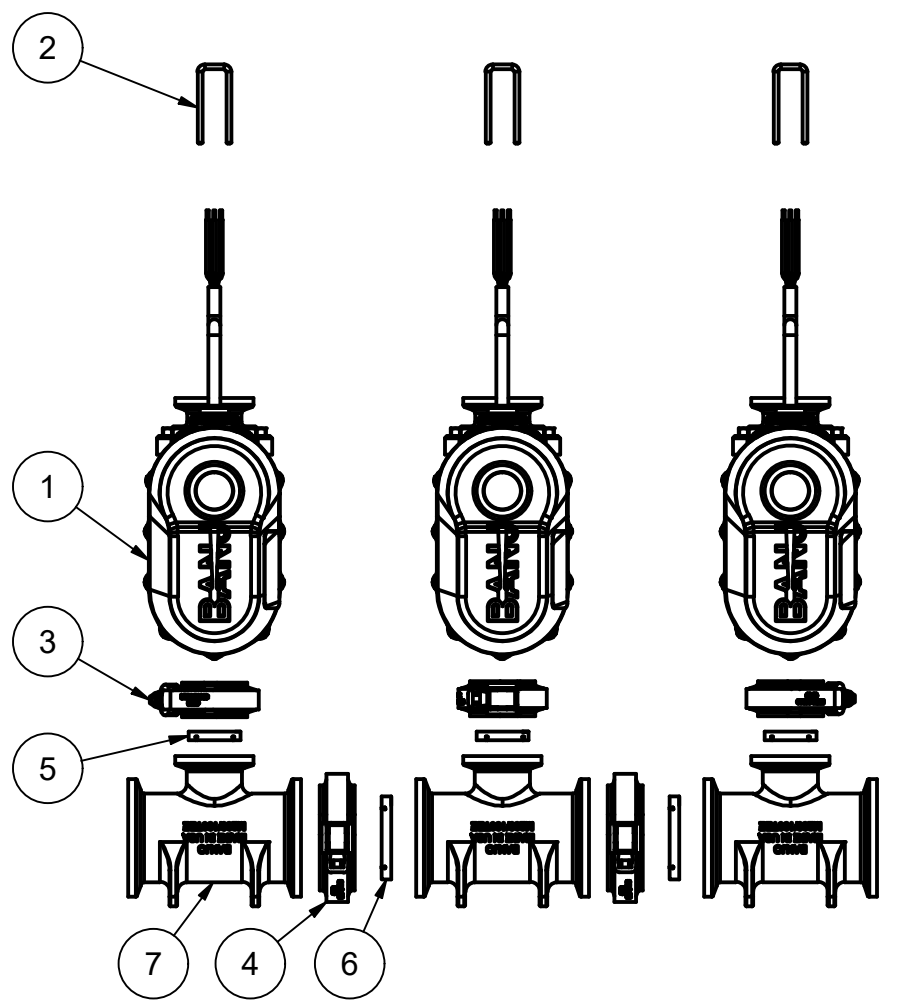

WIRING:
 RED = +12VDC
 BLACK = GND
 WHITE = +12VDC (OPEN), 0VDC (CLOSE)

WIRE LENGTH: 18" ± 1"

PARTS LIST			
ITEM	QTY	PART NUMBER	DESCRIPTION
1	3	EP21A10310	EVX ACT 0.75S WWC 3W
2	3	EVP20001	EV U-PIN
3	3	FC100	1" HI TORQUE CLAMP
4	2	FC200	2" HI TORQUE CLAMP
5	3	M101G	1" Manifold Gasket w/ Rib
6	2	M201G	2" Manifold Gasket w/ Rib
7	3	M200100TEE	2" Manifold Tee w/ 1" Side Port
8	3	MEVX101X	1" EVX 2-WAY BOLTED MANIFOLD VALVE

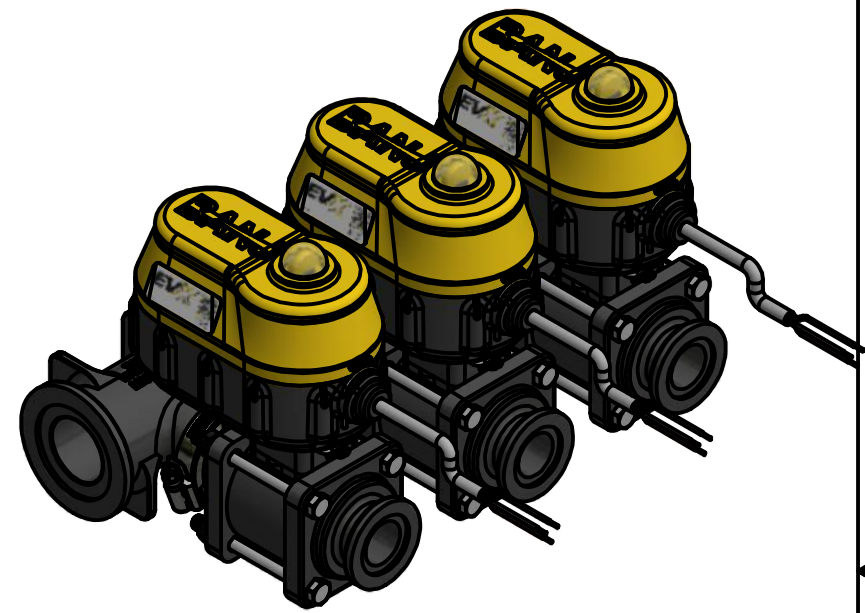

THIS DRAWING AND ALL INFORMATION CONTAINED THEREON ARE THE EXCLUSIVE PROPERTY OF BANJO CORPORATION.
 UNLESS SPECIFICALLY NOTED, THIS DRAWING AND ITEMS SHOWN ON THIS DRAWING ARE SUBJECT TO CHANGE AT ANY TIME.



BANJO CORPORATION
 150 BANJO DRIVE, CRAWFORDSVILLE, IN 47933
 WEB SITE: WWW.BANJOCORP.COM
 E-MAIL: BANJOSALES@IDEXCORP.COM

DESCRIPTION	MEVX 1" FP 3-BANK 2" IN/1"FP OUT, BOLTED
PART NUMBER	MEVX1013