

**WIRING:**  
 PIN A: RED = +12VDC  
 PIN B: BLACK = GND  
 PIN C: WHITE = +12VDC (OPEN), 0VDC (CLOSE)

PARTS LIST			
ITEM	QTY	PART NUMBER	DESCRIPTION
1	1	EP21A10310	EVX ACT 0.75S WWC 3W
2	1	EVP20001	EV U-PIN
3	1	MEVX101X	1" EVX 2-WAY BOLTED MANIFOLD VALVE
4	3	VE001	CABLE SEAL
5	3	VE002	MALE TERMINAL
6	1	VE003	3 Conductor Female Shroud

\*TO PURCHASE ACTUATOR ONLY WITH CONNECTOR:  
 PART NUMBER IS: **EP21A10310C3**

WIRE LENGTH: 18" ±1" FROM HOUSING.

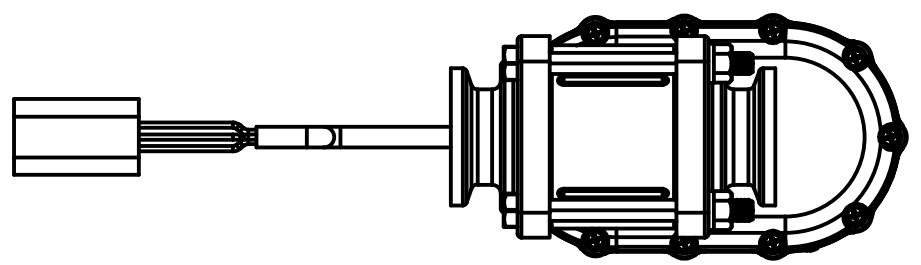
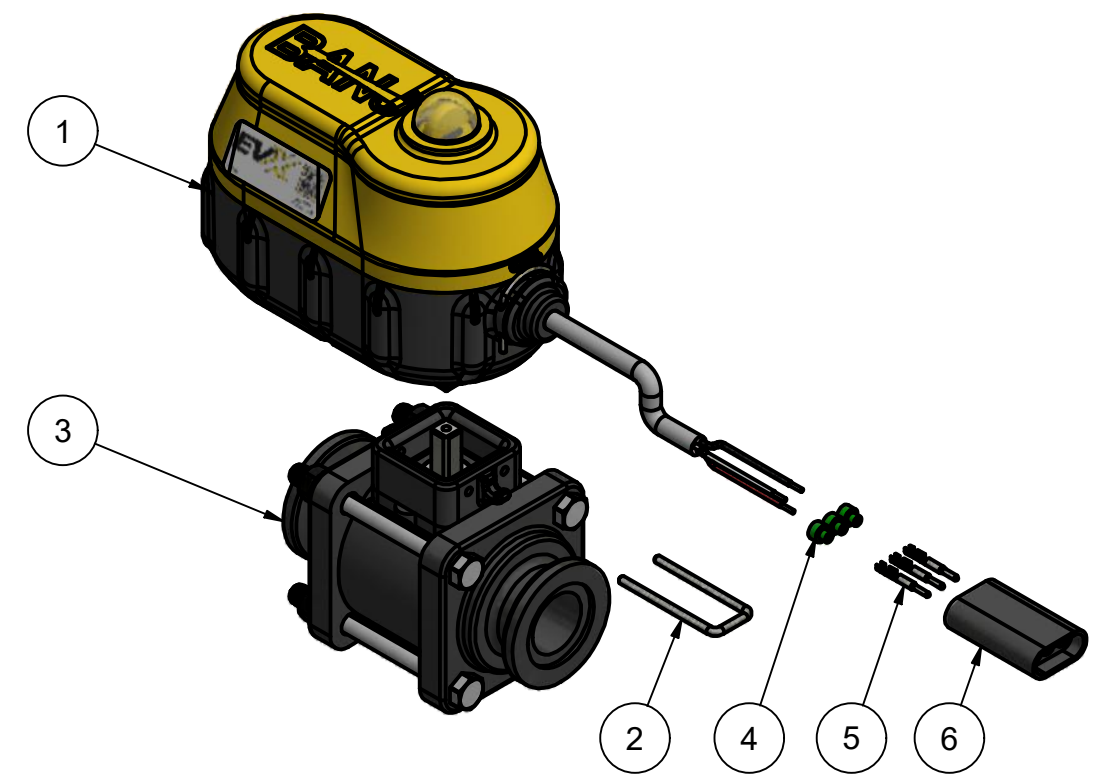
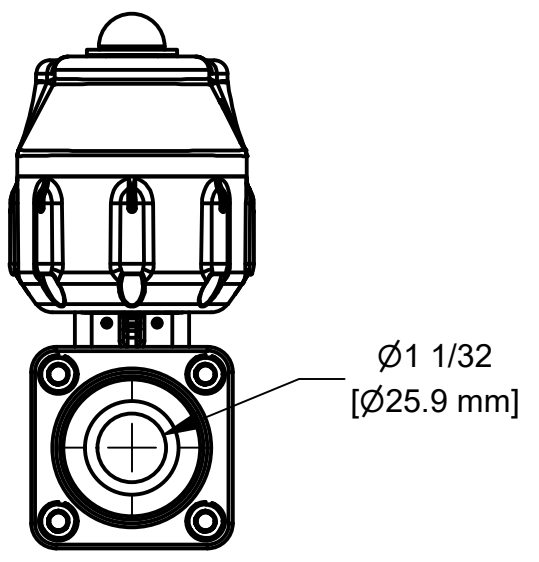
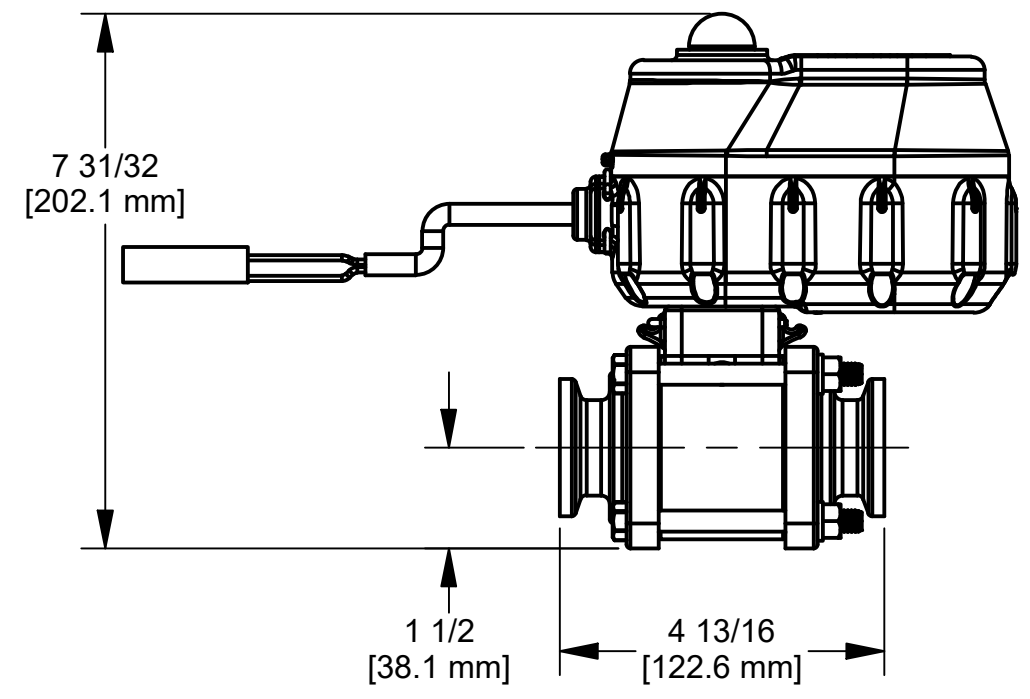

THIS DRAWING AND ALL INFORMATION CONTAINED THEREON ARE THE EXCLUSIVE PROPERTY OF BANJO CORPORATION.

UNLESS SPECIFICALLY NOTED, THIS DRAWING AND ITEMS SHOWN ON THIS DRAWING ARE SUBJECT TO CHANGE AT ANY TIME.

**BANJO CORPORATION**

150 BANJO DRIVE, CRAWFORDSVILLE, IN 47933  
 WEB SITE: WWW.BANJOCORP.COM  
 E-MAIL: BANJOSALES@IDEXCORP.COM

DESCRIPTION  
**MEVX 1" BOLTED 0.75S WWC ARBBCW**

PART NUMBER  
**MEVX101A**