

WIRING:
 PIN A: RED = +12VDC
 PIN B: BLACK = GND
 PIN C: WHITE = +12VDC (OPEN), 0VDC (CLOSE)

CONNECTOR: APTIV (FORMERLY DELPHI):
 12010717

WIRE LENGTH: 18" ± 1"

GAP DISTANCE BETWEEN
 BOTTOM OF TEE AND
 BOTTOM OF VALVE

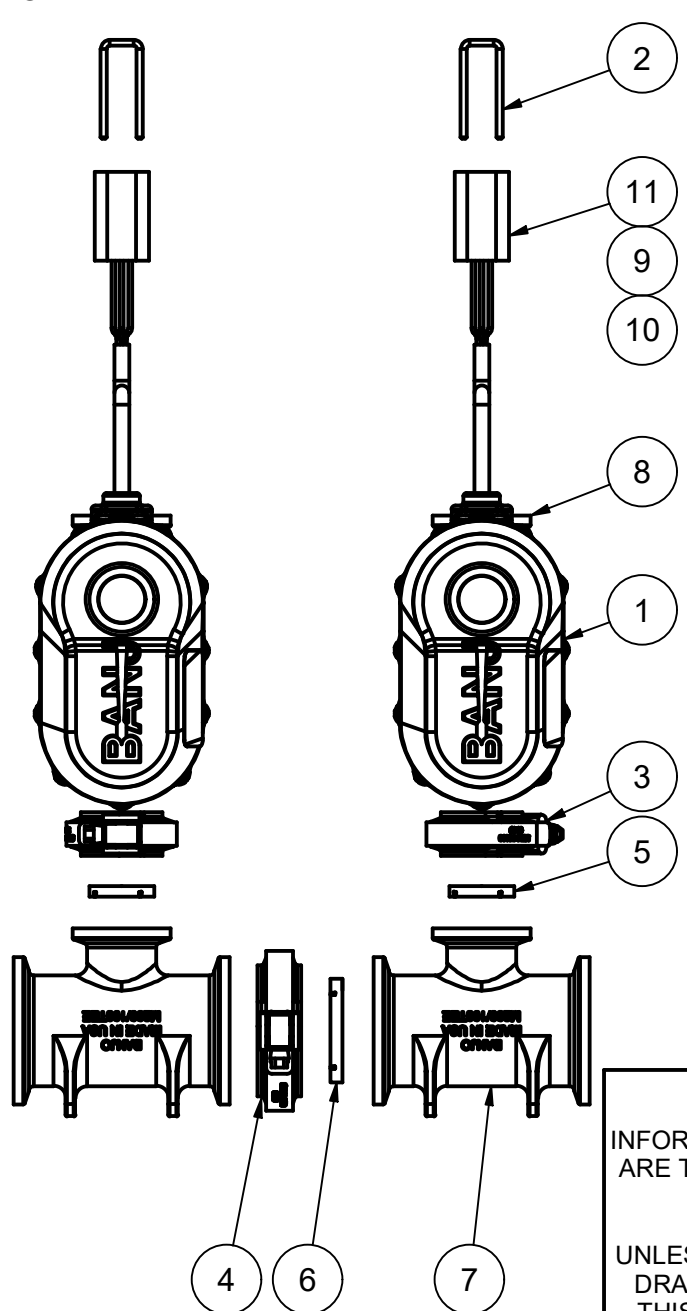

Parts List			
ITEM	QTY	PART NUMBER	DESCRIPTION
1	2	EP21A10310	EVX ACT 0.75S WWC 3W
2	2	EVP20001	EV U-PIN
3	2	FC100	1" HI TORQUE CLAMP
4	1	FC200	2" HI TORQUE CLAMP
5	2	M101G	1" Manifold Gasket w/ Rib
6	1	M201G	2" Manifold Gasket w/ Rib
7	2	M200100TEE	2" Manifold Tee w/ 1" Side Port
8	2	MEVX100HX	MEVX 1"FP STUBBY VALVE ONLY
9	6	VE001	CABLE SEAL
10	6	VE002	MALE TERMINAL
11	2	VE003	3 Conductor Female Shroud

*TO PURCHASE ACTUATOR ONLY WITH
 CONNECTOR: PART NUMBER IS: **EP21A10310C3**

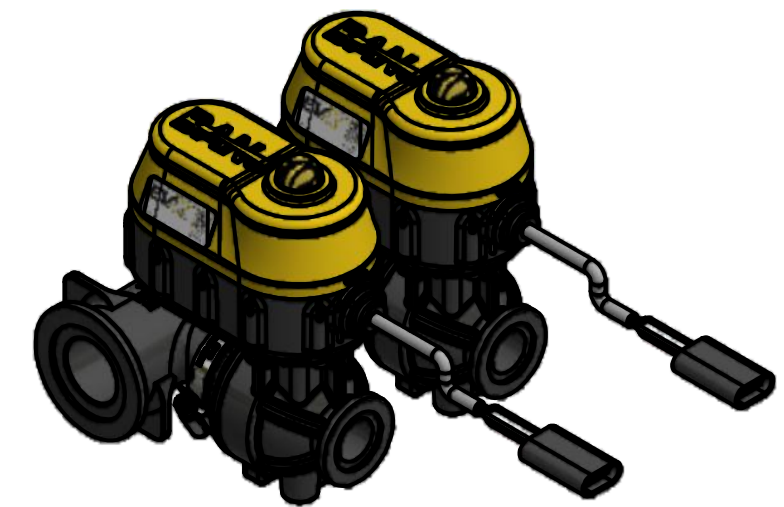

THIS DRAWING AND ALL
 INFORMATION CONTAINED THEREON
 ARE THE EXCLUSIVE PROPERTY OF
 BANJO CORPORATION.

UNLESS SPECIFICALLY NOTED, THIS
 DRAWING AND ITEMS SHOWN ON
 THIS DRAWING ARE SUBJECT TO
 CHANGE AT ANY TIME.

BANJO CORPORATION

150 BANJO DRIVE, CRAWFORDSVILLE, IN 47933
 WEB SITE: WWW.BANJOCORP.COM
 E-MAIL: BANJOSALES@IDEXCORP.COM

DESCRIPTION
MEVX 2 BANK 2"SP IN, 1" OUT

PART NUMBER
MEVX102A