

NOTES:
 WIRING:
 PIN A: BLACK = GND
 PIN B: WHITE = +12VDC (OPEN), 0VDC (CLOSE)
 PIN C: RED = +12VDC
 WIRE LENGTH = 18" ± 1"

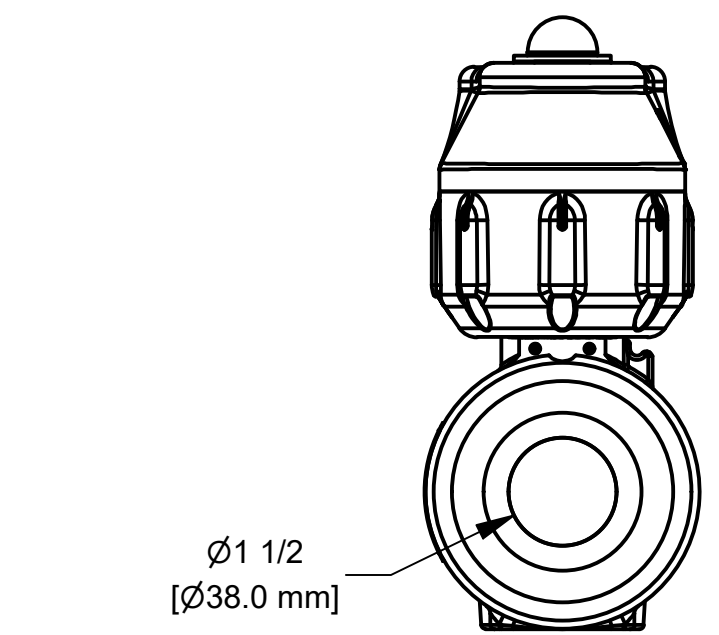

PARTS LIST			
ITEM	QTY	PART NUMBER	DESCRIPTION
1	1	EP31B10310	EVX ACT 1.5S WWC 3W
2	1	EVP20001	EV U-PIN
3	1	MEVX200HX	MEVX 2" STUBBY VALVE ONLY
4	3	VE001	CABLE SEAL
5	1	VE009	3 TERMINAL MALE TOWER
6	3	VE010	FEMALE TERMINAL

*TO PURCHASE ACTUATOR ONLY WITH CONNECTOR: PART NUMBER IS: **EP31B10310C7**

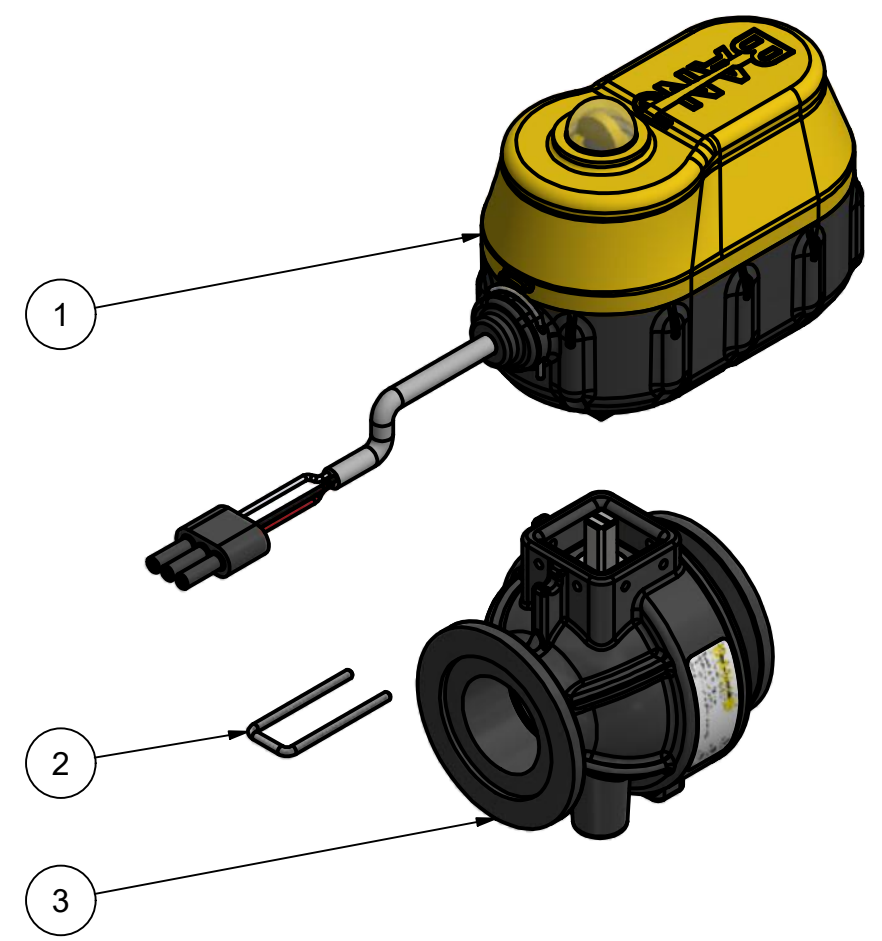

THIS DRAWING AND ALL INFORMATION CONTAINED THEREON ARE THE EXCLUSIVE PROPERTY OF BANJO CORPORATION.
 UNLESS SPECIFICALLY NOTED, THIS DRAWING AND ITEMS SHOWN ON THIS DRAWING ARE SUBJECT TO CHANGE AT ANY TIME.

BANJO CORPORATION
 BANJO CORPORATION
 150 BANJO DRIVE, CRAWFORDSVILLE, IN 47933
 WEB SITE: WWW.BANJOCORP.COM
 E-MAIL: BANJOSALES@IDEXCORP.COM

DESCRIPTION
MEVX 2" STD PORT 1.5S WWC ABBWCR

PART NUMBER
MEVX200B