

WIRING:
 RED = +12VDC
 BLACK = GND
 WHITE = +12VDC (OPEN), 0VDC (CLOSE)
 BROWN = +12VDC FEEDBACK (CLOSED)
 GREEN = +12VDC FEEDBACK (OPEN)

WIRE LENGTH: 18" ± 1"

Parts List			
ITEM	QTY	PART NUMBER	DESCRIPTION
1	1	EP31B10513	EVX ACT 1.5S WWC 5W OP/CL-VFY
2	1	EVP20001	EV U-PIN
3	1	MEVX200HX	2" STD PORT MEVX VALVE ONLY

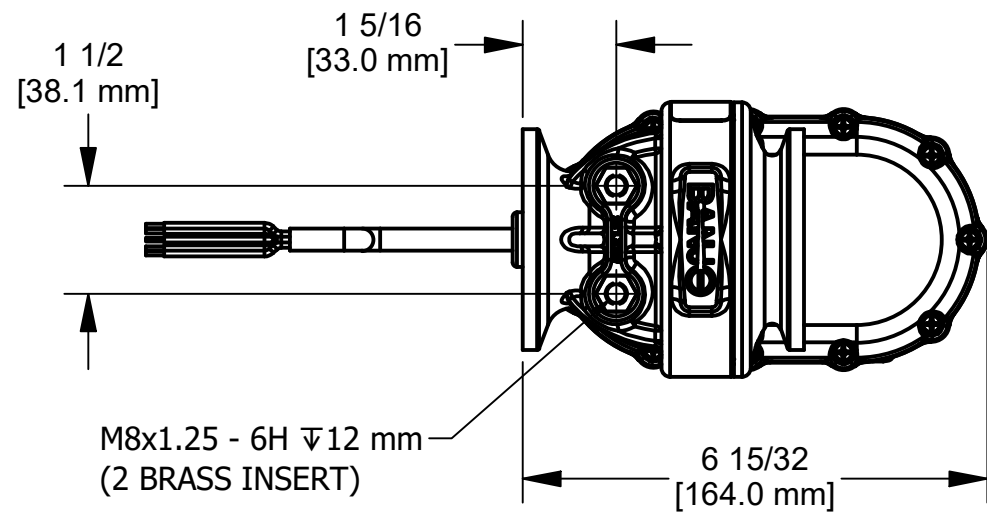
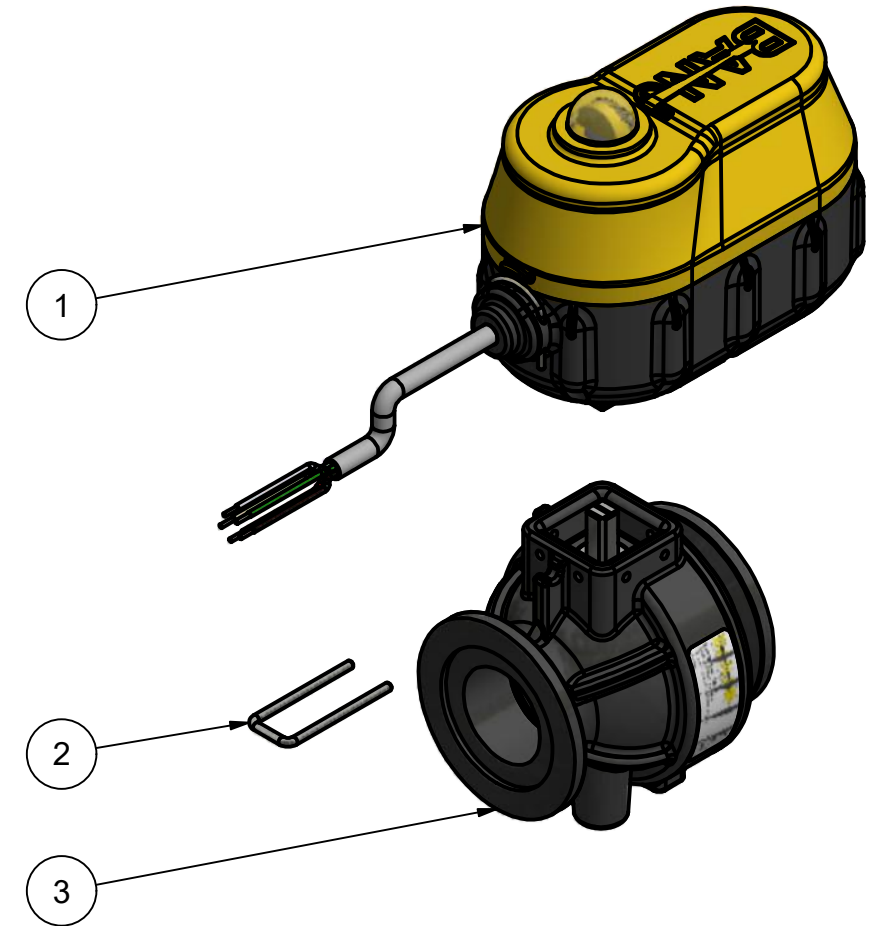
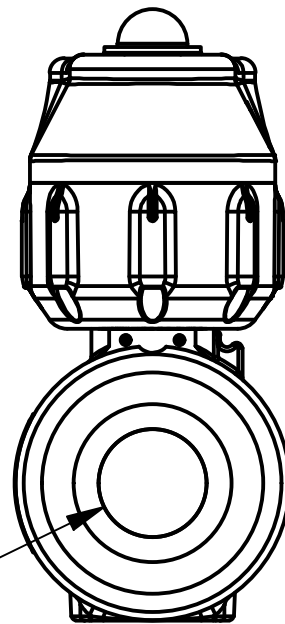
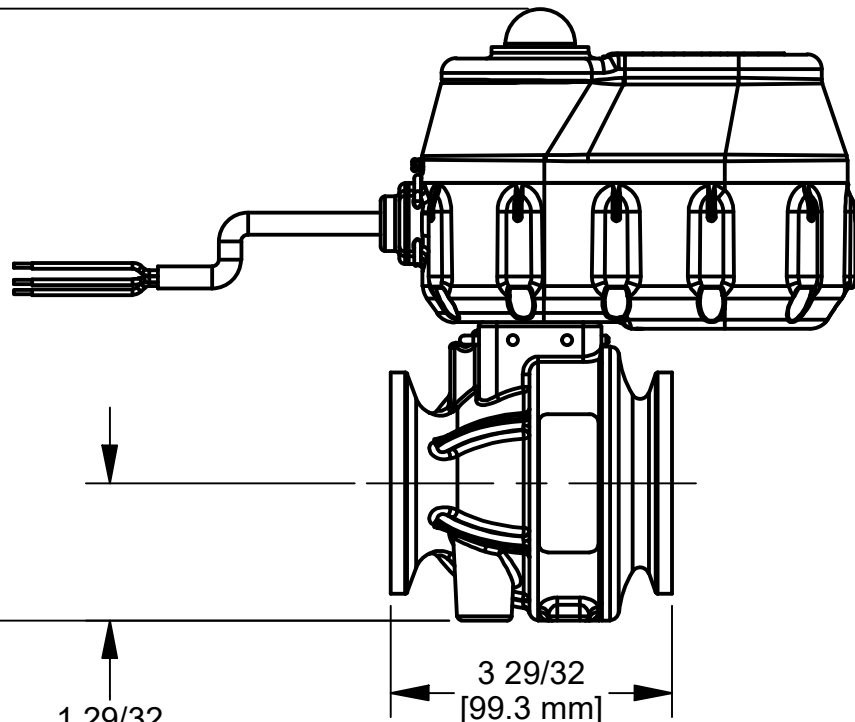

THIS DRAWING AND ALL INFORMATION CONTAINED THEREON ARE THE EXCLUSIVE PROPERTY OF BANJO CORPORATION.

UNLESS SPECIFICALLY NOTED, THIS DRAWING AND ITEMS SHOWN ON THIS DRAWING ARE SUBJECT TO CHANGE AT ANY TIME.

BANJO CORPORATION

BANJO CORPORATION
 150 BANJO DRIVE, CRAWFORDSVILLE, IN 47933
 WEB SITE: WWW.BANJOCORP.COM
 E-MAIL: BANJOSALES@IDEXCORP.COM

DESCRIPTION
 MEVX 2" STD PORT 1.5S WWC 5W
 OPEN/CLOSE VERIFY

PART NUMBER
 MEVX200F3