

4

3

2

1

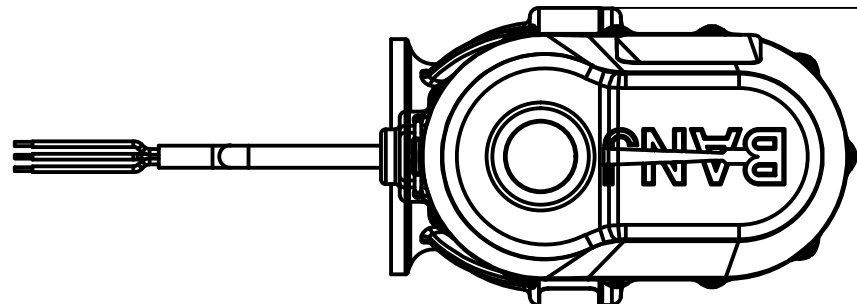

4 1/8  
[105.2 mm]

NOTES:

CABLE LENGTH: 18" ±1" FROM HOUSING

WIRING:

RED = +24VDC  
BLACK = GND  
WHITE = +24VDC (OPEN), 0VDC (CLOSE)

Parts List

ITEM	QTY	PART NUMBER	DESCRIPTION
1	1	EP32B10320	EVX ACT 1.5S WWC 3W 24V
2	1	EVP20001	EV U-PIN
3	1	MEVX220HX	MEVX 2"FP STUBBY VALVE ONLY

B

B

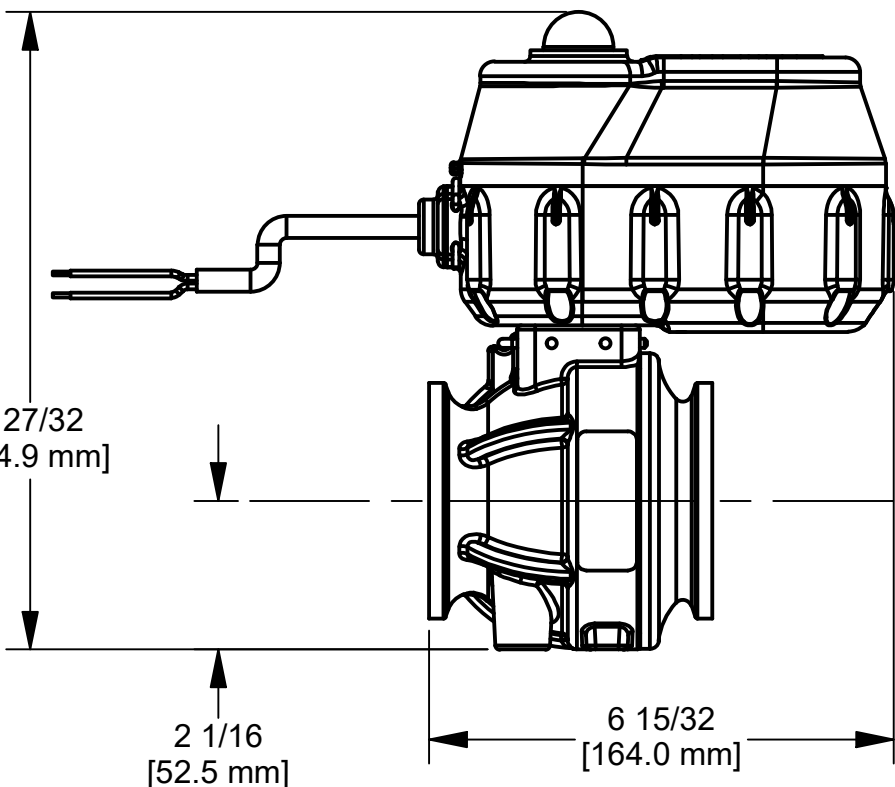

8 27/32  
[224.9 mm]

2 1/16  
[52.5 mm]

6 15/32  
[164.0 mm]

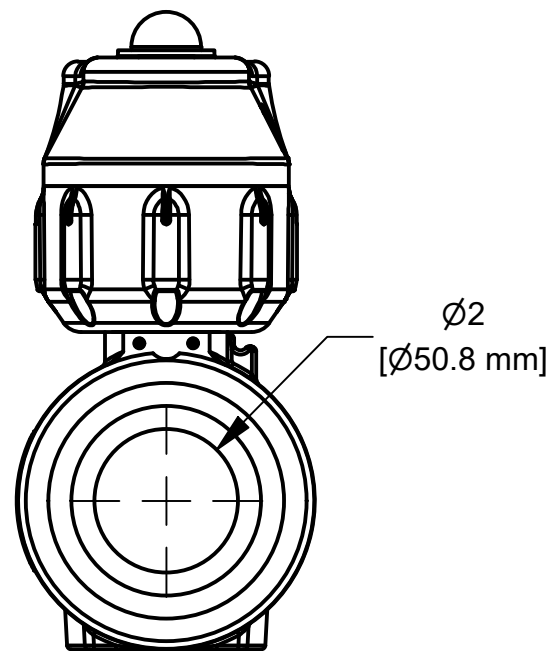

Ø2  
[Ø50.8 mm]

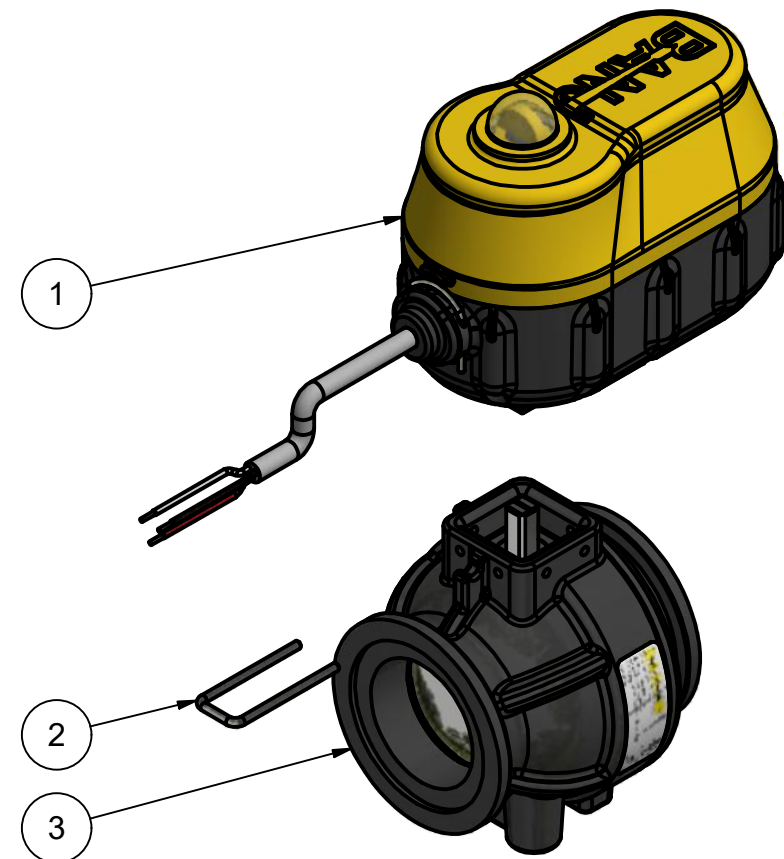

1

2

3

A

A

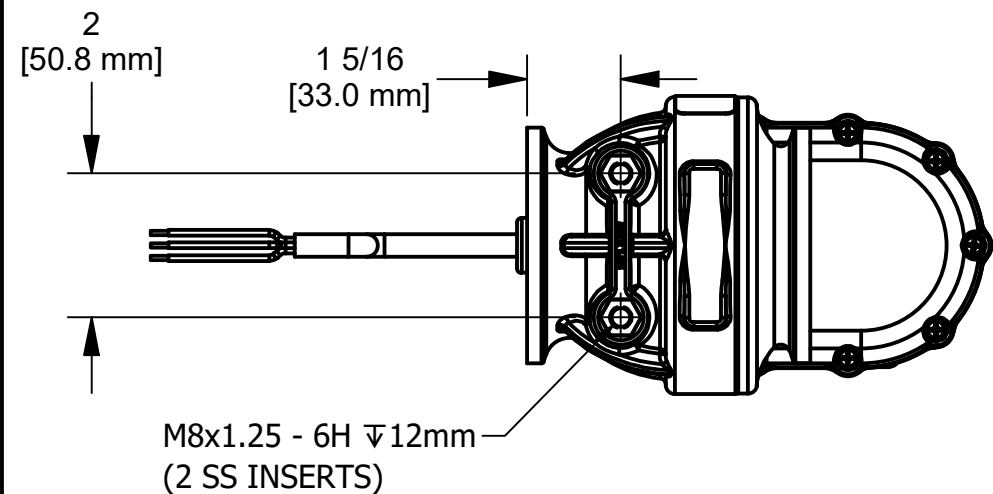

2  
[50.8 mm]

1 5/16  
[33.0 mm]

M8x1.25 - 6H ∇12mm  
(2 SS INSERTS)

4

3

2

1

THIS DRAWING AND ALL INFORMATION CONTAINED THEREON ARE THE EXCLUSIVE PROPERTY OF BANJO CORPORATION.  
  
UNLESS SPECIFICALLY NOTED, THIS DRAWING AND ITEMS SHOWN ON THIS DRAWING ARE SUBJECT TO CHANGE AT ANY TIME.



**BANJO CORPORATION**  
150 BANJO DRIVE, CRAWFORDSVILLE, IN 47933  
WEB SITE: WWW.BANJOCORP.COM  
E-MAIL: BANJOSALES@IDEXCORP.COM

DESCRIPTION  
MEVX 2"FP 1.5S WWC 3W 24V  
PART NUMBER  
MEVX22024