

NOTES:

CABLE LENGTH: 18" ±1" FROM HOUSING

WIRING:

RED = +24VDC
 BLACK = GND
 WHITE = +24VDC (OPEN), 0VDC (CLOSE)
 GREEN = +24VDC FEEDBACK (OPEN)
 BROWN = +24VDC FEEDBACK (CLOSED)

| Parts List | | | |
|------------|-----|-------------|-----------------------------------|
| ITEM | QTY | PART NUMBER | DESCRIPTION |
| 1 | 1 | EP32B10523 | EVX ACT 1.5S WWC 5W 24V OP/CL-VFY |
| 2 | 1 | EVP20001 | EV U-PIN |
| 3 | 1 | MEVX220HX | MEVX 2"FP STUBBY VALVE ONLY |

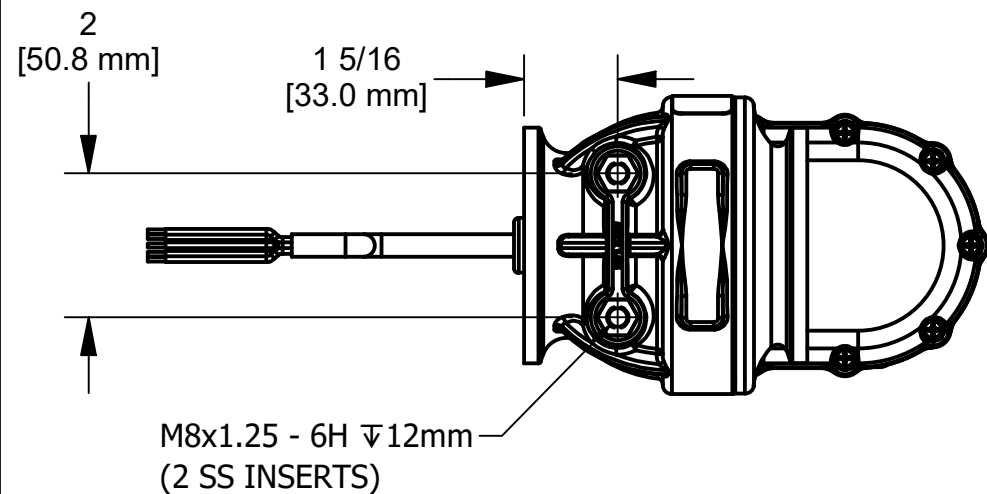
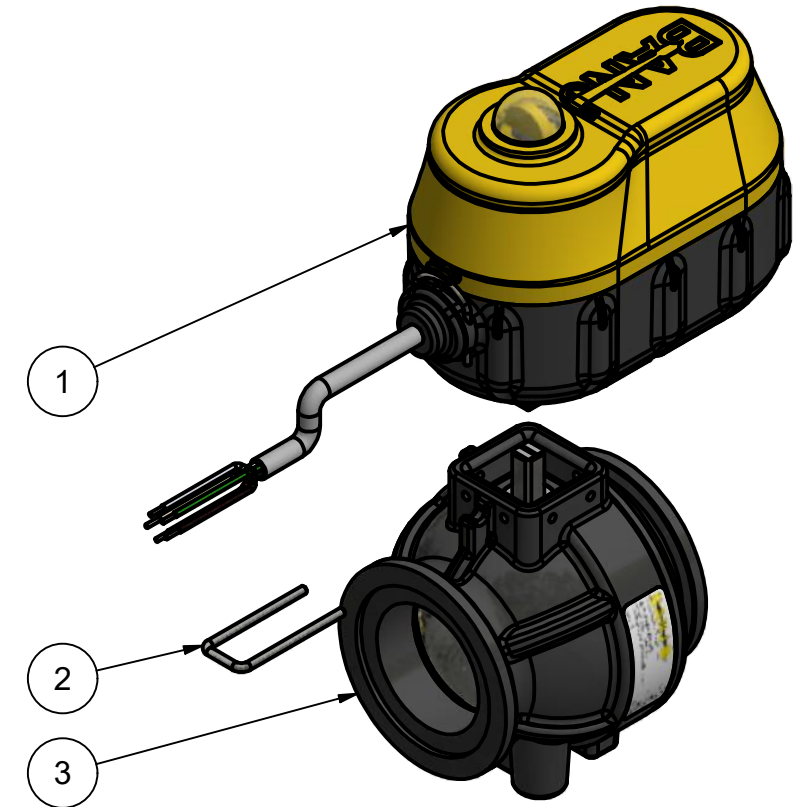
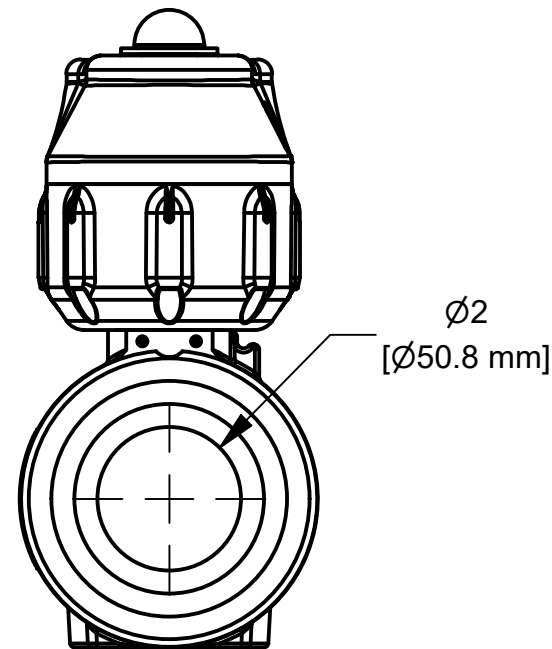
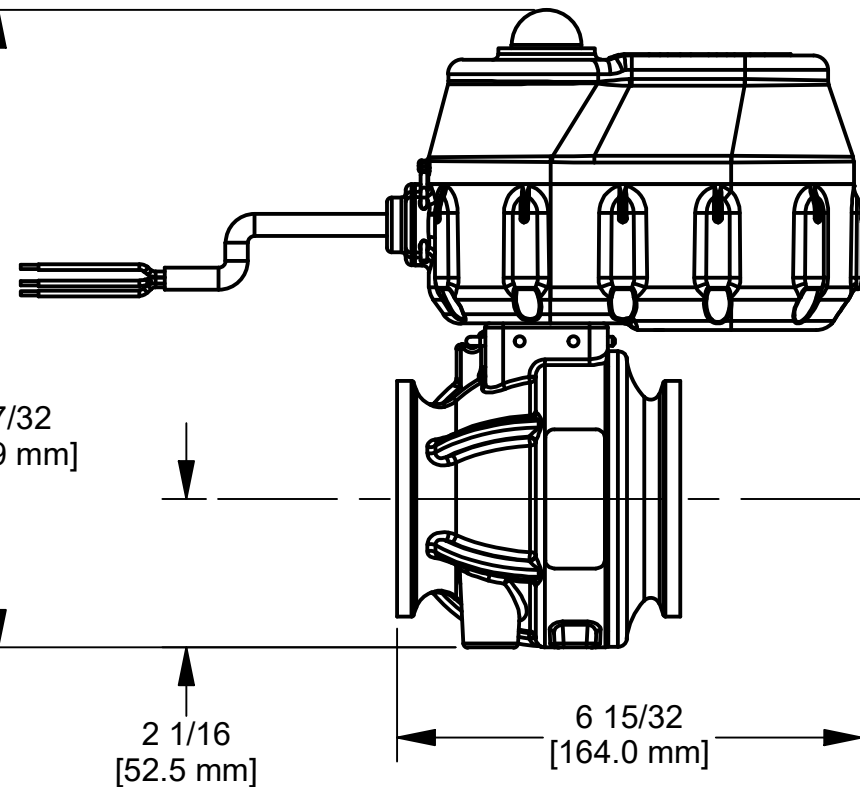

THIS DRAWING AND ALL INFORMATION CONTAINED THEREON ARE THE EXCLUSIVE PROPERTY OF BANJO CORPORATION.

UNLESS SPECIFICALLY NOTED, THIS DRAWING AND ITEMS SHOWN ON THIS DRAWING ARE SUBJECT TO CHANGE AT ANY TIME.



BANJO CORPORATION
 150 BANJO DRIVE, CRAWFORDSVILLE, IN 47933
 WEB SITE: WWW.BANJOCORP.COM
 E-MAIL: BANJOSALES@IDEXCORP.COM

DESCRIPTION
 MEVX 2"FP 1.5S WWC 5W 24V O/C VFY
 PART NUMBER
 MEVX22024F3