

4

3

2

1

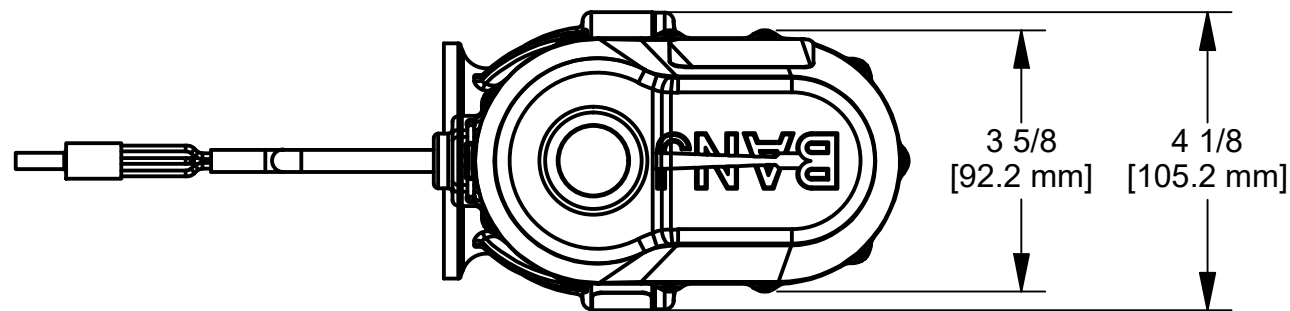

NOTES:

CABLE LENGTH: 18" ±1" FROM HOUSING.

WIRING:

PIN A - BLACK = GND  
 PIN B - WHITE = +12VDC (OPEN), 0VDC (CLOSE)  
 PIN C - RED = +12VDC

Parts List			
ITEM	QTY	PART NUMBER	DESCRIPTION
1	1	EP31B10310	EVX ACT 1.5S WWC 3W
2	1	EVP20001	EV U-PIN
3	1	MEVX220HX	MEVX 2"FP STUBBY VALVE ONLY
4	3	VE001	CABLE SEAL
5	1	VE009	3 TERMINAL MALE TOWER
6	3	VE010	FEMALE TERMINAL

B

B

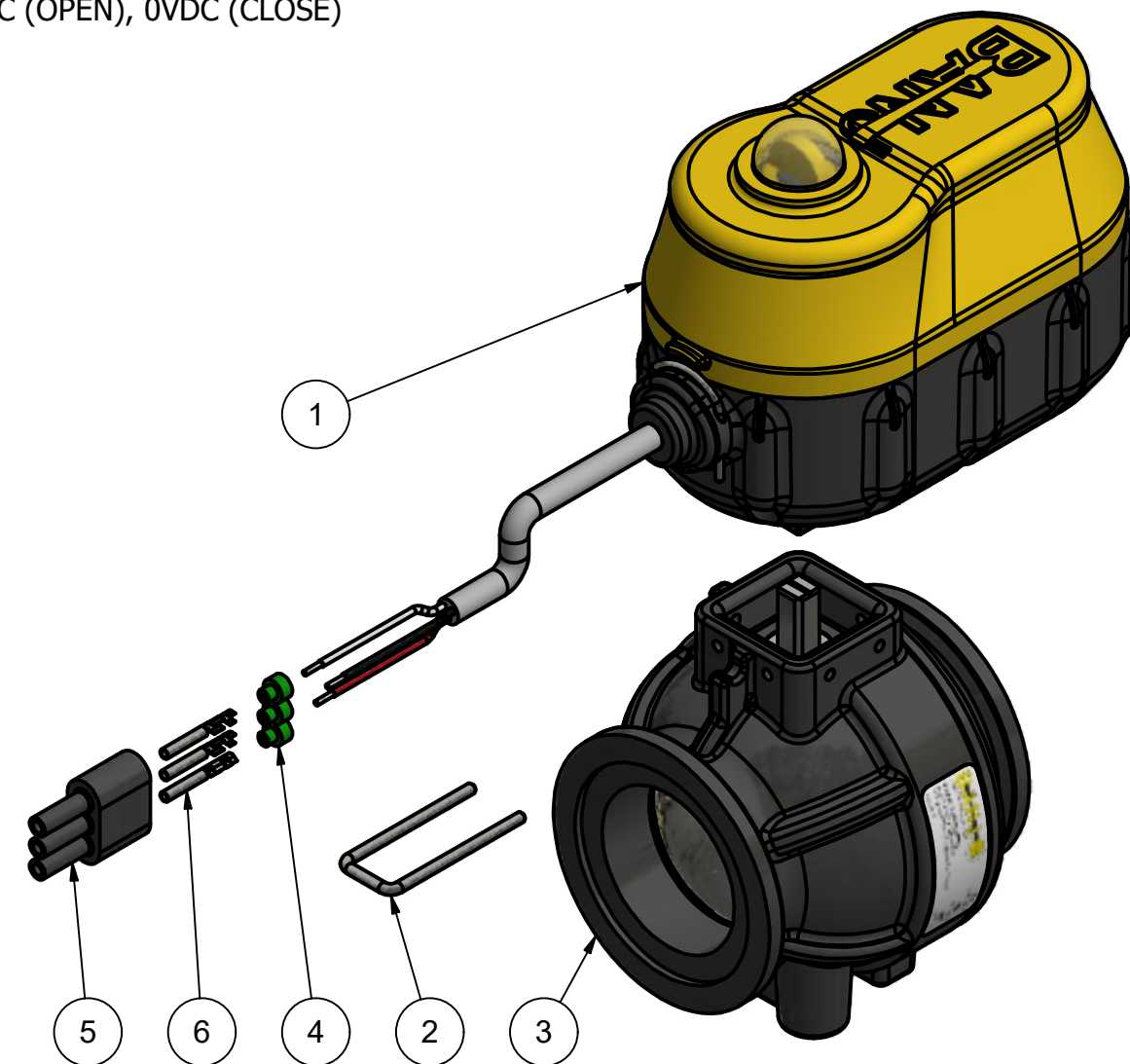
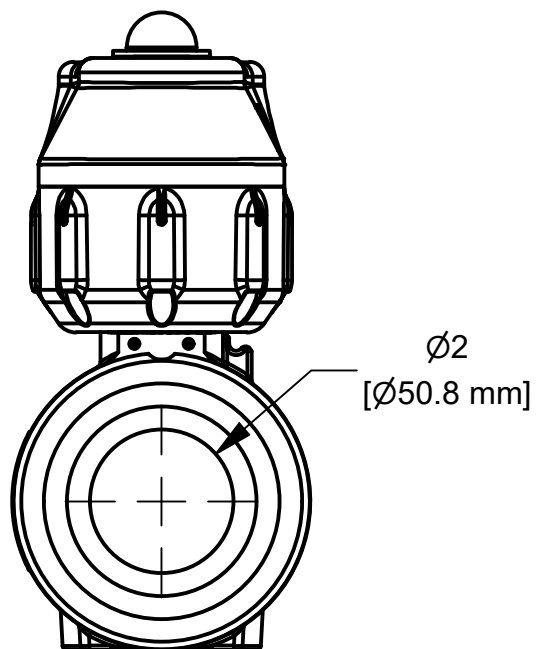
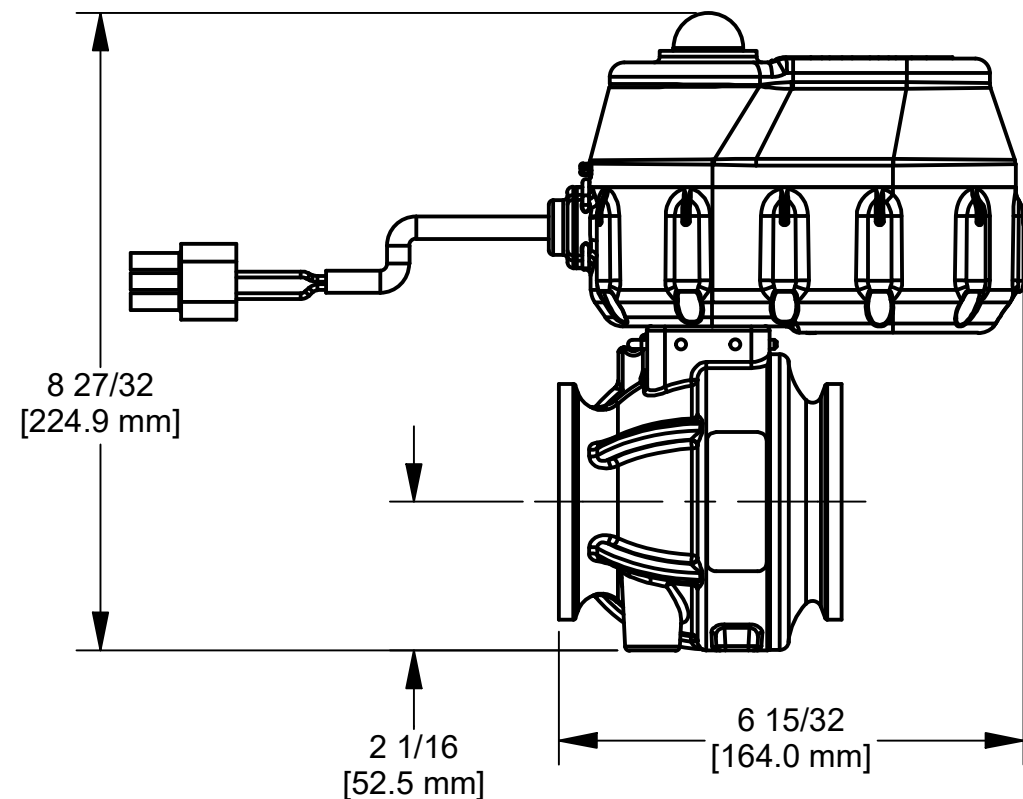

A

A

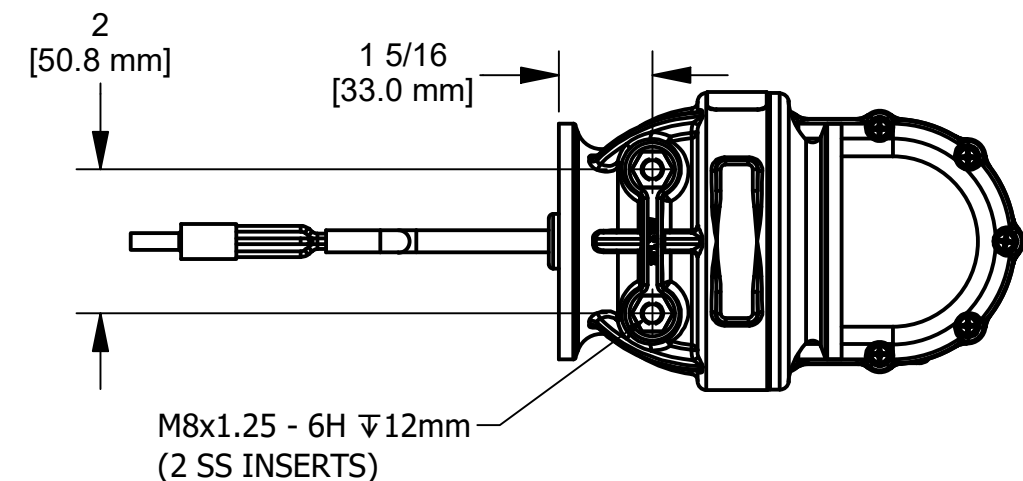

THIS DRAWING AND ALL INFORMATION CONTAINED THEREON ARE THE EXCLUSIVE PROPERTY OF BANJO CORPORATION.

UNLESS SPECIFICALLY NOTED, THIS DRAWING AND ITEMS SHOWN ON THIS DRAWING ARE SUBJECT TO CHANGE AT ANY TIME.



**BANJO CORPORATION**  
 150 BANJO DRIVE, CRAWFORDSVILLE, IN 47933  
 WEB SITE: WWW.BANJOCORP.COM  
 E-MAIL: BANJOSALES@IDEXCORP.COM

DESCRIPTION  
 MEVX 2"FP 1.5S WWC 3W ABBWCR

PART NUMBER  
 MEVX220A

4

3

2

1