

NOTES:
 WIRING:
 PIN A - RED = +12VDC
 PIN B - BLACK = GND
 PIN C - WHITE = +12VDC (OPEN), 0VDC (CLOSE)
 WIRE LENGTH: 18" ±1" FROM HOUSING
 CONNECTOR: DEUTSCH DT04-3P

Parts List			
ITEM	QTY	PART NUMBER	DESCRIPTION
1	1	EP31B10310	EVX ACT 1.5S WWC 3W
2	1	EVP20001	EV U-PIN
3	1	MEVX220HX	MEVX 2"FP STUBBY VALVE ONLY
4	3	VE018	Deutsch Pin SZ 16-18 AWG
5	1	VE019	DEUTSCH IPD 3 WAY RECEPT DT SERIES
6	1	VE020	Deutsch DT Wedgelock W3P

*TO PURCHASE ACTUATOR ONLY WITH CONNECTOR:
 PART NUMBER IS: [EP31B10310C10](#)

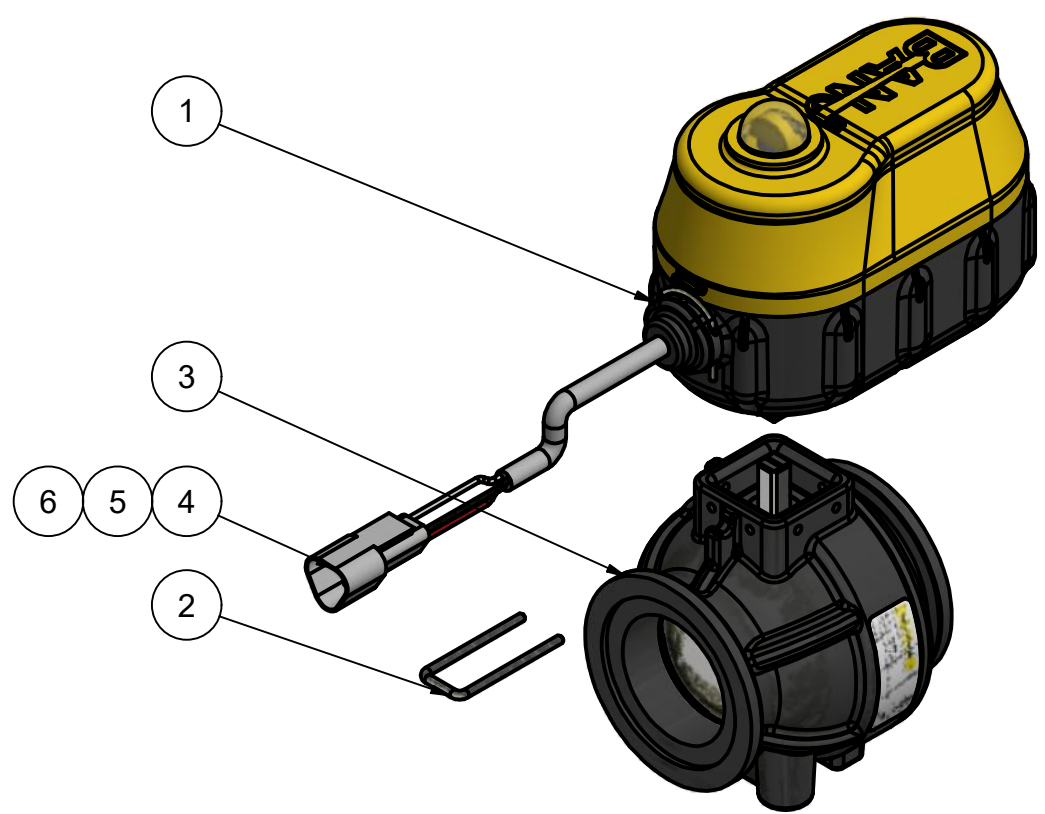
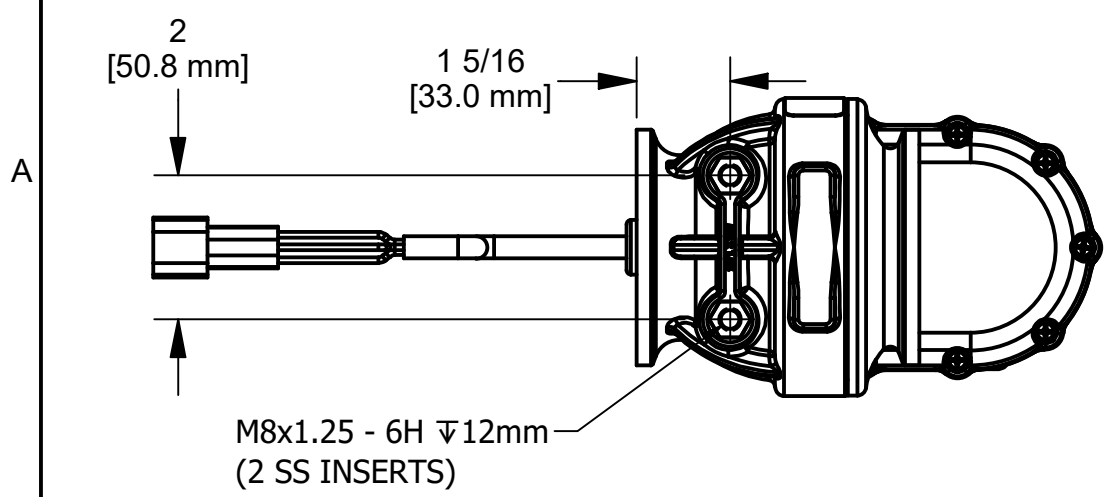
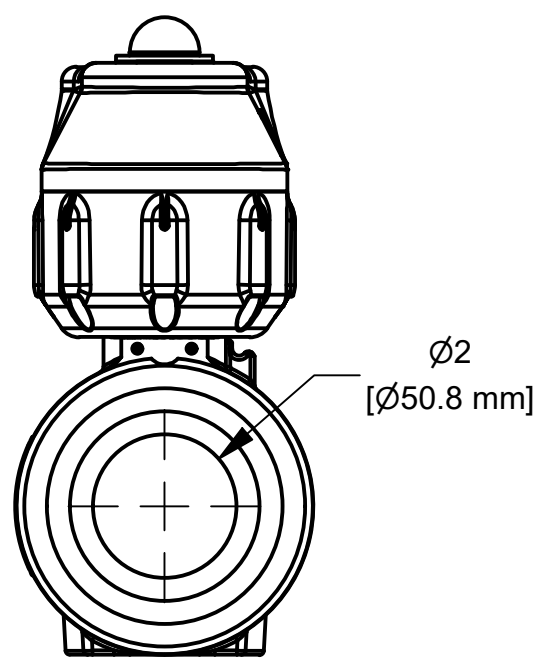
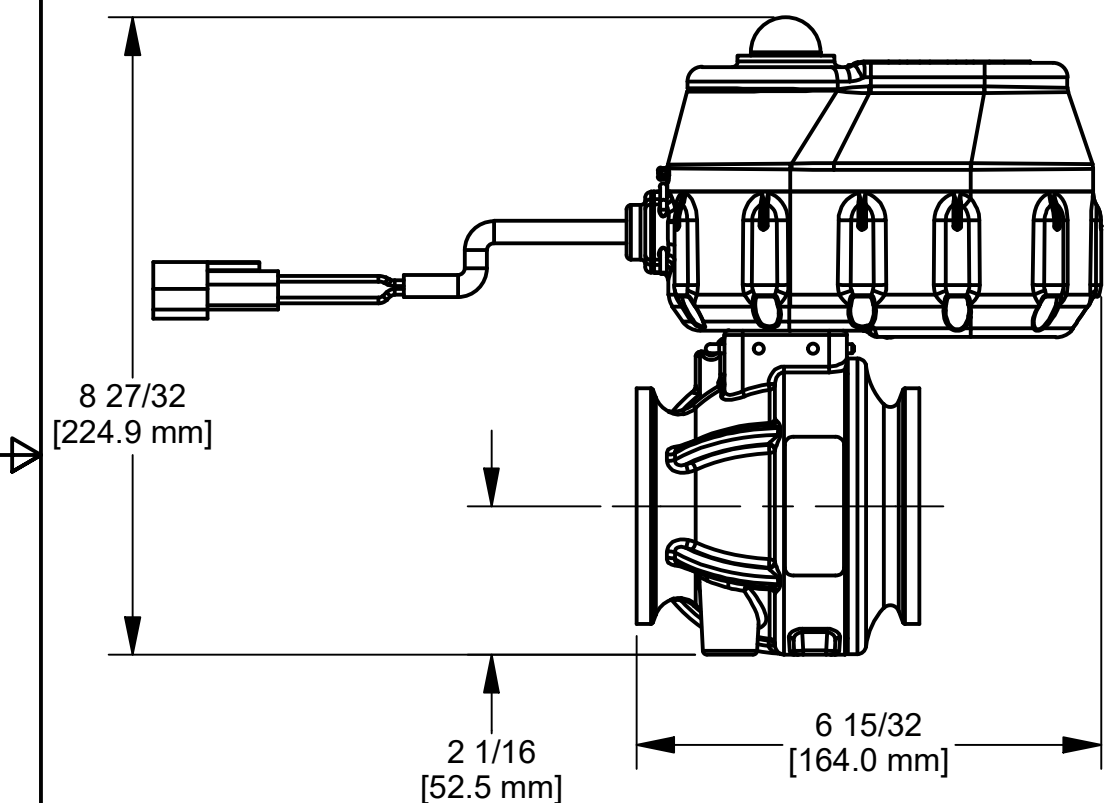

THIS DRAWING AND ALL INFORMATION CONTAINED THEREON ARE THE EXCLUSIVE PROPERTY OF BANJO CORPORATION.
 UNLESS SPECIFICALLY NOTED, THIS DRAWING AND ITEMS SHOWN ON THIS DRAWING ARE SUBJECT TO CHANGE AT ANY TIME.

BANJO CORPORATION
 150 BANJO DRIVE, CRAWFORDSVILLE, IN 47933
 WEB SITE: WWW.BANJOCORP.COM
 E-MAIL: BANJOSALES@IDEXCORP.COM

DESCRIPTION
 MEVX 2"FP 1.5S WWC ARBBCW

PART NUMBER
 MEVX220C