

NOTES:

CABLE LENGTH: 18" ± 1" FROM HOUSING

WIRING:
 PIN 1: WHITE = +12VDC (OPEN), 0VDC (CLOSE)
 PIN 2: BLACK = GND
 PIN 3: GREEN = +12VDC FEEDBACK (OPEN)
 PIN 4: RED = +12VDC

CONNECTOR: DEUTSCH DT04-4P

Parts List			
ITEM	QTY	PART NUMBER	DESCRIPTION
1	1	EP31B20411D	EVX ACT L2 1.5S WWC OPEN VERIFY 1W2B3G4R, 90° OFFSET
2	1	EVP20001	EV U-PIN
3	1	MEVX220HX	2" FP MEVX VALVE ONLY

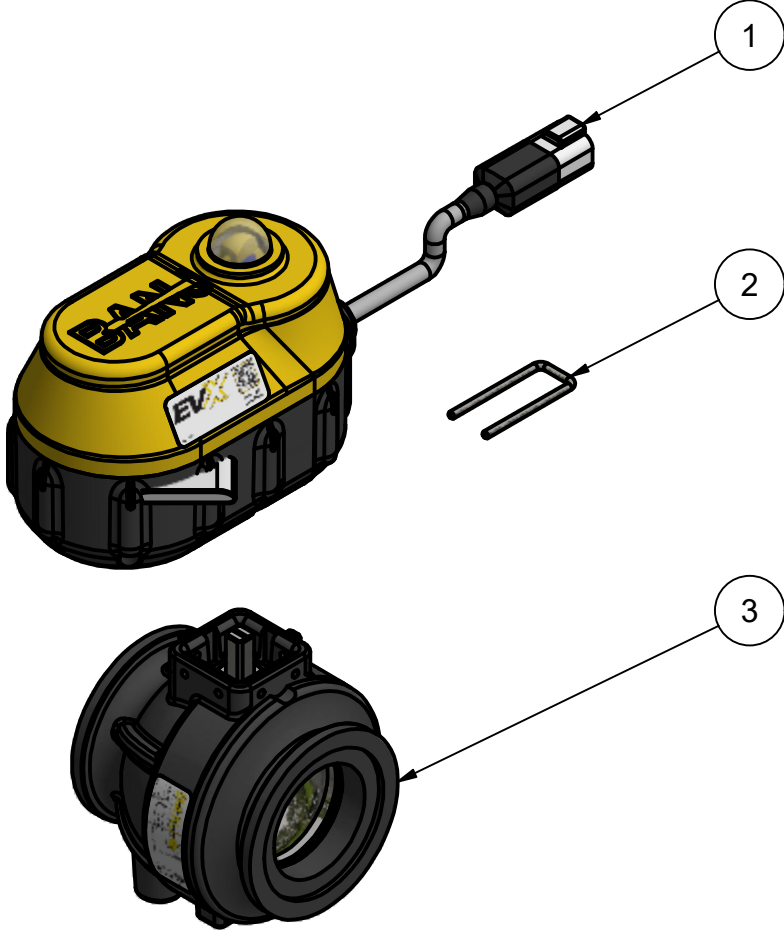

THIS DRAWING AND ALL INFORMATION CONTAINED THEREON ARE THE EXCLUSIVE PROPERTY OF BANJO CORPORATION.

UNLESS SPECIFICALLY NOTED, THIS DRAWING AND ITEMS SHOWN ON THIS DRAWING ARE SUBJECT TO CHANGE AT ANY TIME.

BANJO CORPORATION

150 BANJO DRIVE, CRAWFORDSVILLE, IN 47933
 WEB SITE: WWW.BANJOCORP.COM
 E-MAIL: BANJOSALES@IDEXCORP.COM

DESCRIPTION
MEVX 2" FP 1.5S OPEN VERIFY 4W

PART NUMBER
MEVX220F1B