

4

3

2

1

Parts List			
ITEM	QTY	PART NUMBER	DESCRIPTION
1	1	EP31B10513	EVX ACT 1.5S WWC 5W OP/CL-VFY
2	1	EVP20001	EV U-PIN
3	1	MEVX220HX	MEVX 2"FP STUBBY VALVE ONLY

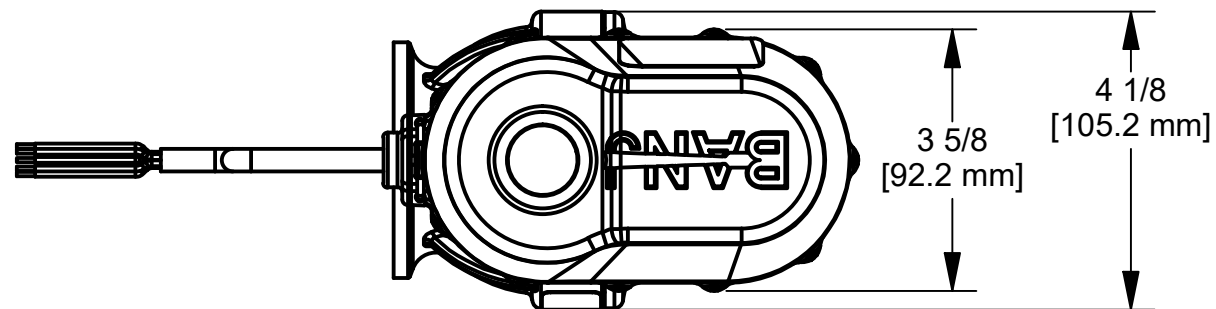

WIRING:
 RED = +12VDC
 BLACK = GND
 WHITE = +12VDC (OPEN), 0VDC (CLOSE)
 GREEN = +12VDC FEEDBACK (OPEN)
 BROWN = +12VDC FEEDBACK (CLOSED)

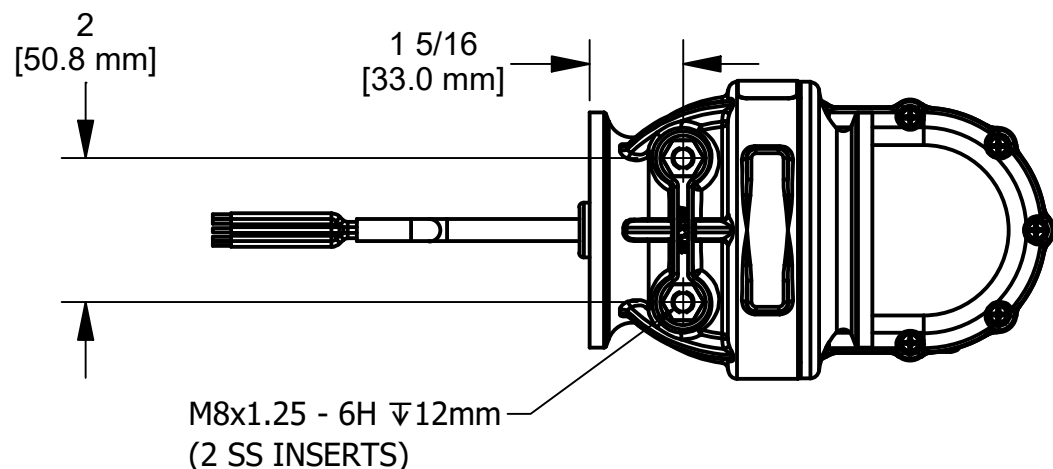
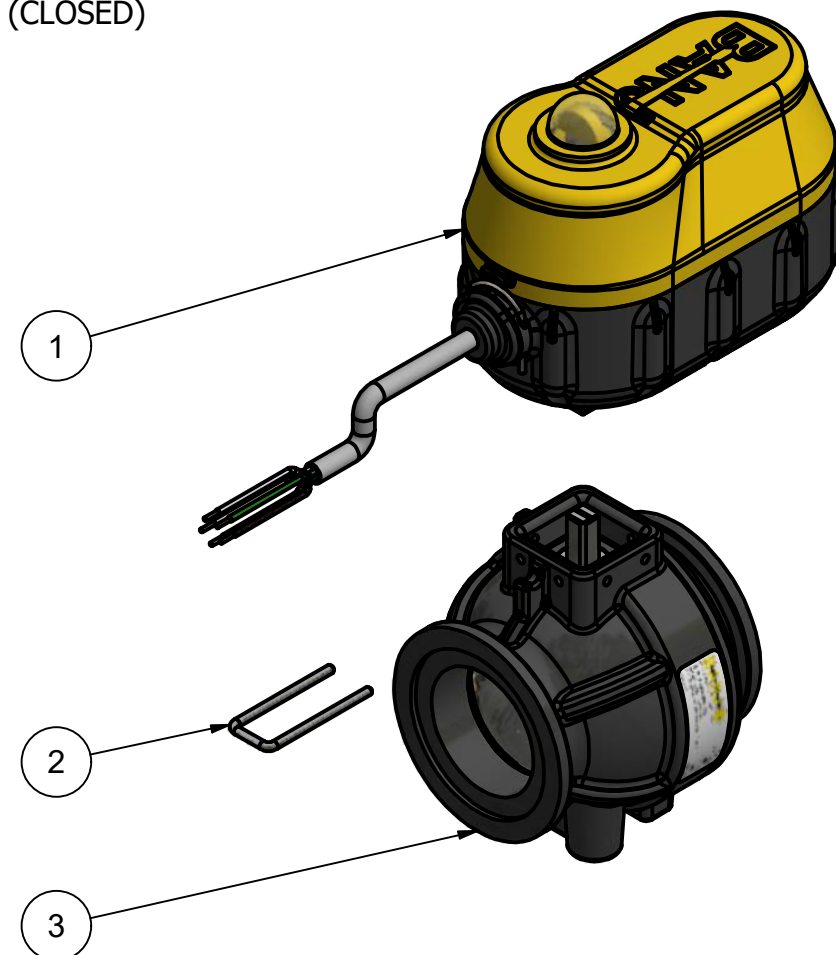
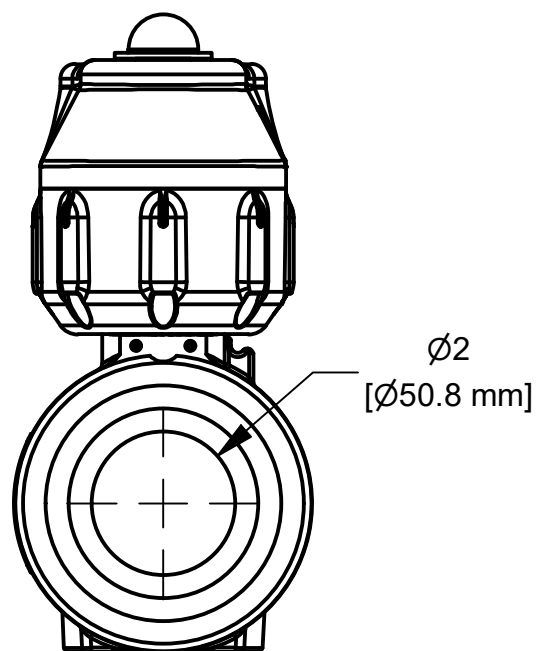
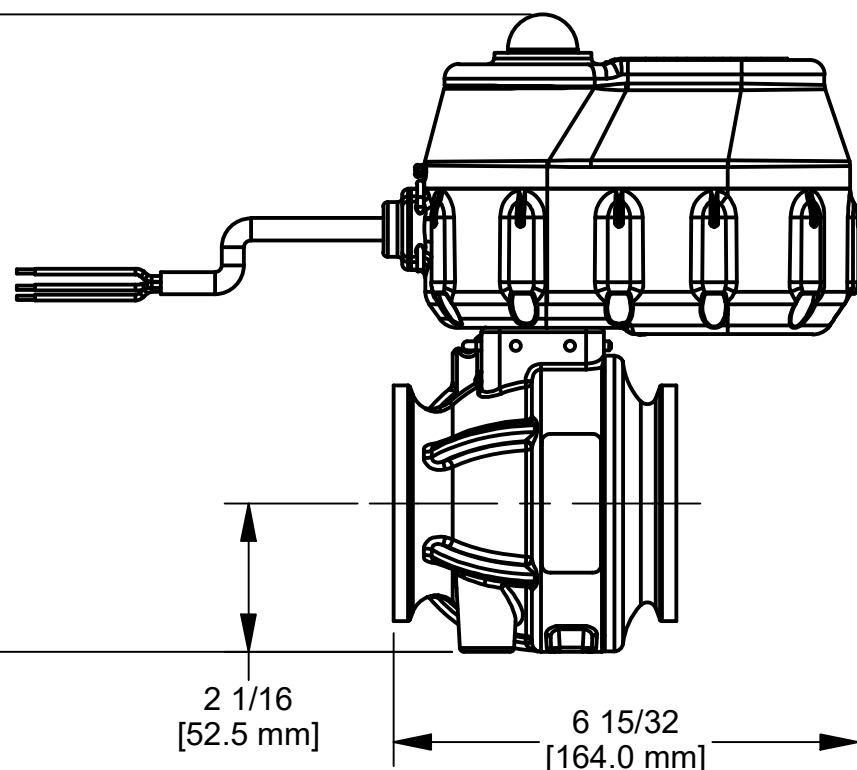

THIS DRAWING AND ALL INFORMATION CONTAINED THEREON ARE THE EXCLUSIVE PROPERTY OF BANJO CORPORATION.
 UNLESS SPECIFICALLY NOTED, THIS DRAWING AND ITEMS SHOWN ON THIS DRAWING ARE SUBJECT TO CHANGE AT ANY TIME.

BANJO CORPORATION
 BANJO CORPORATION
 150 BANJO DRIVE, CRAWFORDSVILLE, IN 47933
 WEB SITE: WWW.BANJOCORP.COM
 E-MAIL: BANJOSALES@IDEXCORP.COM
 DESCRIPTION
 MEVX 2"FP 1.5S WWC 5W OPEN/CLOSE VERIFY
 PART NUMBER
 MEVX220F3

4

3

2

1