

PARTS LIST			
ITEM	QTY	PART NUMBER	DESCRIPTION
1	1	EP31B10513A	EVX ACT 1.5S WWC 5W OP/CL-VFY, 180° ROTATION
2	1	EVP20001	EV U-PIN
3	1	MEVX221BLX	2" FP BL EVX 2-HOLE BALL VALVE

NOTES:

WIRING:

- RED = +12VDC
- BLACK = GND
- WHITE = +12VDC (OPEN @ PORT 1), 0VDC (OPEN @ PORT 2)
- GREEN = +12VDC FEEDBACK (OPEN - PORT 1)
- BROWN = +12VDC FEEDBACK (OPEN - PORT 2)

WIRE LENGTH: 18" ± 1"

3S TOTAL TIME FROM OPEN @ PORT 1 TO OPEN @ PORT 2.

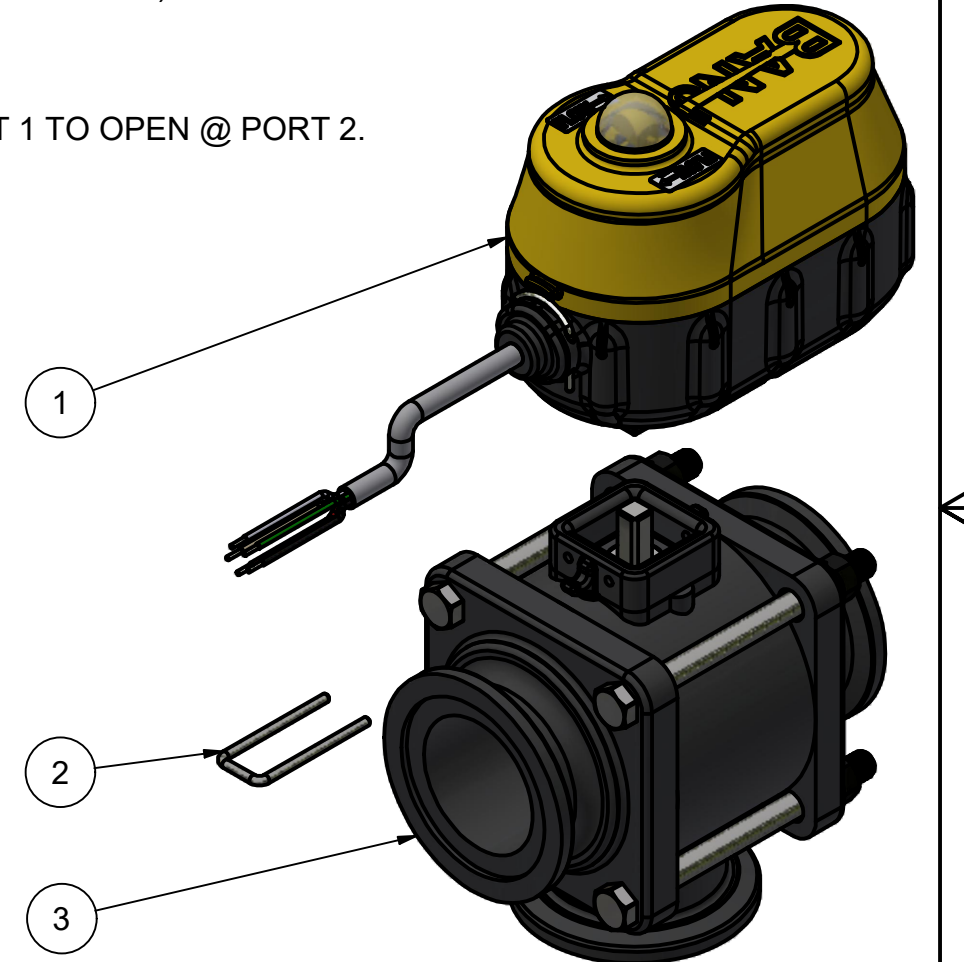

THIS DRAWING AND ALL INFORMATION CONTAINED THEREON ARE THE EXCLUSIVE PROPERTY OF BANJO CORPORATION.

UNLESS SPECIFICALLY NOTED, THIS DRAWING AND ITEMS SHOWN ON THIS DRAWING ARE SUBJECT TO CHANGE AT ANY TIME.

**BANJO CORPORATION**

BANJO CORPORATION  
 150 BANJO DRIVE, CRAWFORDSVILLE, IN 47933  
 WEB SITE: WWW.BANJOCORP.COM  
 E-MAIL: BANJOSALES@IDEXCORP.COM

DESCRIPTION  
 MEVX 2"FP 3S WWC 5W OP/CL VERIFY, 180° ROTATION

PART NUMBER  
 MEVX221BLF3