

4

3

2

1

Parts List

ITEM	QTY	PART NUMBER	DESCRIPTION
1	1	EP61C10513	EVX ACT 4S WWC 5W OPEN/CLOSE VERIFY
2	1	EVP30001	EV U-PIN
3	1	MEVX300HX	3" FP MEVX, VALVE ONLY

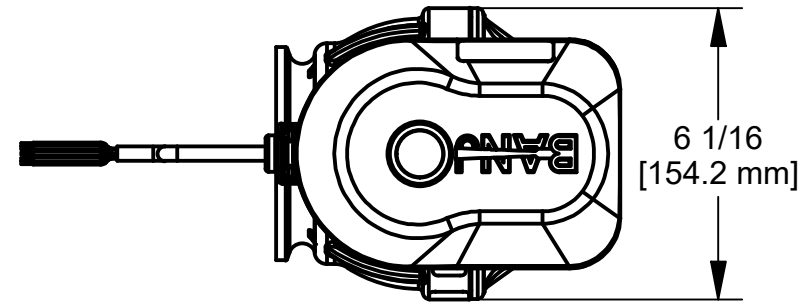

WIRING:
 RED = +12VDC
 BLACK = GND
 WHITE = +12VDC (OPEN), 0VDC (CLOSE)
 GREEN = +12VDC FEEDBACK (OPEN)
 BROWN = +12VDC FEEDBACK (CLOSED)

WIRE LENGTH: 18" ± 1" FROM HOUSING

B

B

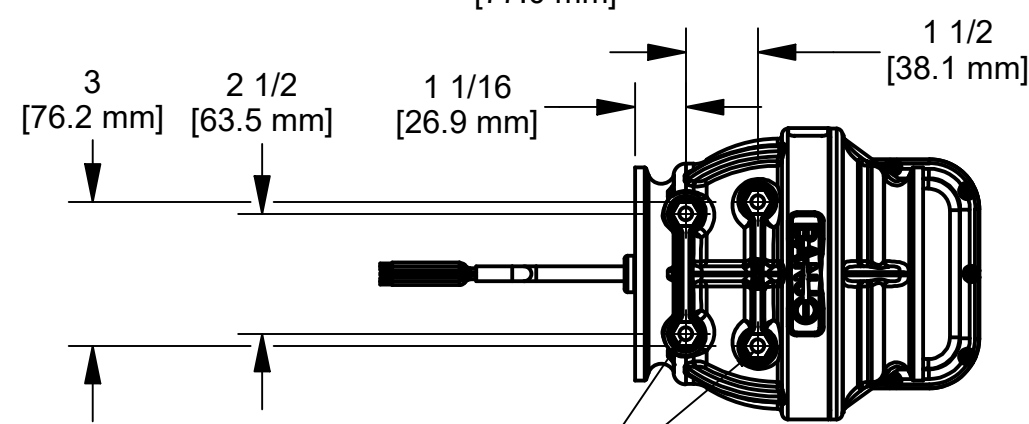
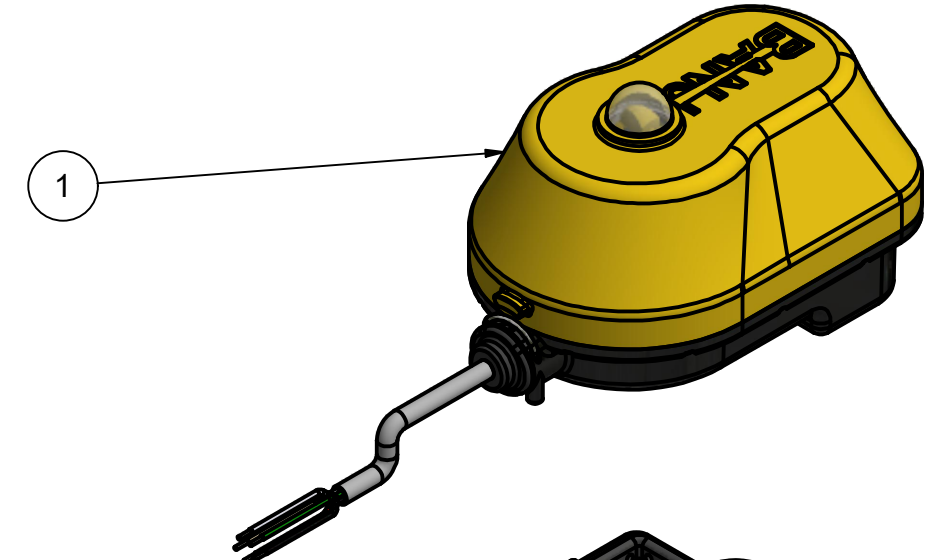
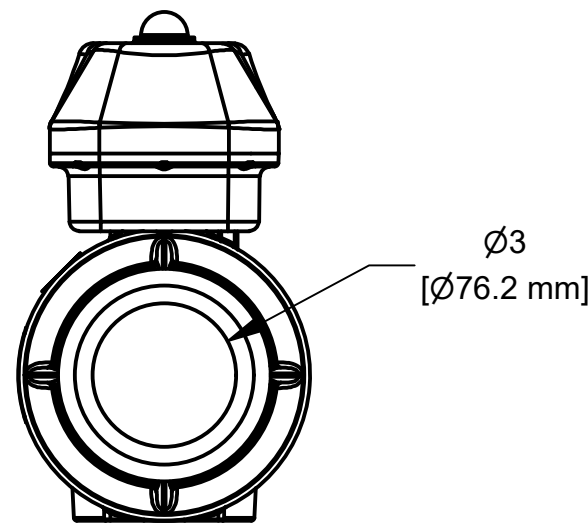
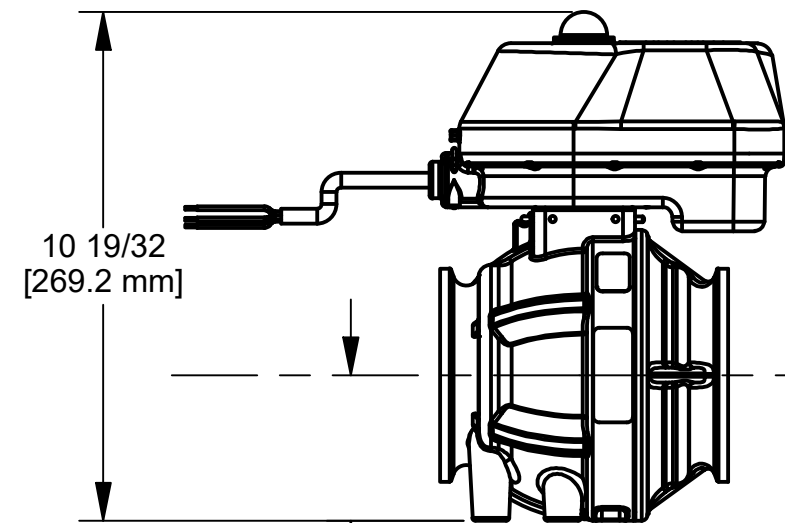

M8 x 1.25 - 6H x12mm
(4 SS INSERTS)

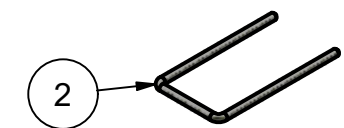

A

A

4

3

2

1

THIS DRAWING AND ALL INFORMATION CONTAINED THEREON ARE THE EXCLUSIVE PROPERTY OF BANJO CORPORATION.

UNLESS SPECIFICALLY NOTED, THIS DRAWING AND ITEMS SHOWN ON THIS DRAWING ARE SUBJECT TO CHANGE AT ANY TIME.



BANJO CORPORATION
 150 BANJO DRIVE, CRAWFORDSVILLE, IN 47933
 WEB SITE: WWW.BANJOCORP.COM
 E-MAIL: BANJOSALES@IDEXCORP.COM

DESCRIPTION
 MEVX 3"FP 4S WWC 5W OPEN/CLOSE VERIFY

PART NUMBER
 MEVX300F3