

4

3

2

1

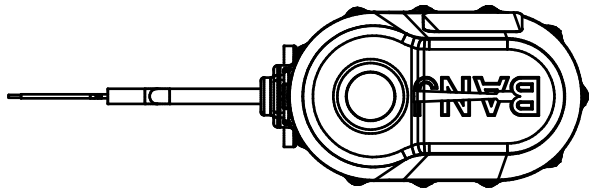

NOTES:

CABLE LENGTH: 18" ± 1" FROM HOUSING.

WIRING:

- RED = +12VDC (OPEN)
- BLACK = GND (OPEN)
- RED = GND (CLOSE)
- BLACK = +12VDC (CLOSE)

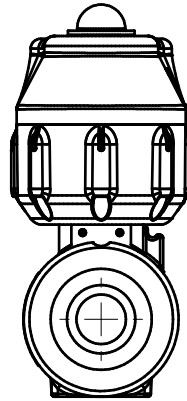
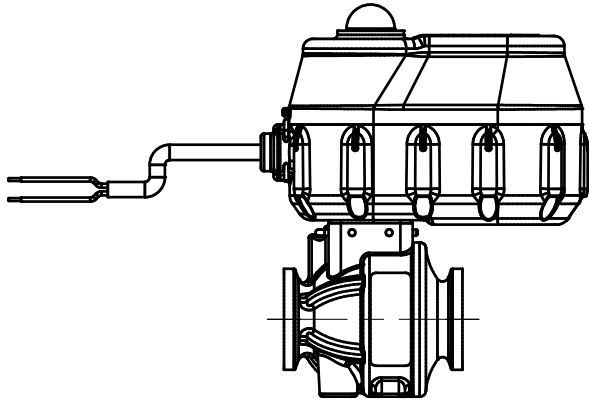

| Parts List | | | |
|------------|-----|-------------|-----------------------------|
| ITEM | QTY | PART NUMBER | DESCRIPTION |
| 1 | 1 | EP31C02210 | EVX ACT 4S 2W REG |
| 2 | 1 | EVP20001 | EV U-PIN |
| 3 | 1 | MEVX100HX | MEVX 1"FP STUBBY VALVE ONLY |

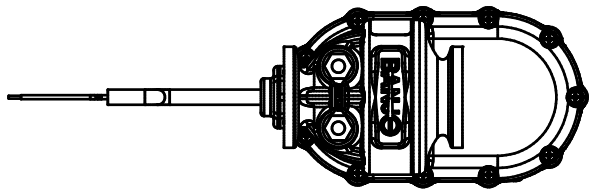
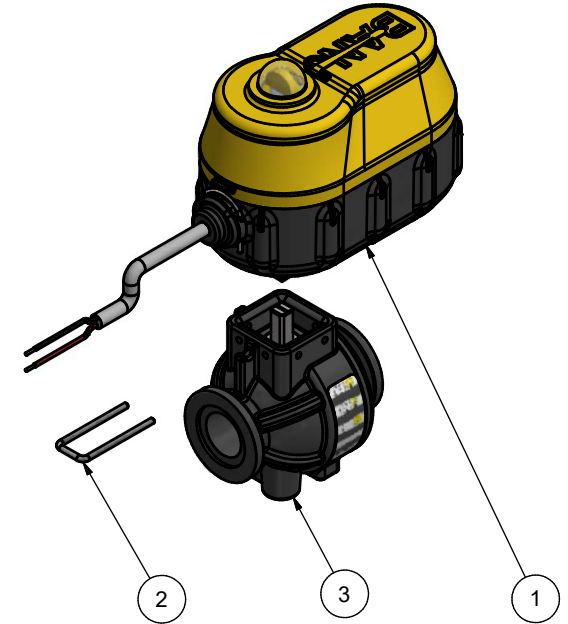

UNLESS OTHERWISE SPECIFIED
ALL DIMENSIONS ARE IN INCHES
GENERAL TOLERANCES:
MOLDED 0.01 = ±0.025 MACHINED/PURCHASED 0.00 = ±0.010
0.000 = ±0.010 0.000 = ±0.005
FRACTIONS 1/16 = ±1/32
ANGLES = ±5°
BREAK ALL SHOWN CORNERS W/ R1/32



BANJO CORPORATION
150 BANJO DRIVE, CRAWFORDSVILLE, IN 47933
DESCRIPTION
MEVX 1" 4S 2W REG

| NA | 00 | INITIAL RELEASE | 40471 | 09/28/20 | AMB |
|------------------|-----|-----------------|-------|----------|----------|
| ZONE | REV | DESCRIPTION | ECN | DATE | APPROVED |
| REVISION HISTORY | | | | | |

| | |
|----------------|------------|
| DRAWN AMB | 28/09/2020 |
| APPROVED | |
| PRINT REVIEWED | |
| MATERIAL | |
| FINISH | SCALE 3/8 |

| | | | | | |
|---------|----------------|----------|-----|--------------|----|
| DWG NO | MEVXR2W100.idw | DWG TYPE | ENG | REV | 00 |
| PART NO | MEVXR2W100 | SIZE | B | SHEET 1 OF 2 | |

4

3

2

1