

NOTES:

WIRING:

PIN C: RED = +12VDC (OPEN)
 PIN B: BLACK = GND (OPEN)
 RED = GND (CLOSE)
 BLACK = +12VDC (CLOSE)
 PIN A: PLUG

WIRE LENGTH: 18" ±1" FROM HOUSING.

Parts List			
ITEM	QTY	PART NUMBER	DESCRIPTION
1	1	EP31C02210	EVX ACT 4S 2W REG
2	1	EVP20001	EV U-PIN
3	1	MEVX101X	1" EVX 2-WAY BOLTED MANIFOLD VALVE
4	2	VE001	CABLE SEAL
5	1	VE005	CAVITY PLUG
6	1	VE009	3 TERMINAL MALE TOWER
7	2	VE010	FEMALE TERMINAL

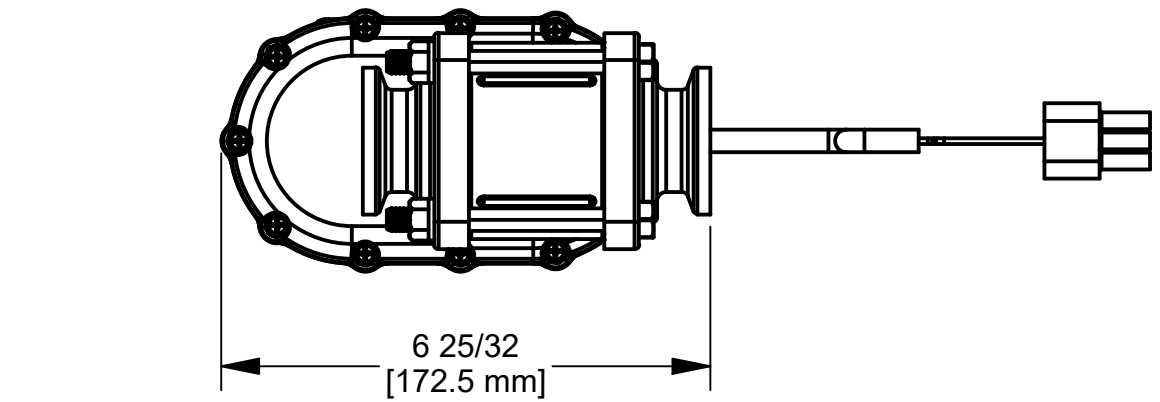
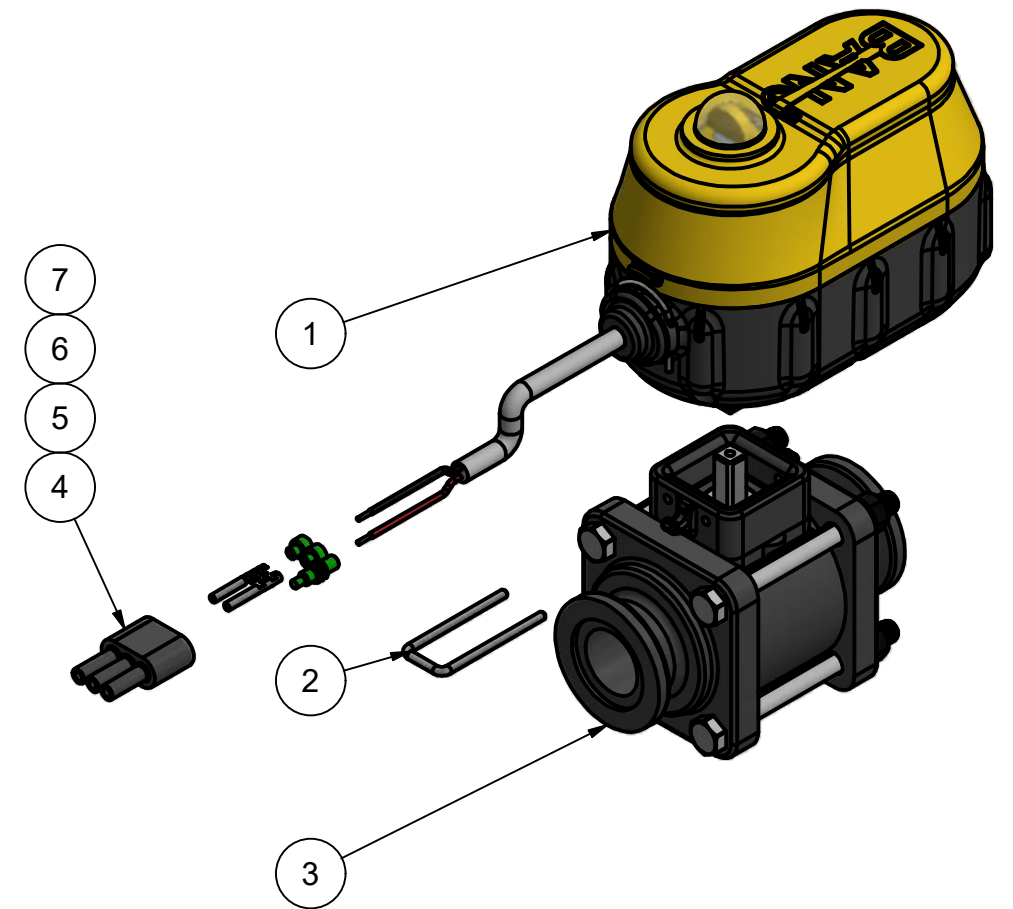
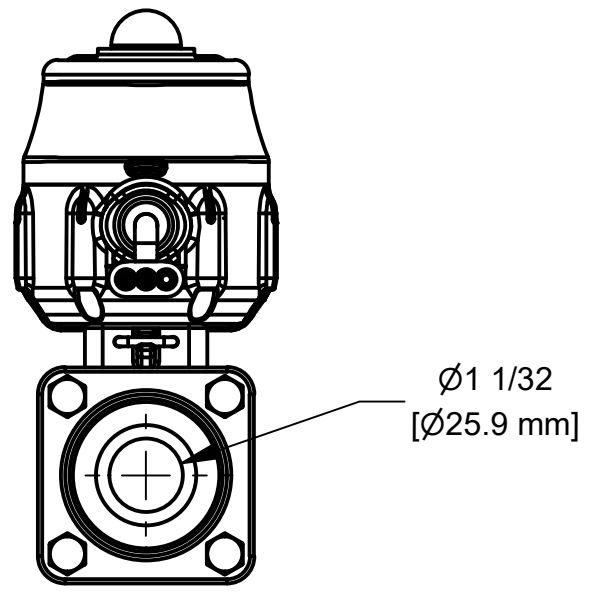
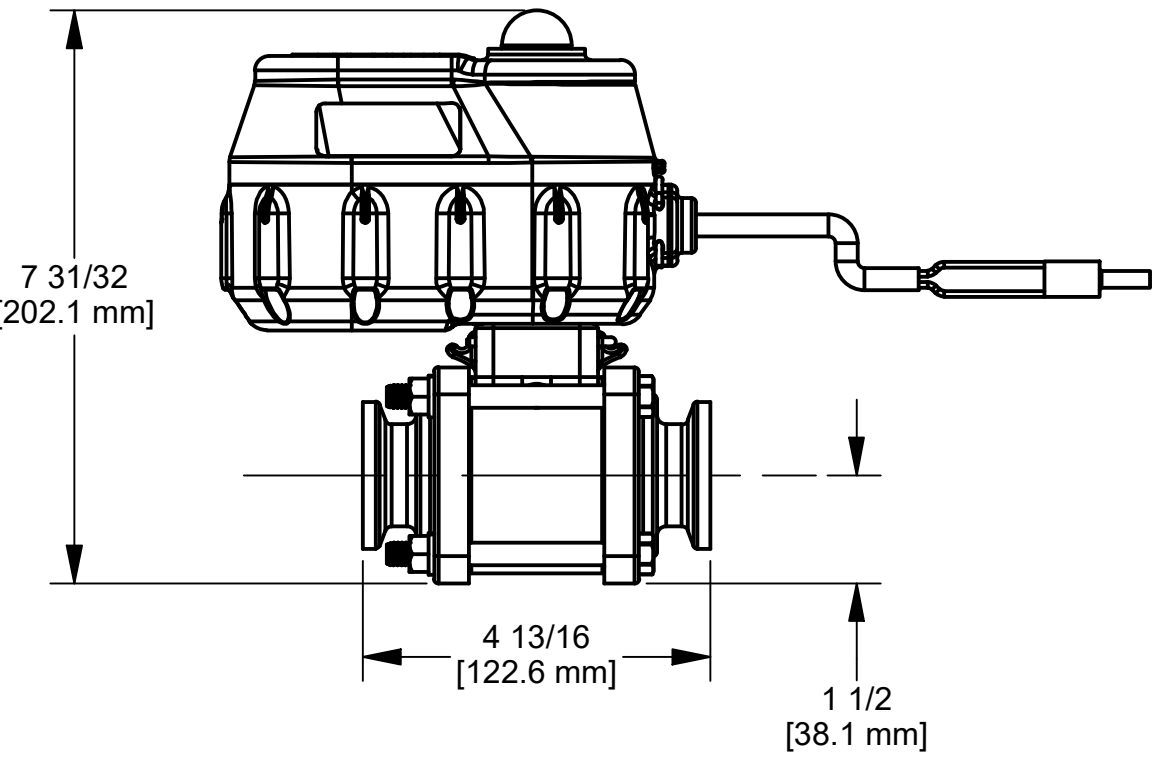

THIS DRAWING AND ALL INFORMATION CONTAINED THEREON ARE THE EXCLUSIVE PROPERTY OF BANJO CORPORATION.
 UNLESS SPECIFICALLY NOTED, THIS DRAWING AND ITEMS SHOWN ON THIS DRAWING ARE SUBJECT TO CHANGE AT ANY TIME.

BANJO CORPORATION

BANJO CORPORATION
 150 BANJO DRIVE, CRAWFORDSVILLE, IN 47933
 WEB SITE: WWW.BANJOCORP.COM
 E-MAIL: BANJOSALES@IDEXCORP.COM

DESCRIPTION	MEVX 1"FP 4S 2W REGULATING BOLTED APBBCR
PART NUMBER	MEVXR2W101A