

WIRING:
 RED = +12VDC (OPEN)
 BLACK = GND (OPEN)
 RED = GND (CLOSE)
 BLACK = +12VDC (CLOSE)

PIN A = BLACK
 PIN B = RED

WIRE LENGTH: 18" ± 1" FROM HOUSING

Parts List			
ITEM	QTY	PART NUMBER	DESCRIPTION
1	1	EP31C02210	EVX ACT 3S 2W REG
2	1	EVP20001	EV U-PIN
3	1	MEVX101X	1" EVX 2-WAY BOLTED MANIFOLD VALVE
4	2	VE001	CABLE SEAL
5	2	VE002	MALE TERMINAL
6	1	VE015	2 CONNECTOR FEMALE SHROUD

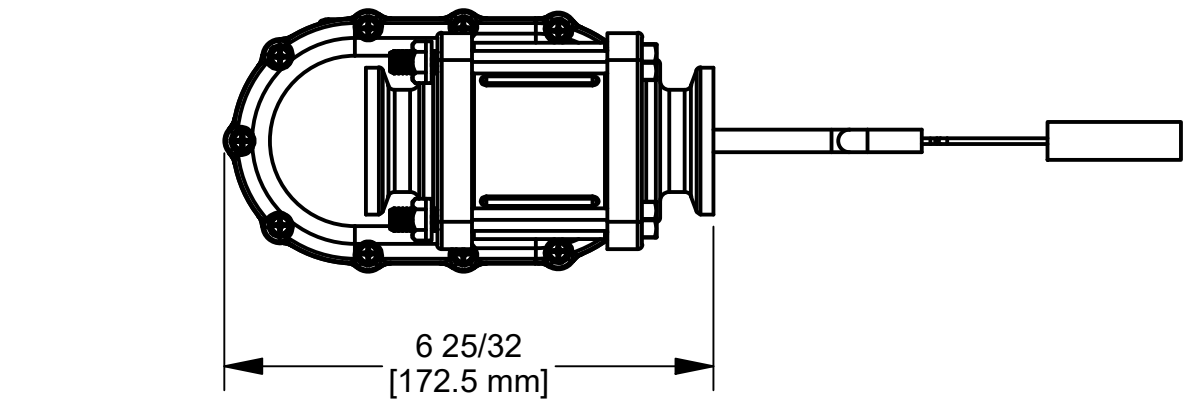
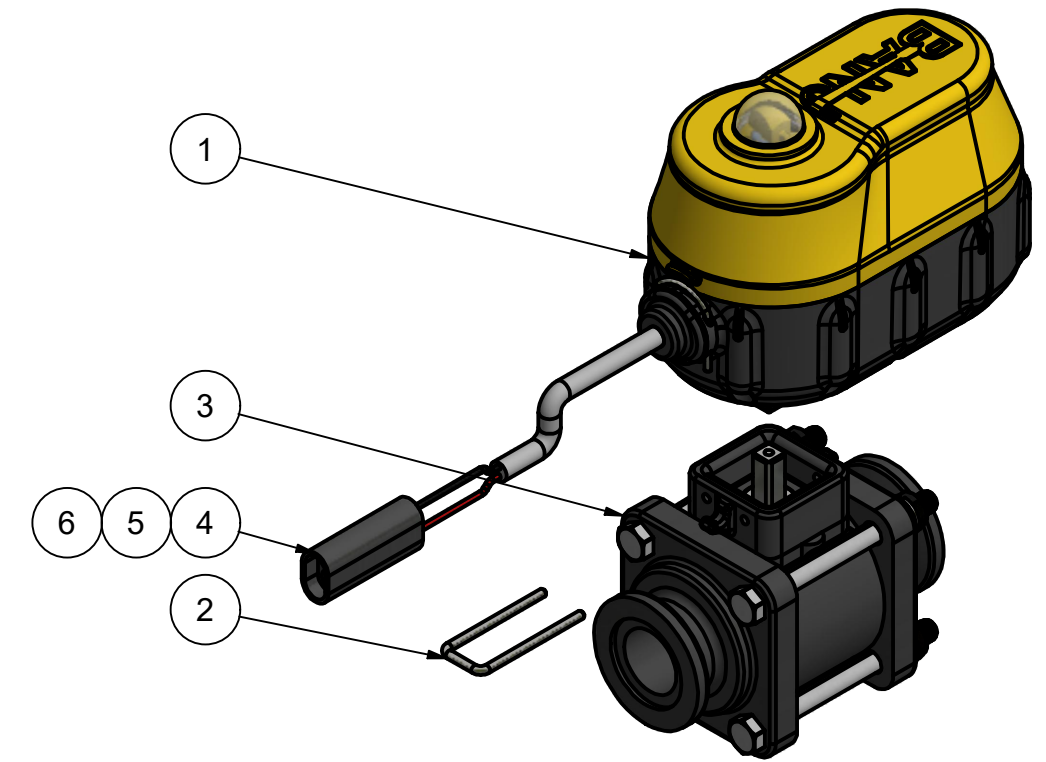
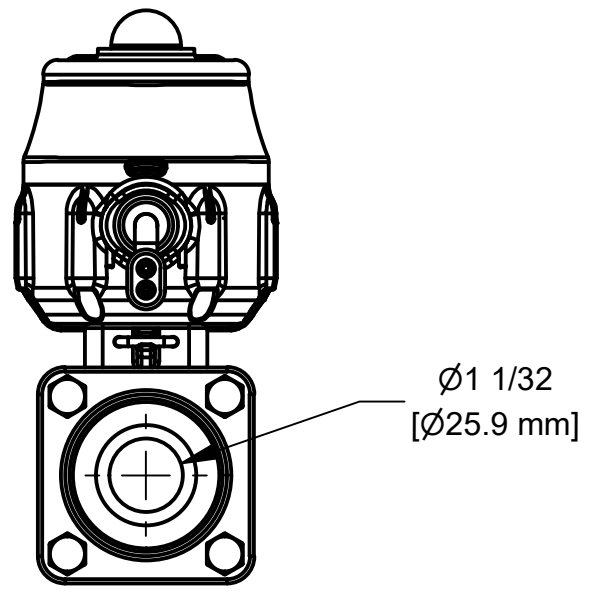
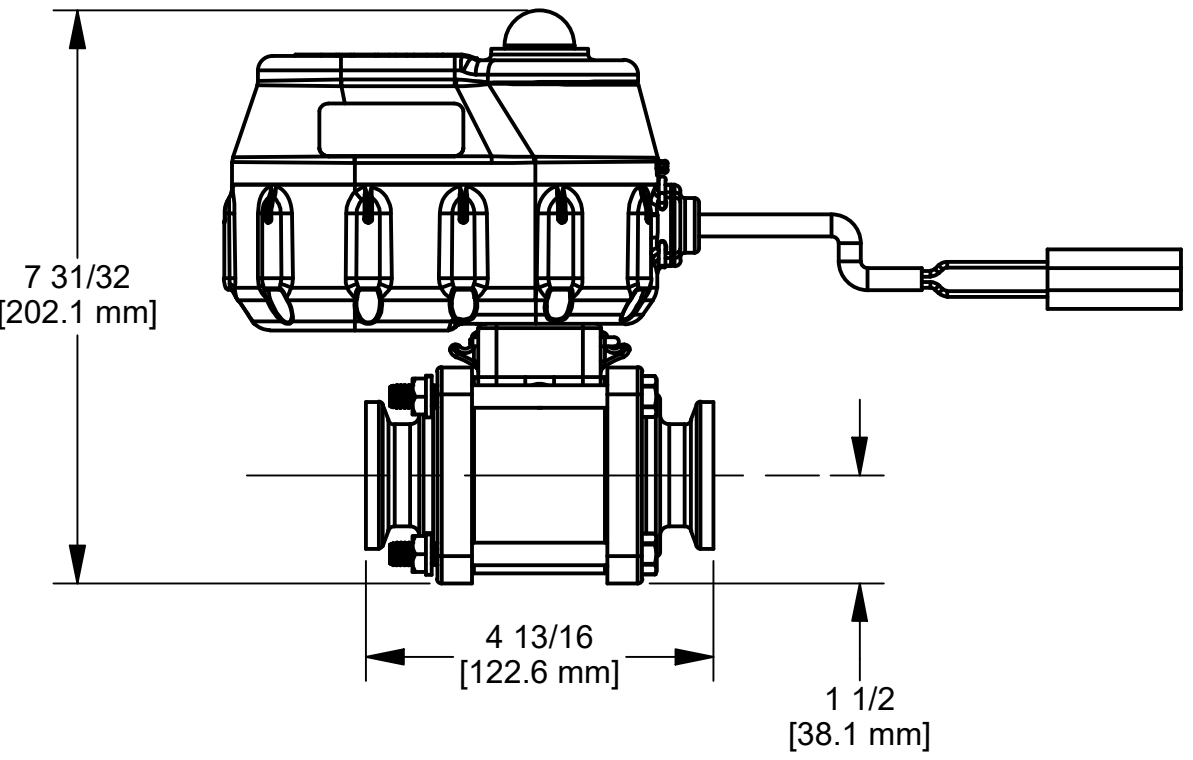

THIS DRAWING AND ALL INFORMATION CONTAINED THEREON ARE THE EXCLUSIVE PROPERTY OF BANJO CORPORATION.

UNLESS SPECIFICALLY NOTED, THIS DRAWING AND ITEMS SHOWN ON THIS DRAWING ARE SUBJECT TO CHANGE AT ANY TIME.

BANJO CORPORATION

BANJO CORPORATION
 150 BANJO DRIVE, CRAWFORDSVILLE, IN 47933
 WEB SITE: WWW.BANJOCORP.COM
 E-MAIL: BANJOSALES@IDEXCORP.COM

DESCRIPTION
 MEVX 1"FP 3S 2W REGULATING BOLTED ABBR

PART NUMBER
 MEVXR2W101C