

PARTS LIST			
ITEM	QTY	PART NUMBER	DESCRIPTION
1	1	EP31C82634	EVX ACT 3S REGULATING 6W LINEAR FEEDBACK 4-20MA
2	1	EVP20001	EV U-PIN
3	1	MEVX203X	MEVX 2" SP V-BALL BOLTED VALVE

**WIRING:**

**LOW CURRENT SIGNAL WIRES:**

RED = +12VDC (CCW)  
BLACK = +12VDC (CW)

**HIGH CURRENT MOTOR DRIVE:**

WHITE = GND  
ORANGE = +12VDC

**FEEDBACK:**

GREEN = 4-20mA (-) FEEDBACK  
BLUE = 4-20mA (+) FEEDBACK

**NOTE: IF POWER SUPPLIED TO RED/BLACK SIMULTANEOUSLY, NO ROTATION WILL OCCUR.**

PWM SIGNAL CAN BE APPLIED TO RED/BLACK WIRES

WIRE LENGTH: 18" ± 1"

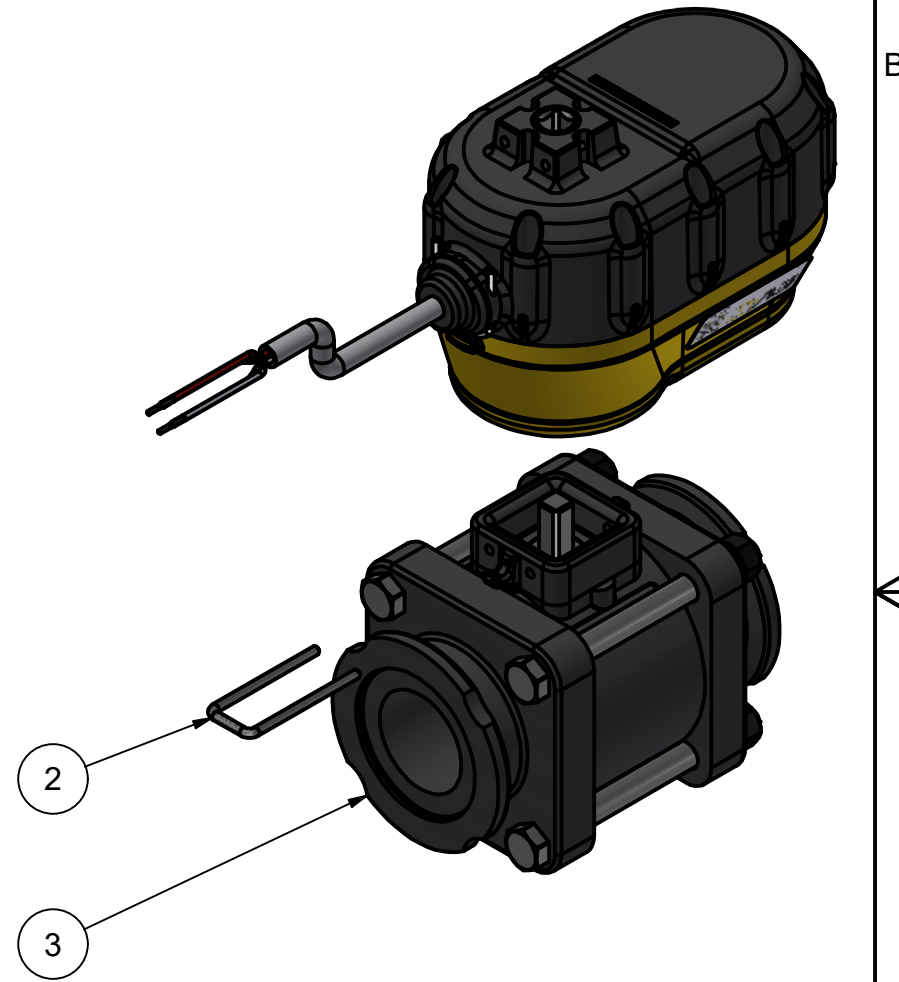

THIS DRAWING AND ALL INFORMATION CONTAINED THEREON ARE THE EXCLUSIVE PROPERTY OF BANJO CORPORATION.

UNLESS SPECIFICALLY NOTED, THIS DRAWING AND ITEMS SHOWN ON THIS DRAWING ARE SUBJECT TO CHANGE AT ANY TIME.

**BANJO CORPORATION**

150 BANJO DRIVE, CRAWFORDSVILLE, IN 47933  
WEB SITE: WWW.BANJOCORP.COM  
E-MAIL: BANJOSALES@IDEXCORP.COM

DESCRIPTION  
MEVX 2" 4S 2W REG 6W 4-20MA V-BALL

PART NUMBER  
MEVXR2W201F4B