

NOTES:  
 CABLE LENGTH: 18" ± 1" FROM HOUSING.  
 WIRING:  
 RED = +12VDC (OPEN)  
 BLACK = GND (OPEN)  
 RED = GND (CLOSE)  
 BLACK = +12VDC (CLOSE)

Parts List			
ITEM	QTY	PART NUMBER	DESCRIPTION
1	1	EP31C02210	EVX ACT 4S 2W REG
2	1	EVP20001	EV U-PIN
3	1	MEVX220HX	MEVX 2"FP STUBBY VALVE ONLY

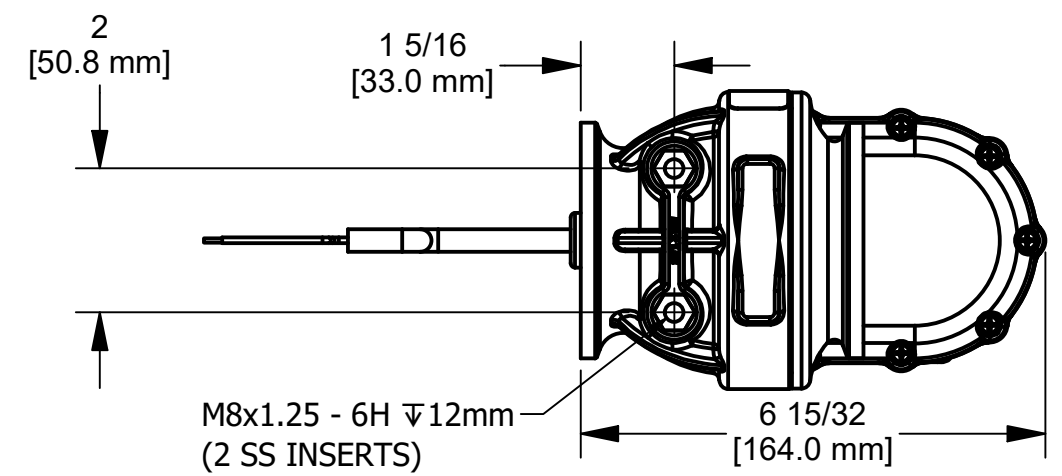
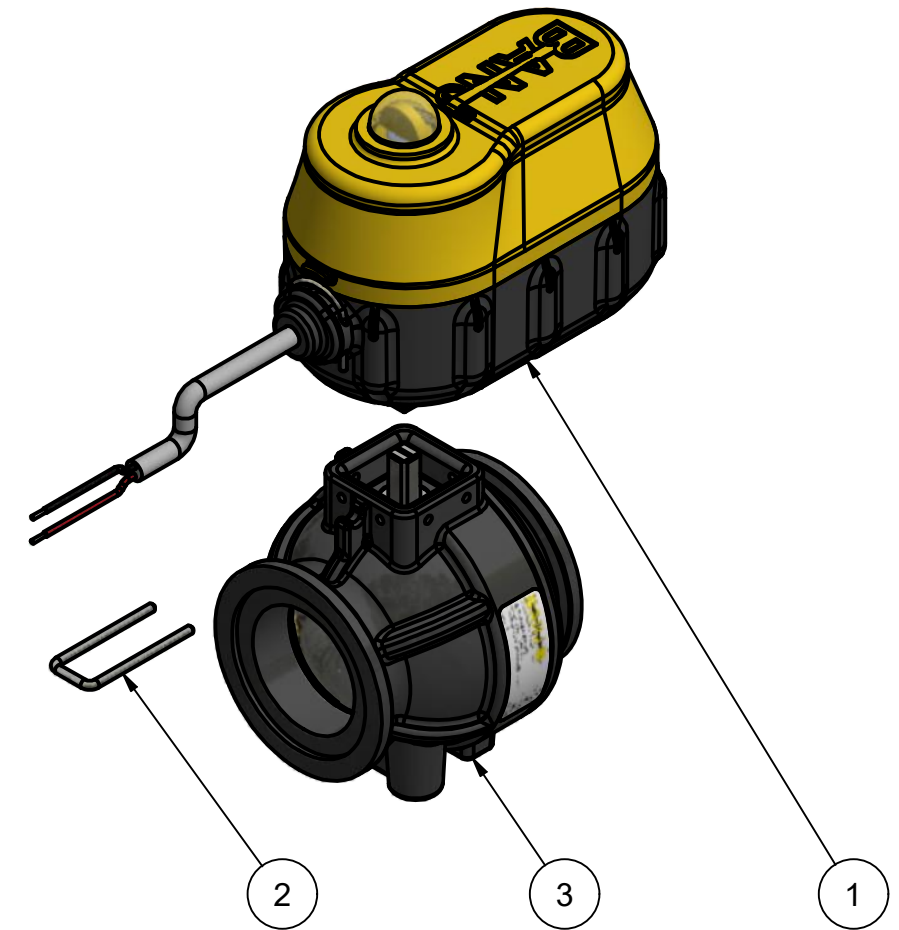
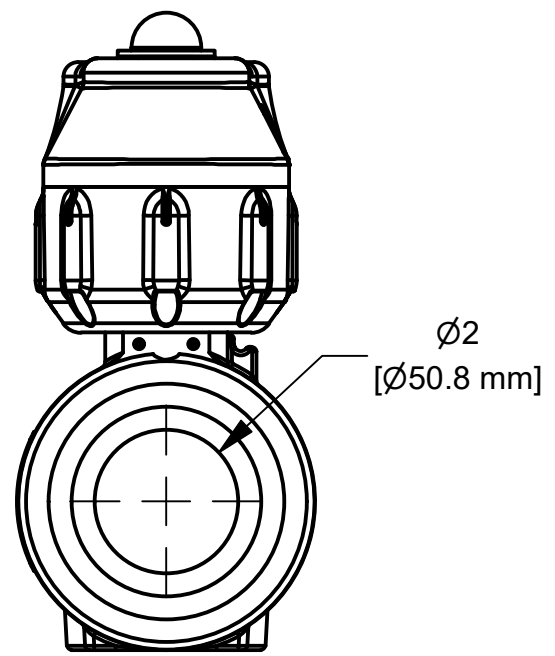
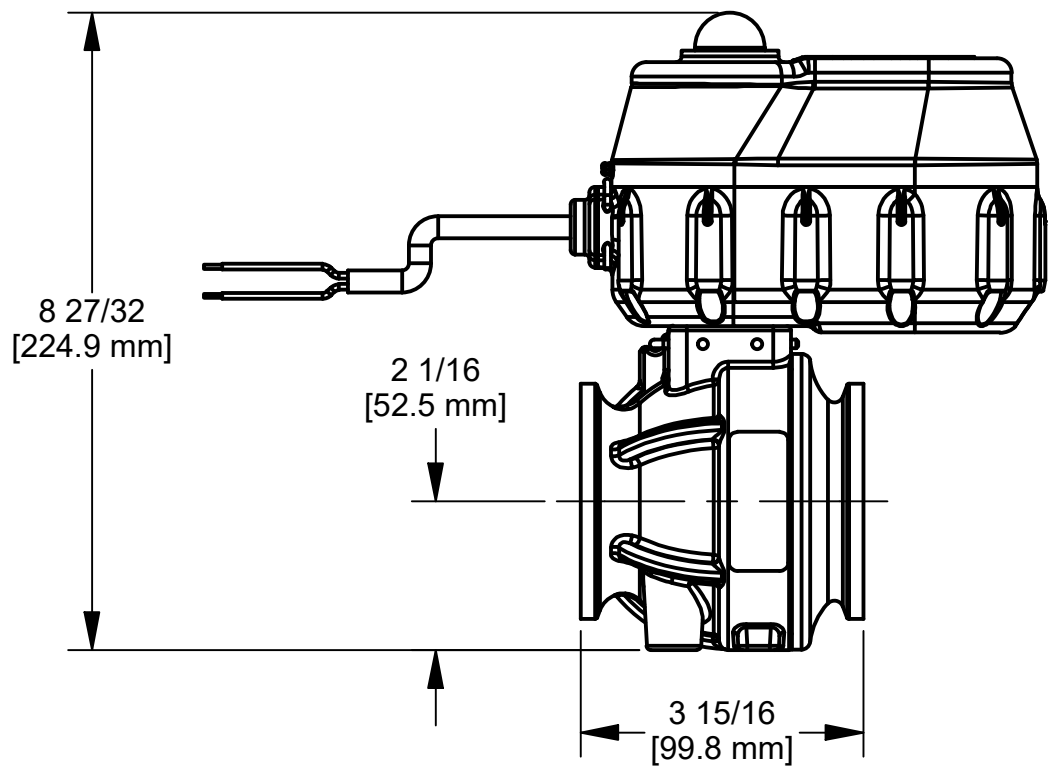

THIS DRAWING AND ALL INFORMATION CONTAINED THEREON ARE THE EXCLUSIVE PROPERTY OF BANJO CORPORATION.  
 UNLESS SPECIFICALLY NOTED, THIS DRAWING AND ITEMS SHOWN ON THIS DRAWING ARE SUBJECT TO CHANGE AT ANY TIME.

**BANJO CORPORATION**  
 150 BANJO DRIVE, CRAWFORDSVILLE, IN 47933  
 WEB SITE: WWW.BANJOCORP.COM  
 E-MAIL: BANJOSALES@IDEXCORP.COM

DESCRIPTION  
 MEVX 2"FP 4S 2W REG

PART NUMBER  
 MEVXR2W220