

NOTES:
 CABLE LENGTH: 18" ± 1" FROM HOUSING.

WIRING:
 PIN C: RED = +12VDC (OPEN)
 PIN B: BLACK = GND (OPEN)
 RED = GND (CLOSE)
 BLACK = +12VDC (CLOSE)
 PIN A: PLUG

Parts List			
ITEM	QTY	PART NUMBER	DESCRIPTION
1	1	EP31C02210	EVX ACT 3S 2W REG
2	1	EVP20001	EV U-PIN
3	1	MEVX220HX	2" FP MEVX VALVE ONLY
4	2	VE001	CABLE SEAL
5	1	VE005	CAVITY PLUG
6	1	VE009	3 TERMINAL MALE TOWER
7	2	VE010	FEMALE TERMINAL

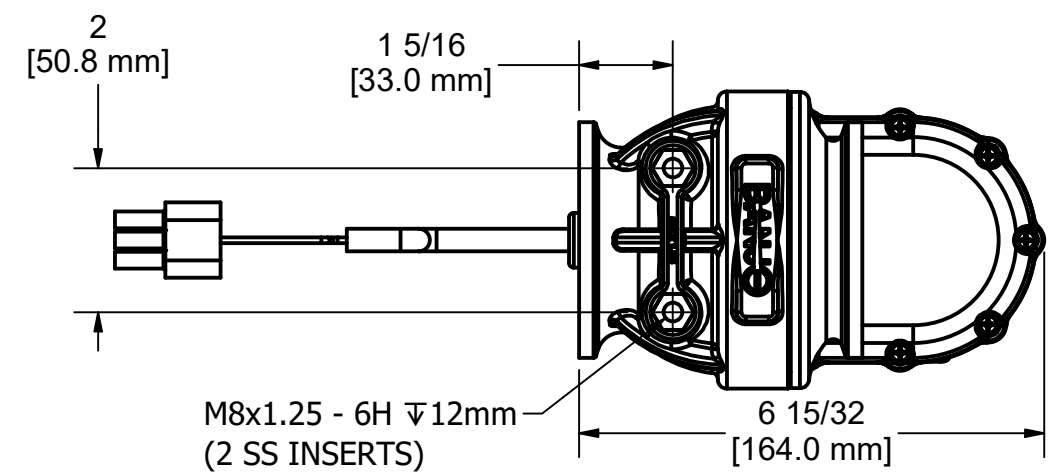
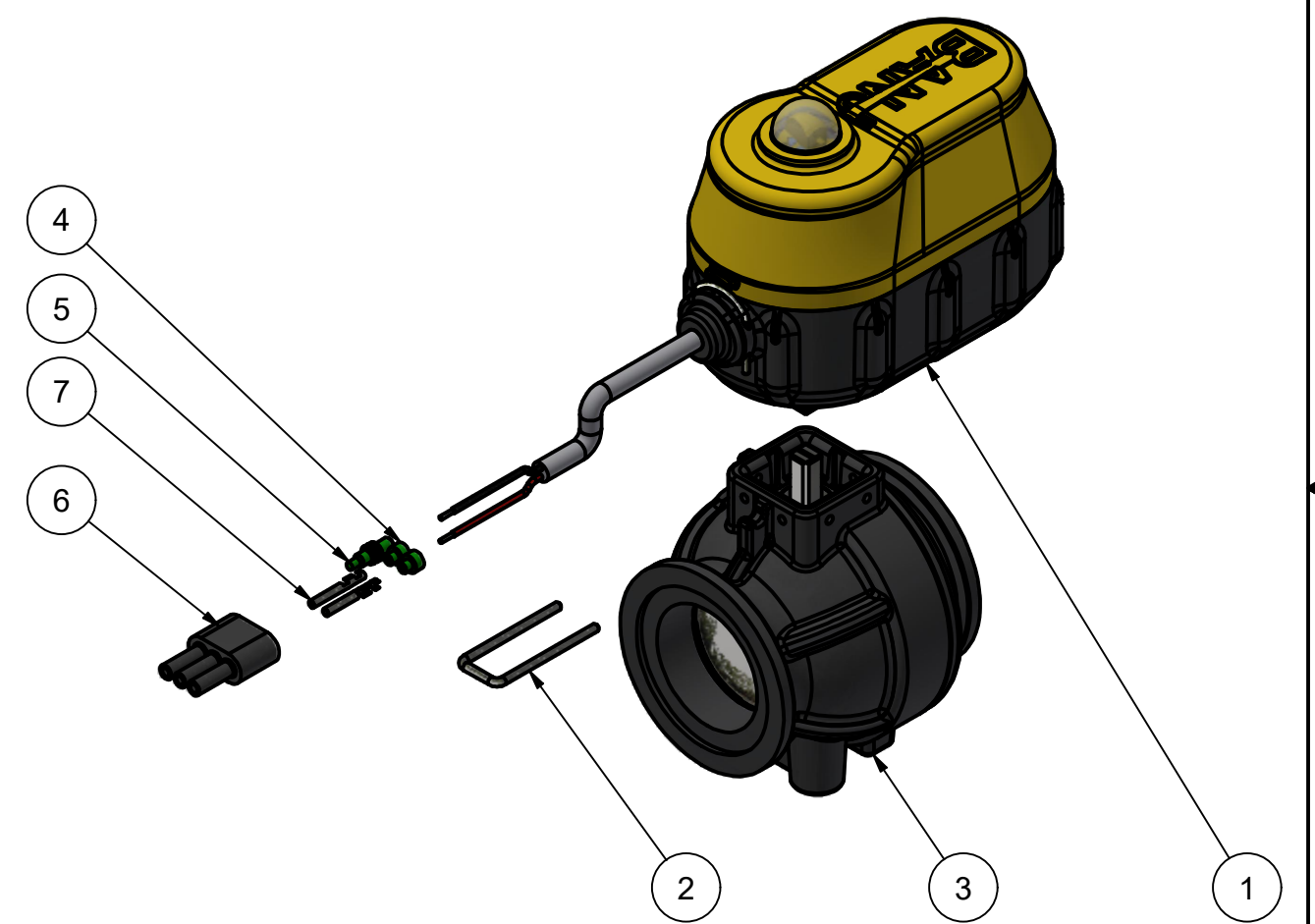
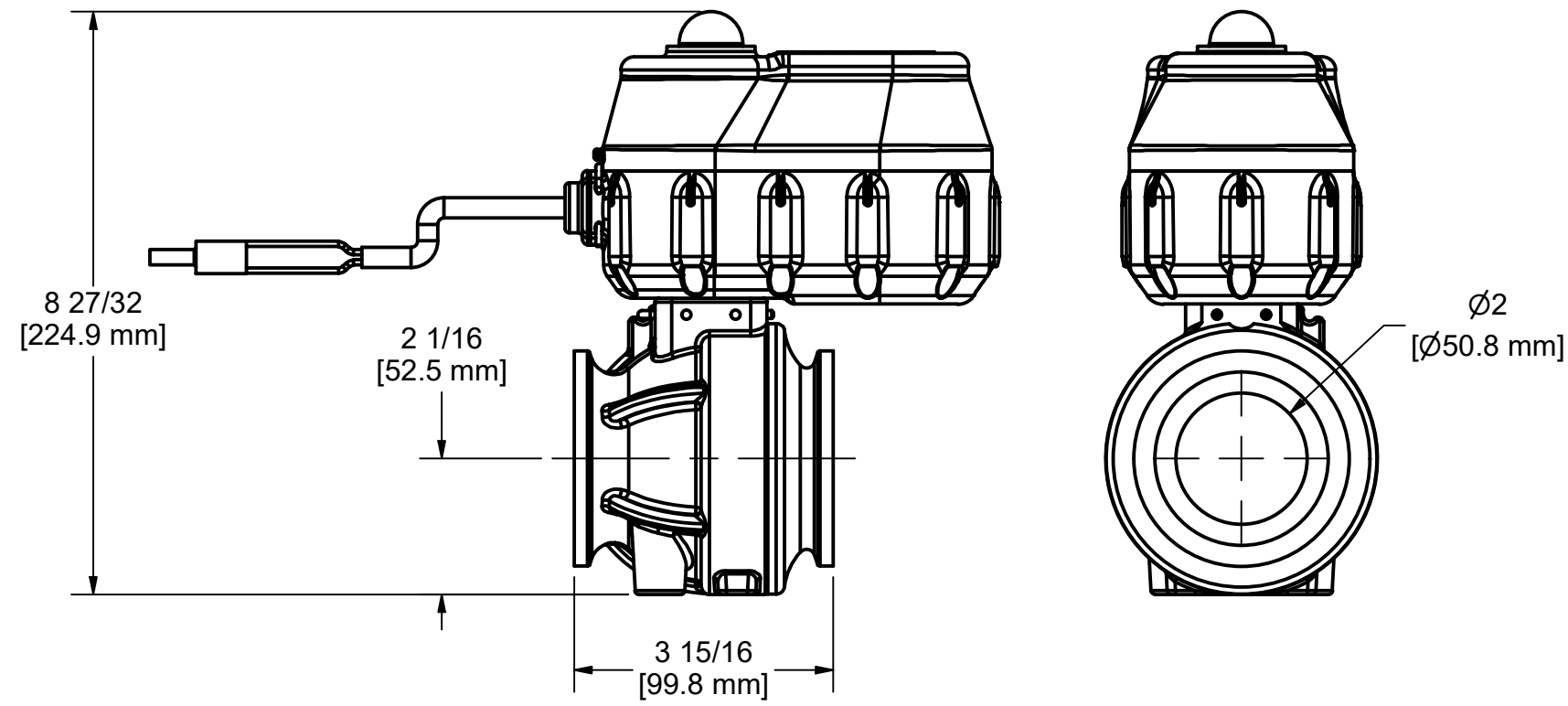

THIS DRAWING AND ALL INFORMATION CONTAINED THEREON ARE THE EXCLUSIVE PROPERTY OF BANJO CORPORATION.

UNLESS SPECIFICALLY NOTED, THIS DRAWING AND ITEMS SHOWN ON THIS DRAWING ARE SUBJECT TO CHANGE AT ANY TIME.

BANJO CORPORATION

150 BANJO DRIVE, CRAWFORDSVILLE, IN 47933
 WEB SITE: WWW.BANJOCORP.COM
 E-MAIL: BANJOSALES@IDEXCORP.COM

DESCRIPTION
 MEVX 2"FP 4S 2W REG, APBBCR

PART NUMBER
 MEVXR2W220A