

NOTES:

WIRING:

RED = +12VDC (OPEN)
 BLACK = GND (OPEN)

RED = GND (CLOSE)
 BLACK = +12VDC (CLOSE)

WIRE LENGTH: 18" ± 1"

PARTS LIST			
ITEM	QTY	PART NUMBER	DESCRIPTION
1	1	EP61C02210	EVX ACT 4S 2W REGULATING
2	1	EVP30001	EV U-PIN
3	1	MEVX300HX	MEVX 3" STUBBY VALVE ONLY

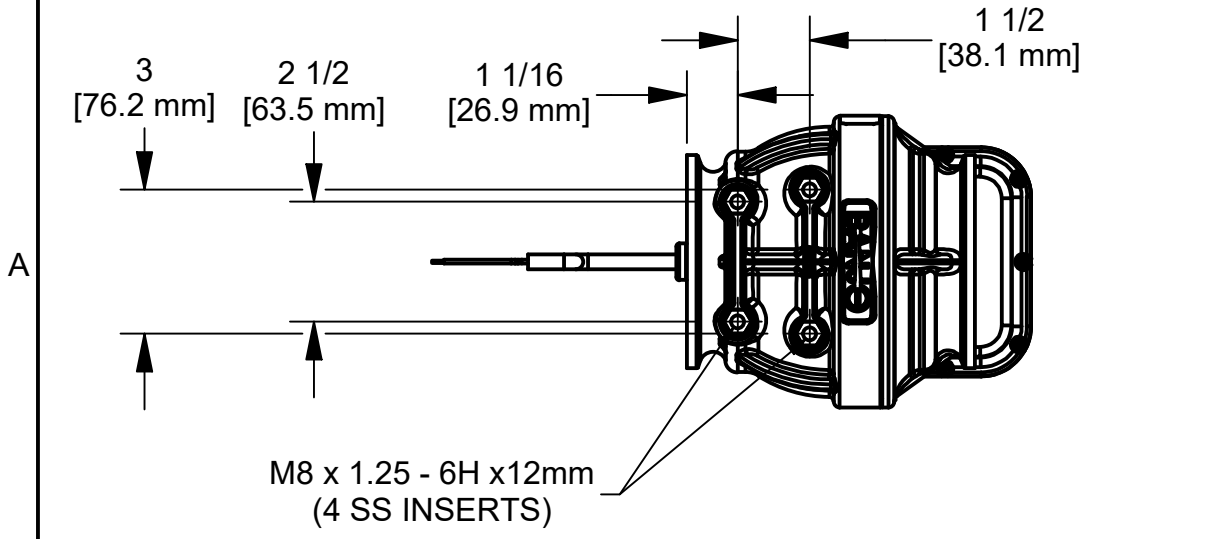
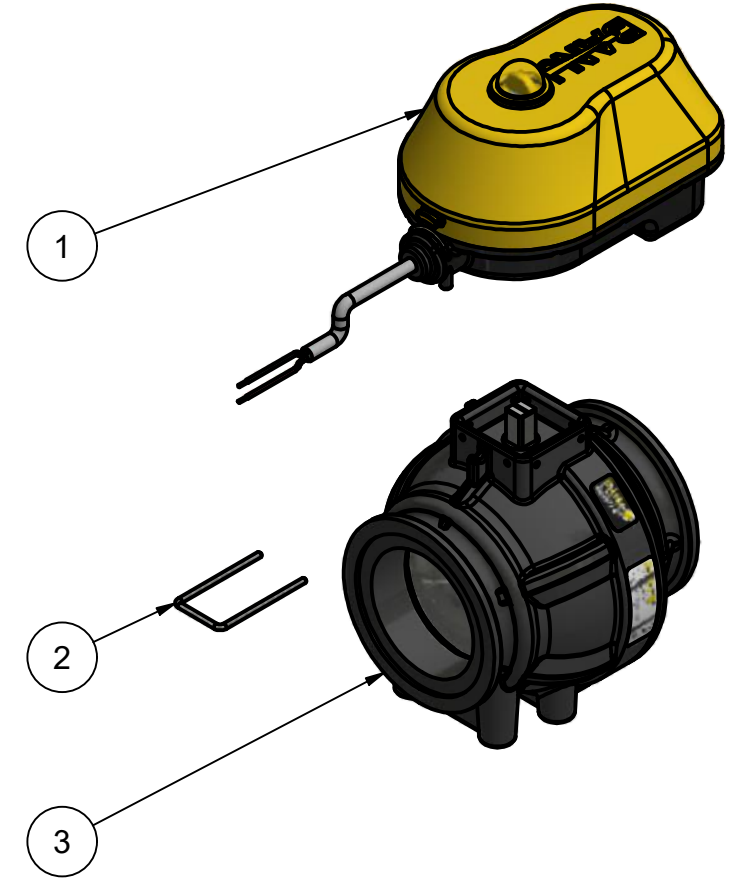
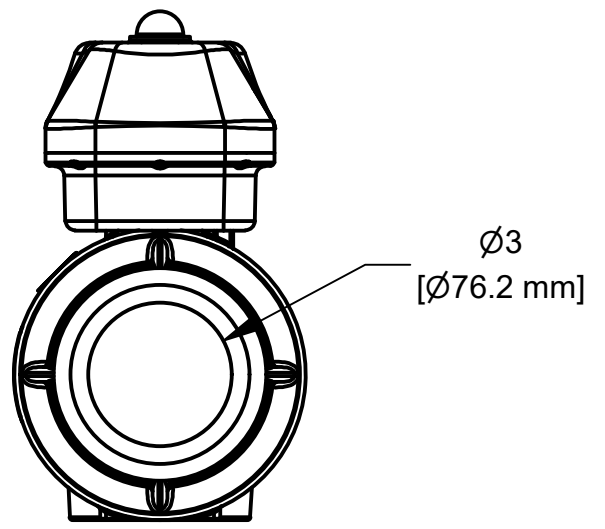
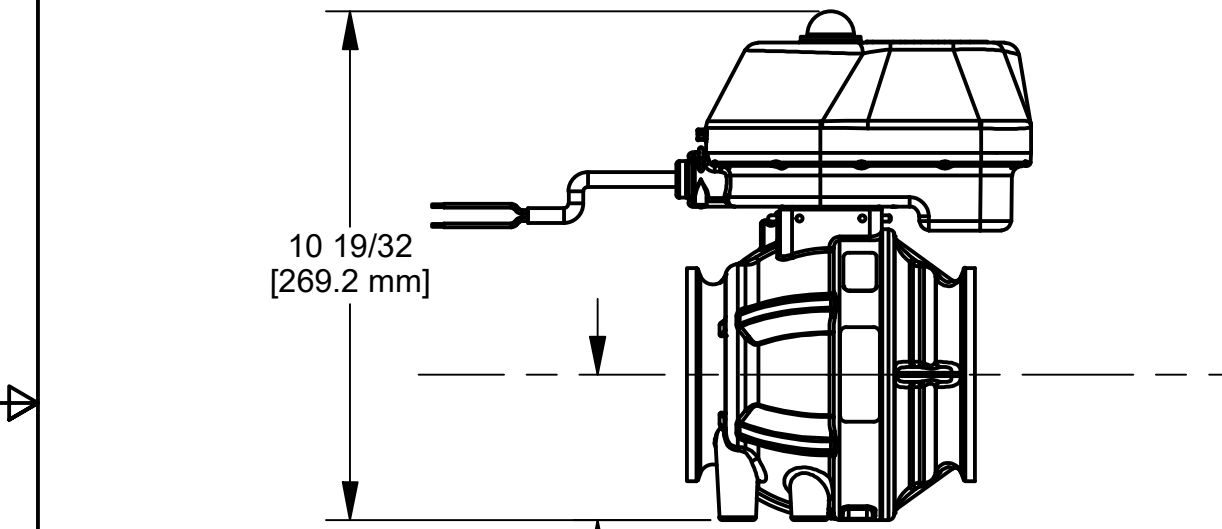

THIS DRAWING AND ALL INFORMATION CONTAINED THEREON ARE THE EXCLUSIVE PROPERTY OF BANJO CORPORATION.

UNLESS SPECIFICALLY NOTED, THIS DRAWING AND ITEMS SHOWN ON THIS DRAWING ARE SUBJECT TO CHANGE AT ANY TIME.

BANJO CORPORATION

BANJO CORPORATION
 150 BANJO DRIVE, CRAWFORDSVILLE, IN 47933
 WEB SITE: WWW.BANJOCORP.COM
 E-MAIL: BANJOSALES@IDEXCORP.COM

DESCRIPTION
 MEVX 3"FP 4S WWC 3W

PART NUMBER
 MEVXR2W300