

NOTE:
 SCREENS SOLD SEPARATELY, SCREEN PART NUMBERS LISTED BELOW, ALL SCREENS 316SS.

STRAINER PART NO.	SCREEN PART NO.	MESH SCREEN	WIRE DIA.	OPENING
MLS220-04	LST204SS	4	.047	.203
MLS220-06	LST206SS	6	.035	.132
MLS220-08	LST208SS	8	.028	.097
MLS220-10	LST210SS	10	.025	.075
MLS220-16	LST216SS	16	.018	.044
MLS220-30	LST230SS	30	.012	.021
MLS220-50	LST250SS	50	.009	.011
MLS220-80	LST280SS	80	.0055	.007
MLS220-100	LST2100SS	100	.0045	.005

Parts List

ITEM	QTY	PART NUMBER	DESCRIPTION
1	1	LST1225D	225 PSI DECAL (N/S)
2	1	MLS220B	2" FP LINE STRAINER BODY
3	1	MLS220C	2" FP FLANGED STRAINER CAP ASSEMBLY
4	1	MLS220G	MLS220 GASKET EPDM
5	1	MLS220R	FLANGE CLAMP FOR 2" FP MANIFOLD LINE STRAINER

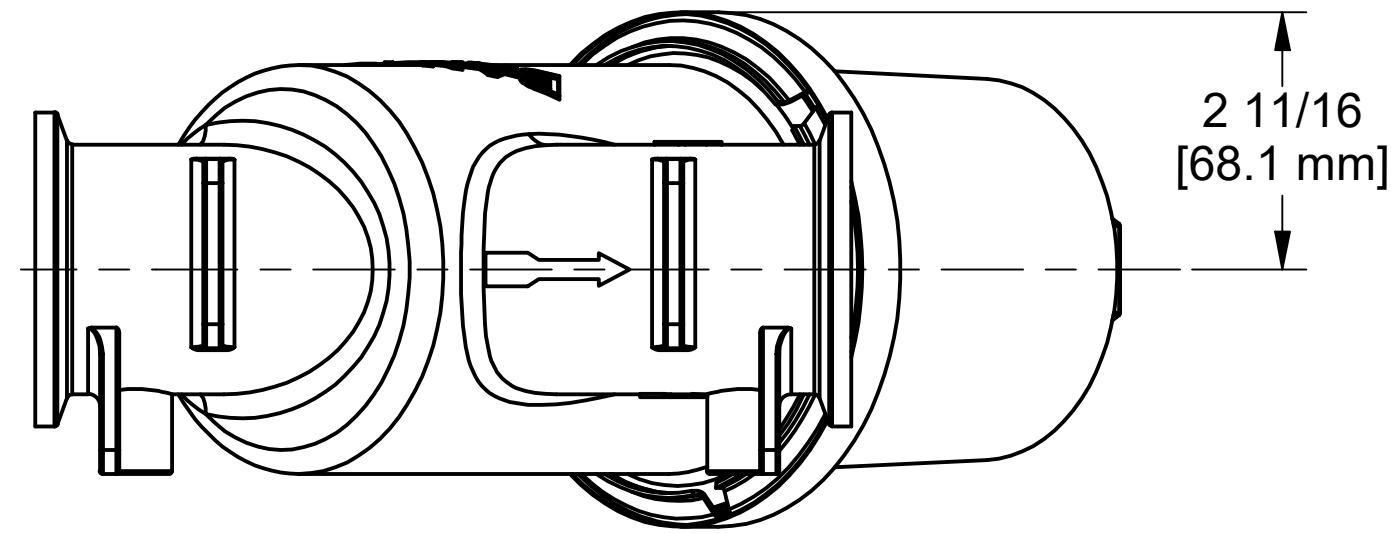

*NOTE:
 ADDITIONAL CLEARANCE REQ'D FOR SCREEN REMOVAL: 9 5/8"

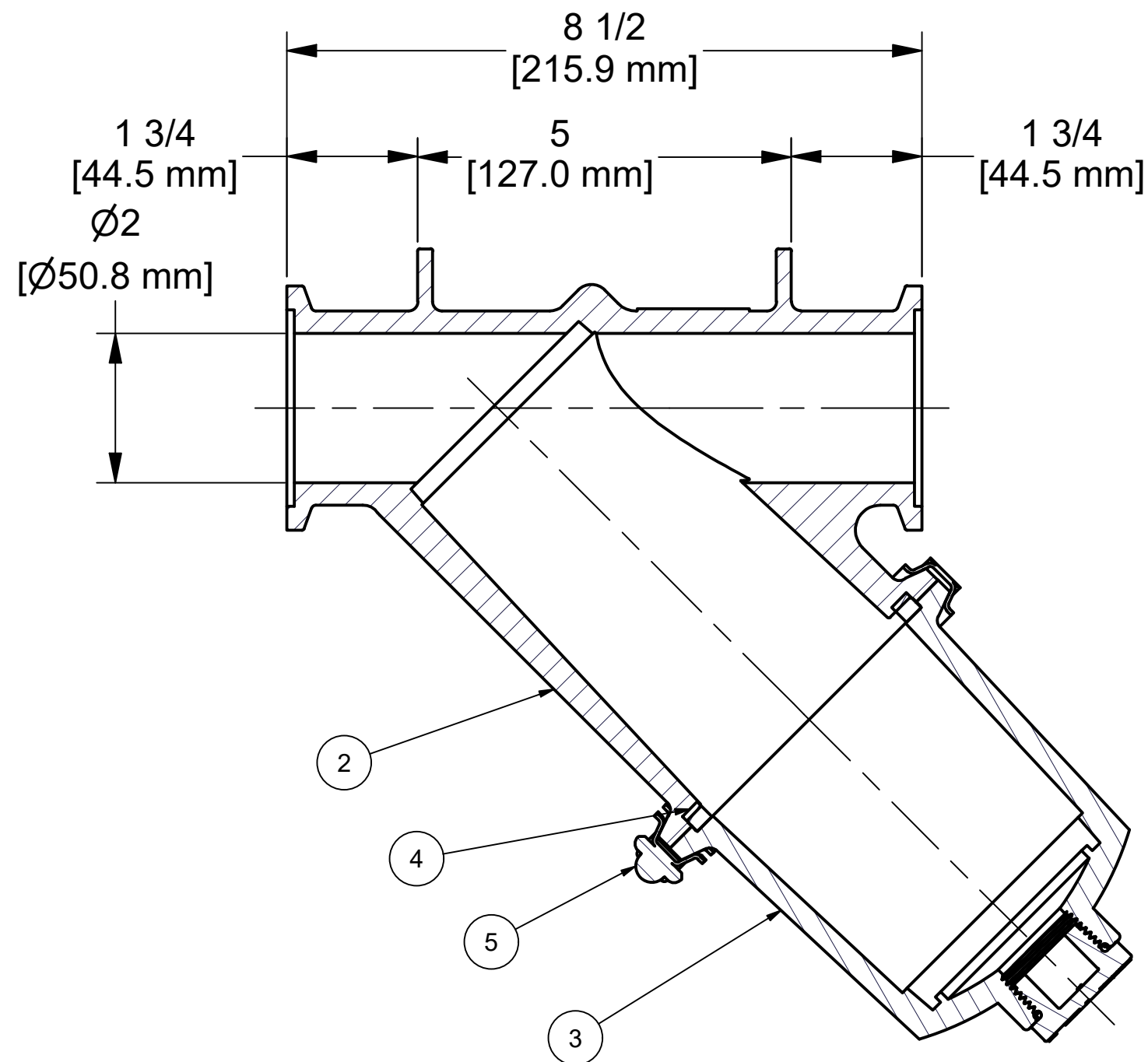

SECTION A-A
 SCALE 1 / 2

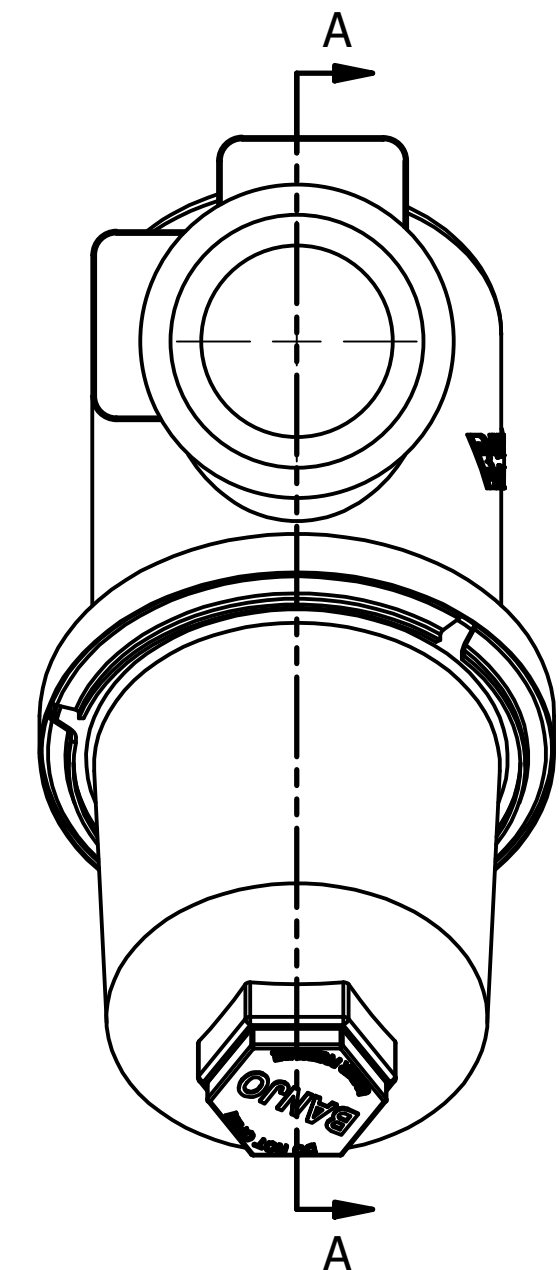
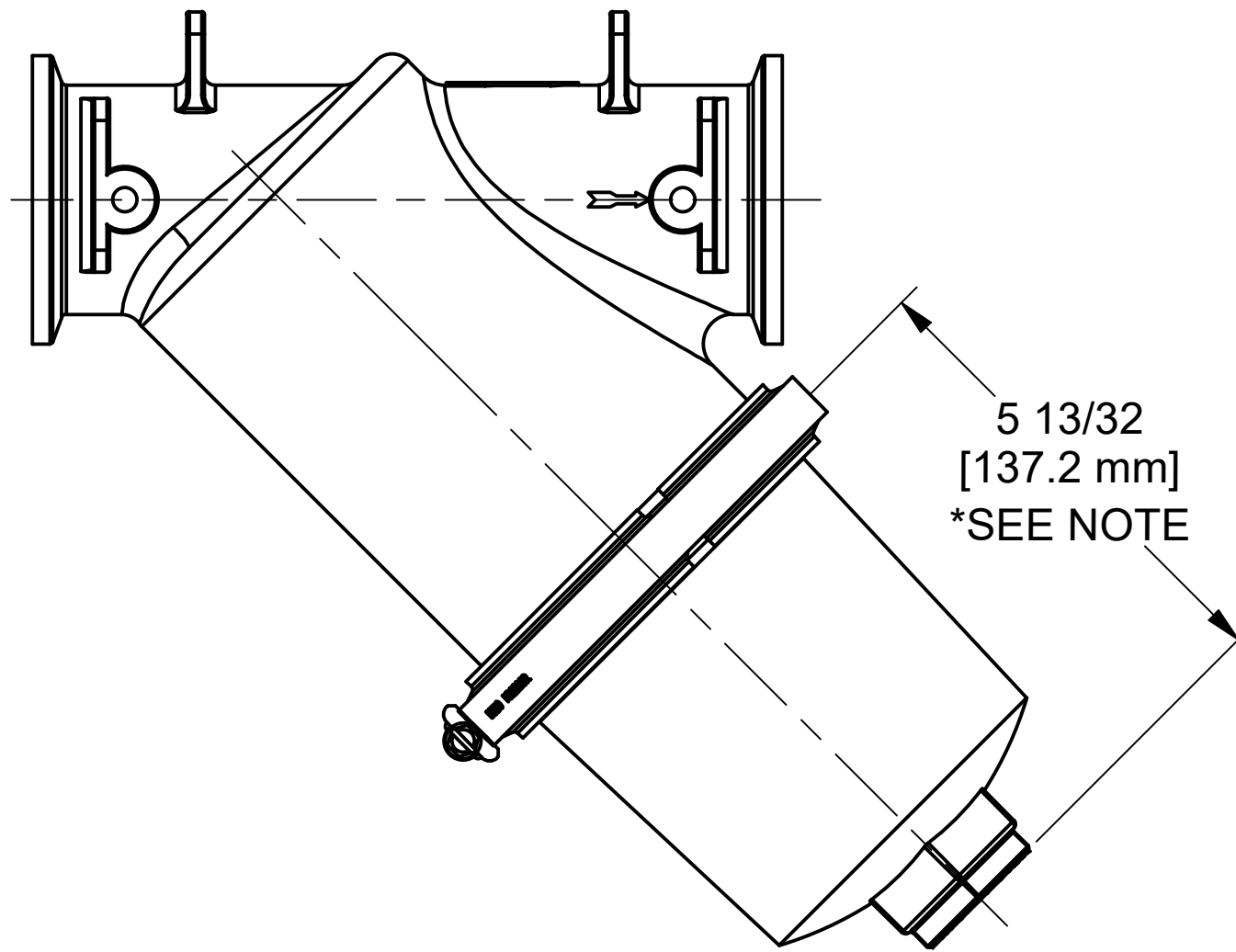

THIS DRAWING AND ALL INFORMATION CONTAINED THEREON ARE THE EXCLUSIVE PROPERTY OF BANJO CORPORATION.

UNLESS SPECIFICALLY NOTED, THIS DRAWING AND ITEMS SHOWN ON THIS DRAWING ARE SUBJECT TO CHANGE AT ANY TIME.



BANJO CORPORATION
 150 BANJO DRIVE, CRAWFORDSVILLE, IN 47933
 WEB SITE: WWW.BANJOCORP.COM
 E-MAIL: BANJOSALES@IDEXCORP.COM

DESCRIPTION
 2" FP Y - LINE STRAINER

PART NUMBER
 MLS220BC