

HOLE FOR OPTIONAL MOUNTING.
5/16" NUTS AND WASHERS INSIDE.
(4 PLACES)

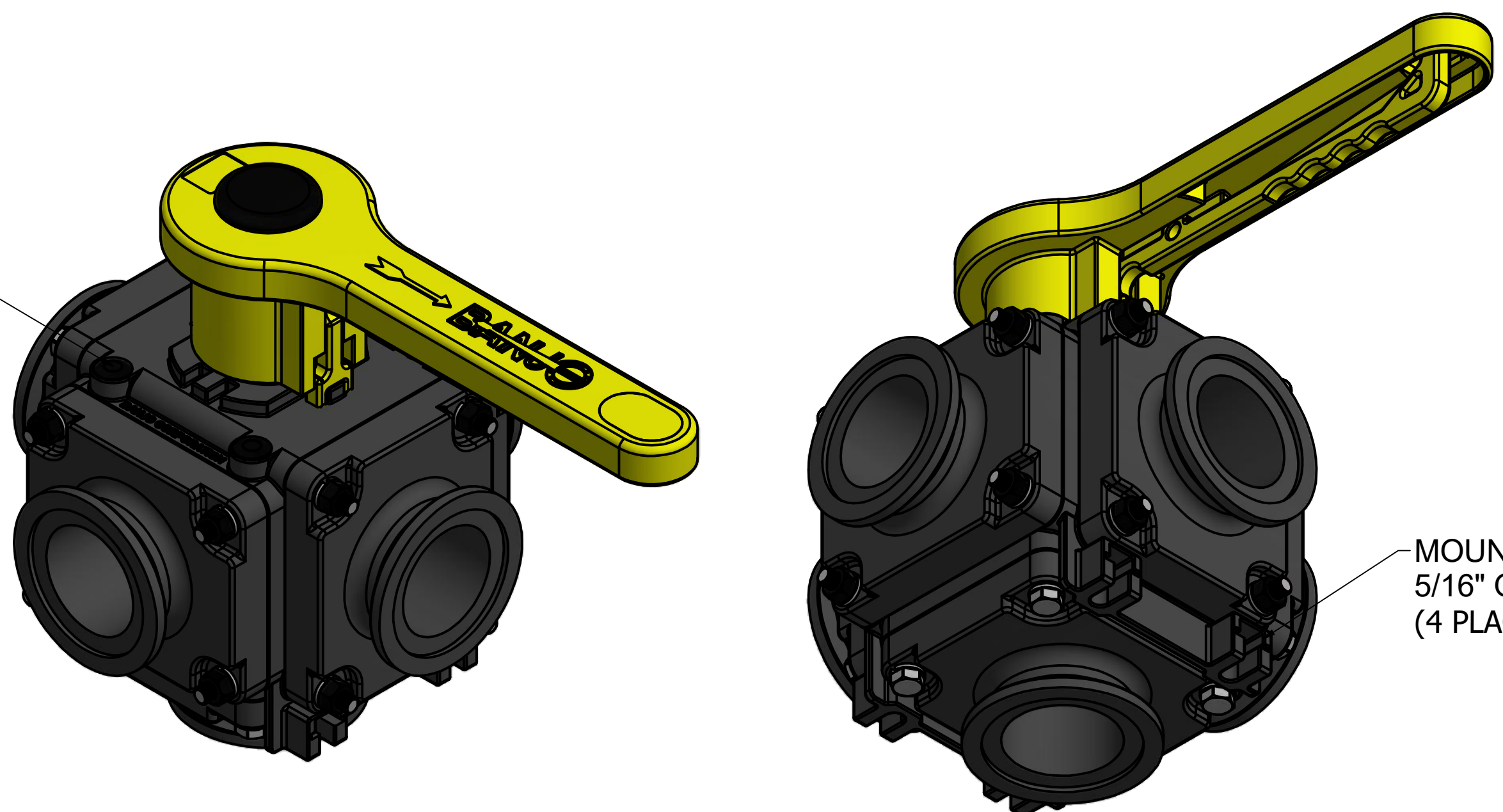

MOUNTING SLOT FOR
5/16" OR M8 WASHER AND BOLT
(4 PLACES)

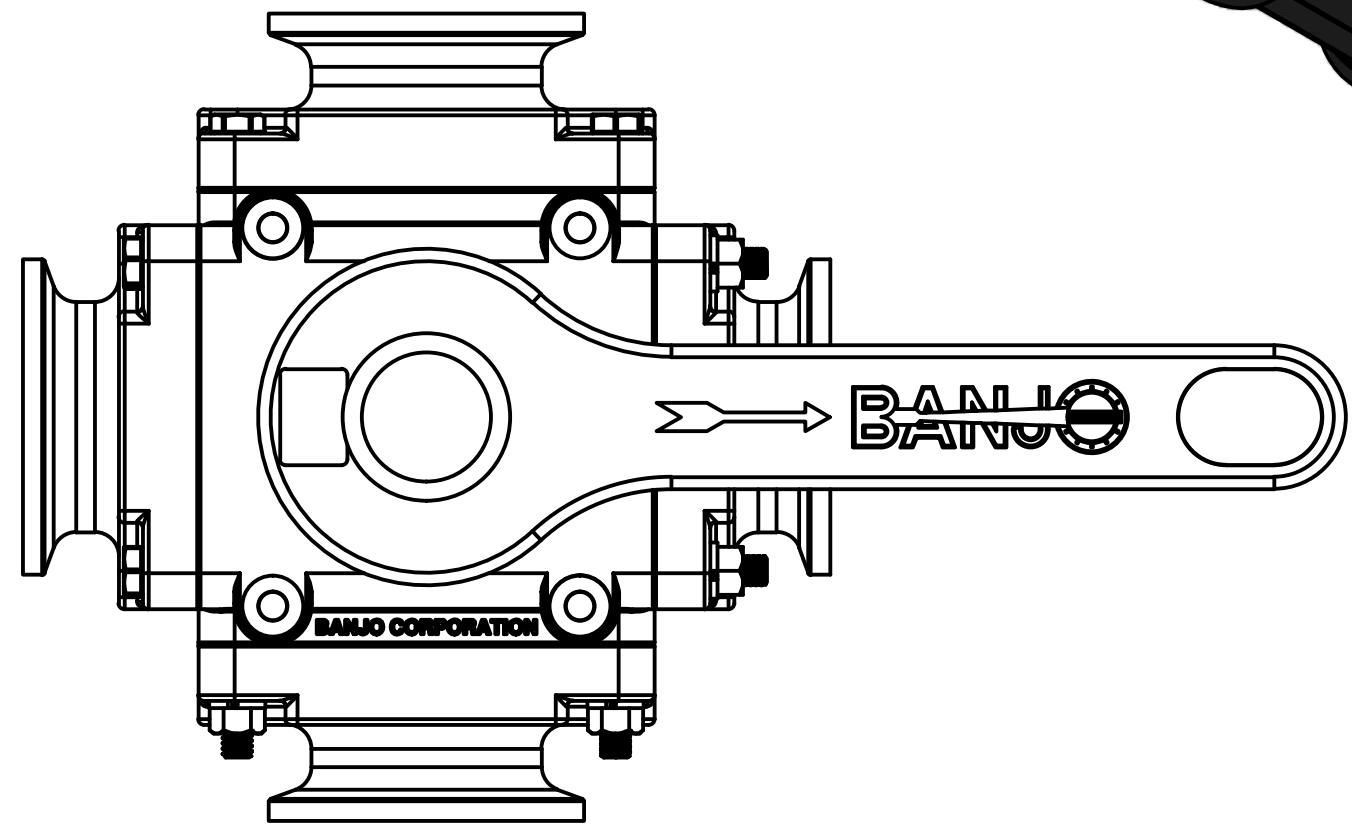

Parts List			
ITEM	QTY	PART NUMBER	DESCRIPTION
1	8	12901	5/16" FLAT WASHER
2	5	A232V	2-232 FKM O-Ring
3	1	A238V	2-238 FKM O-ring
4	8	B0516650	5/16"-18x6.50 HHCS 18-8SS
5	4	BF107	5/16-18 X 2 1/4" HHCS
6	4	PIP0716	7/16" Push In Plug, PE, Black
7	12	V10118	5/16" LOCKWASHER
8	16	V10119	5/16" HEX NUT
9	1	V25020	3/8" Handle Bolt
10	1	V25060	VALVE STEM THRUST BEARING
11	1	V25121	3/8" Fender Washer
12	1	V25151B	STEM 2"FP & 3"FP, MACHINED
13	1	V25160	Stem Bushing
14	1	V25163	#214 FKM O'RING
15	1	V25502	3/4" Cap Plug
16	1	V25503	5 Way Handle Locking Tab
17	1	V25508	5-WAY 2" FP ENDPLATE SPACER
18	1	V25553AX	5 Way 2" FP Handle
19	1	V25554AX	5 Way 2" FP Body
20	1	V25555	2" FP 5-WAY VALVE BALL, TUMBLED
21	4	V25558D	Machined TFE Seat No Lube Mod
22	5	V25578A	2" FP M220 5-WAY VALVE EP, MACHINED

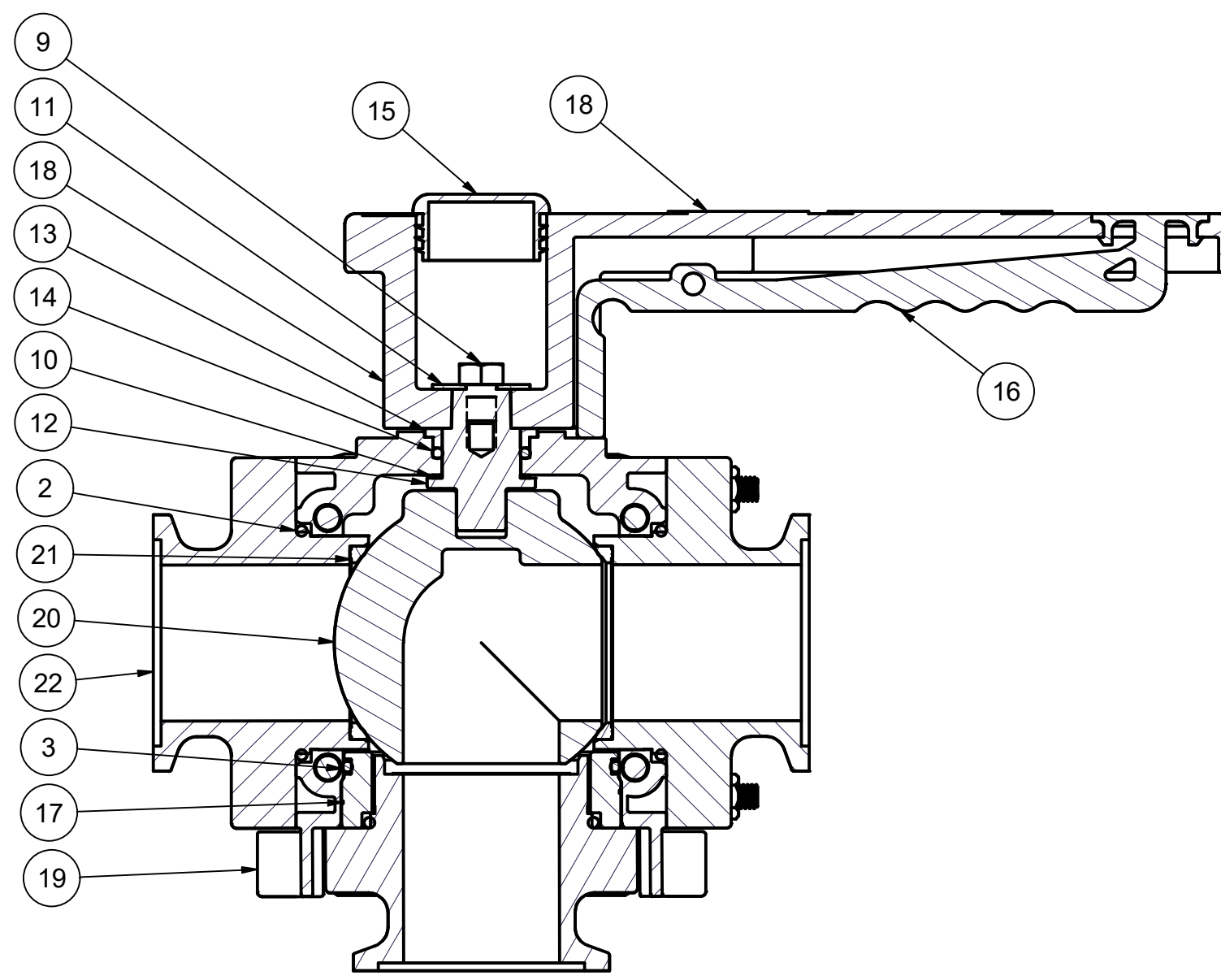
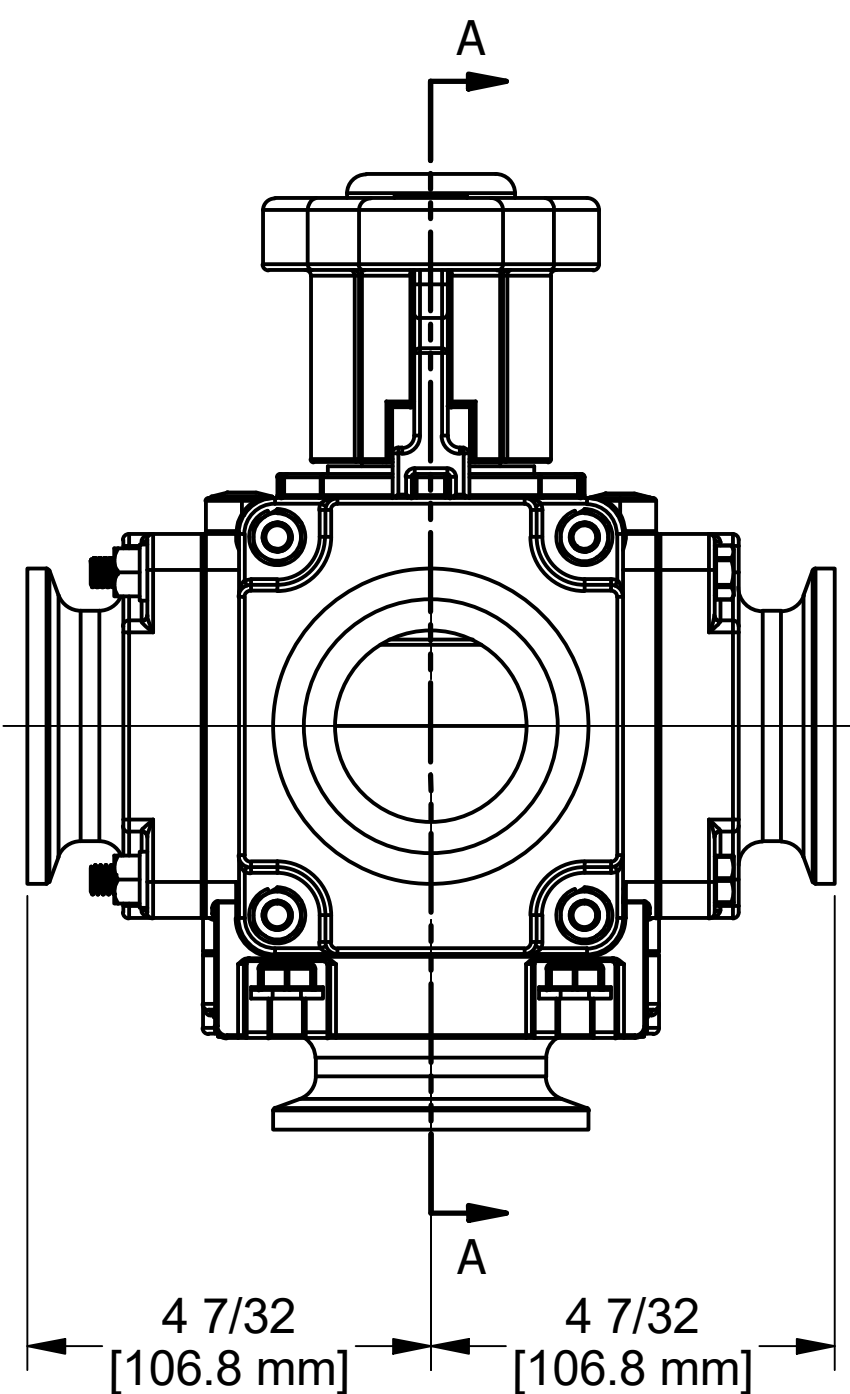
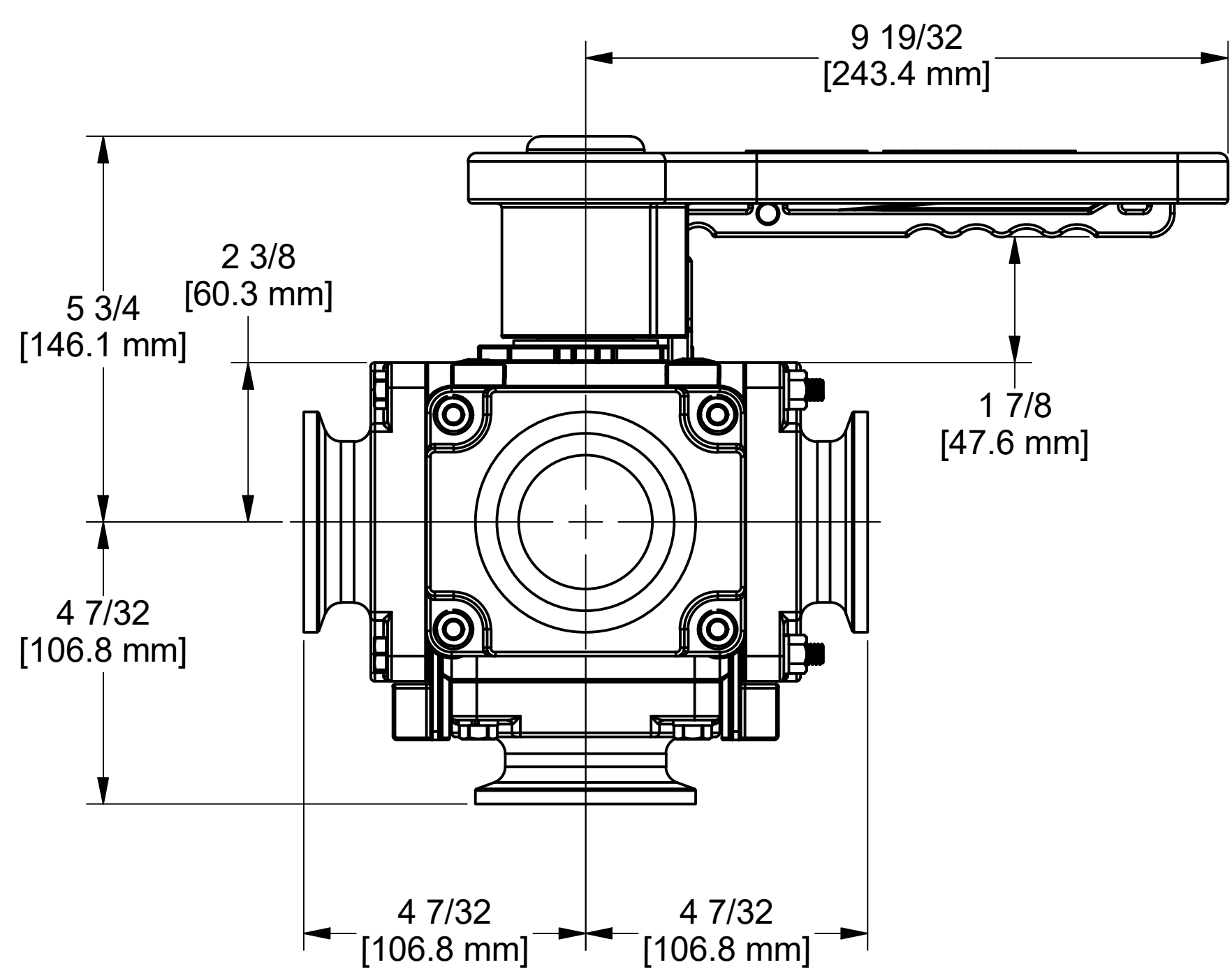

SECTION A-A



THIS DRAWING AND ALL INFORMATION CONTAINED THEREON ARE THE EXCLUSIVE PROPERTY OF BANJO CORPORATION.
UNLESS SPECIFICALLY NOTED, THIS DRAWING AND ITEMS SHOWN ON THIS DRAWING ARE SUBJECT TO CHANGE AT ANY TIME.

BANJO CORPORATION
150 BANJO DRIVE, CRAWFORDSVILLE, IN 47933
WEB SITE: WWW.BANJO.CORP.COM
E-MAIL: BANJOSALES@DEXCORP.COM

DESCRIPTION
2" FP MANIFOLD FLANGE 5 WAY VALVE

PART NUMBER
MV225CF