

| Parts List | | | |
|------------|-------------|-------------|--|
| ITEM QTY | PART NUMBER | DESCRIPTION | |
| 1 | 200MPT | CAP | |
| 2 | 200MPTG | GASKET | |
| 3 | TL6531X | PLUG | |

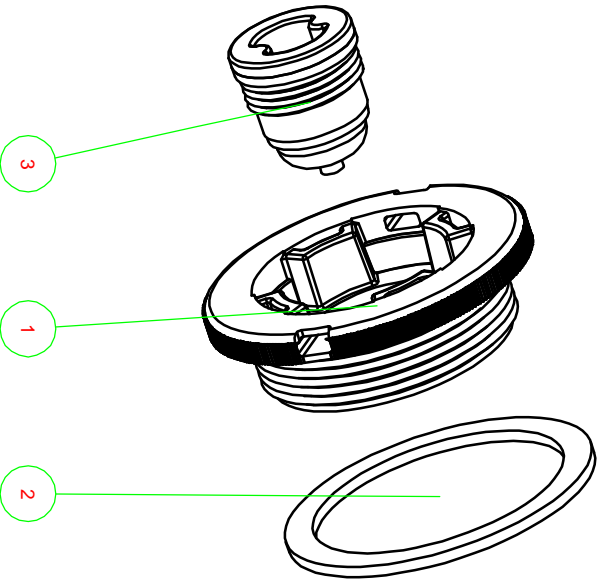

| No. | ECR# | Location | Description | Drawn By | Date |
|-----|------|----------|-------------|----------|------|
| 1 | | 2 | | | |

TOLERANCES UNLESS
 OTHERWISE SPECIFIED
 DECIMALS .00 = +/- .010
 DECIMALS .000 = +/- .005
 FRACTIONS 1/X = +/- 1/32
 ANGLES +/- 1°
 BREAK ALL SHARP CORNERS
 V/ 1/32 R UNLESS OTHERWISE
 SPECIFIED



BANNUO CORPORATION
 150 BANNUO DR. # CRAWFORDSVILLE, IN 47933

| | | | |
|----------|--------|------------|-------------------------------|
| PART NO. | TL6531 | TITLE | 2" Vented Tank Plug w/ Gasket |
| DWN ETQ | | DATE | 12/26/01 |
| APP. | | SCALE | 1" = 1" |
| DWG NO. | TL6531 | SHEET SIZE | II |
| SHEET | 1 | REV | 0 |