

2



1

REVISION HISTORY

ZONE	REV	DESCRIPTION	DATE	APPROVED
	0	Redrew in Inventor	12/01/2010	ALR

B

B

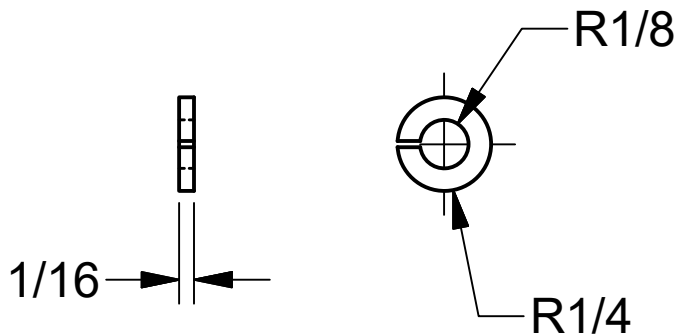

Note:

Purchased Item  
 1/4" A.N.S. Reg. Helical Spring LockWasher  
 Matl: 18-8 SS  
 Per ANSI/ASME B18.21.1-1990

A

A

TOLERANCE UNLESS OTHERWISE SPECIFIED DECIMALS 0.00 = +/- 0.010 DECIMALS 0.000 = +/- 0.005 FRACTIONS 1/X = +/- 1/32 ANGLES = +/- 1 BREAK ALL SHOWN CORNERS W/ 1/32 R UNLESS OTHERWISE SPECIFIED			
DRAWN Aaron		4/4/2000	
		<b>BANJO CORPORATION</b> 150 BANJO DRIVE, CRAWFORDSVILLE, IN 47933	
		TITLE 1/4" LockWasher	
SIZE A	DWG TYPE ENG	DWG NO V07018	REV
SCALE		SHEET 1 OF 1	

2



1