

PARTS LIST			
ITEM	QTY	PART NUMBER	DESCRIPTION
1	6	V20018	3/8" LOCKWASHER
2	6	V20019	3/8-16 HEX NUT
3	1	V25020	3/8" Handle Bolt
4	1	V25060	VALVE STEM THRUST BEARING
5	1	V25121	3/8" Fender Washer
6	1	V25151B	STEM 2"FP & 3"FP, MACHINED
7	1	V25153	2" FP HANDLE
8	1	V25160	Stem Bushing
9	1	V25163	AS568A -214 O-RING, FKM, BROWN
10	6	V30017	3/8" - 16 X 5" SS Body Bolt
11	1	V30254	3" Std Port Valve Body
12	1	V30255	3" VALVE BALL, TUMBLED
13	2	V30258A	3" FP Ball Seat
14	2	V30264	3" FNPT STANDARD PORT ENDPLATE, MACHINED
15	2	V30265	AS568A -156 O-RING, FKM, BROWN
16	1	VL1017	225 PSI PRESSURE LABEL FKM (N/S)

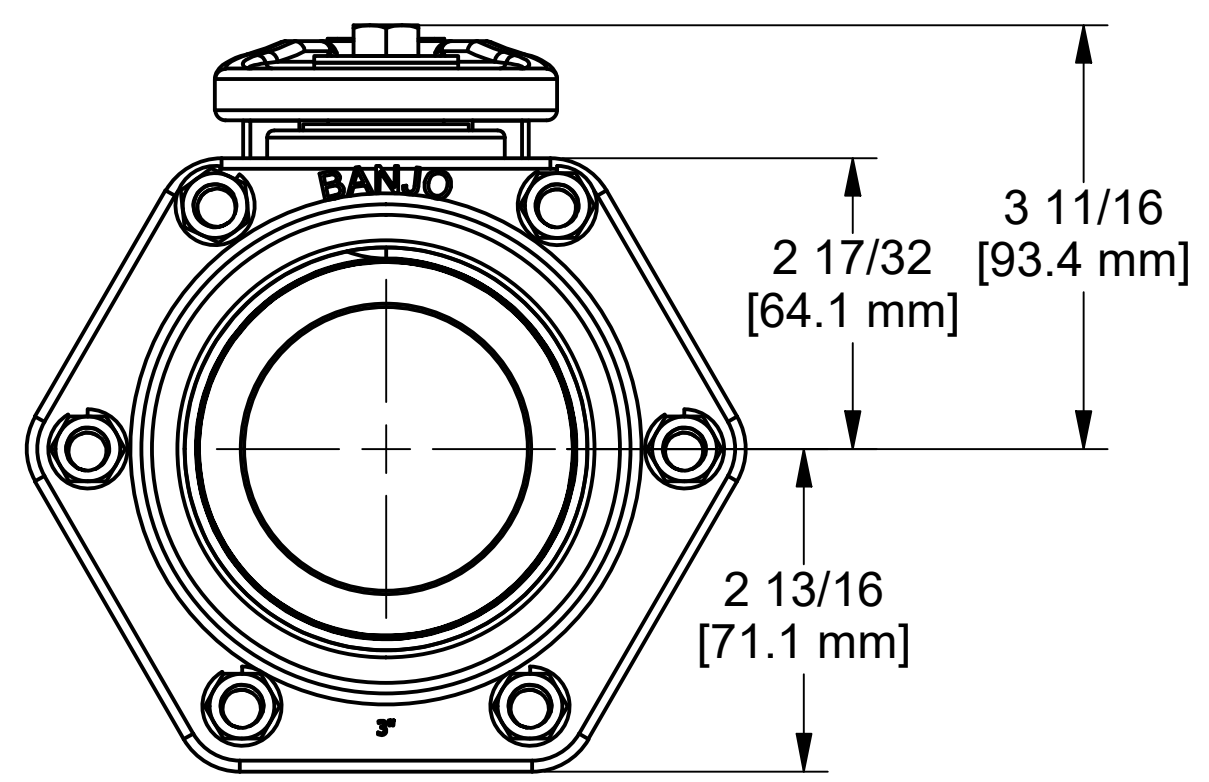
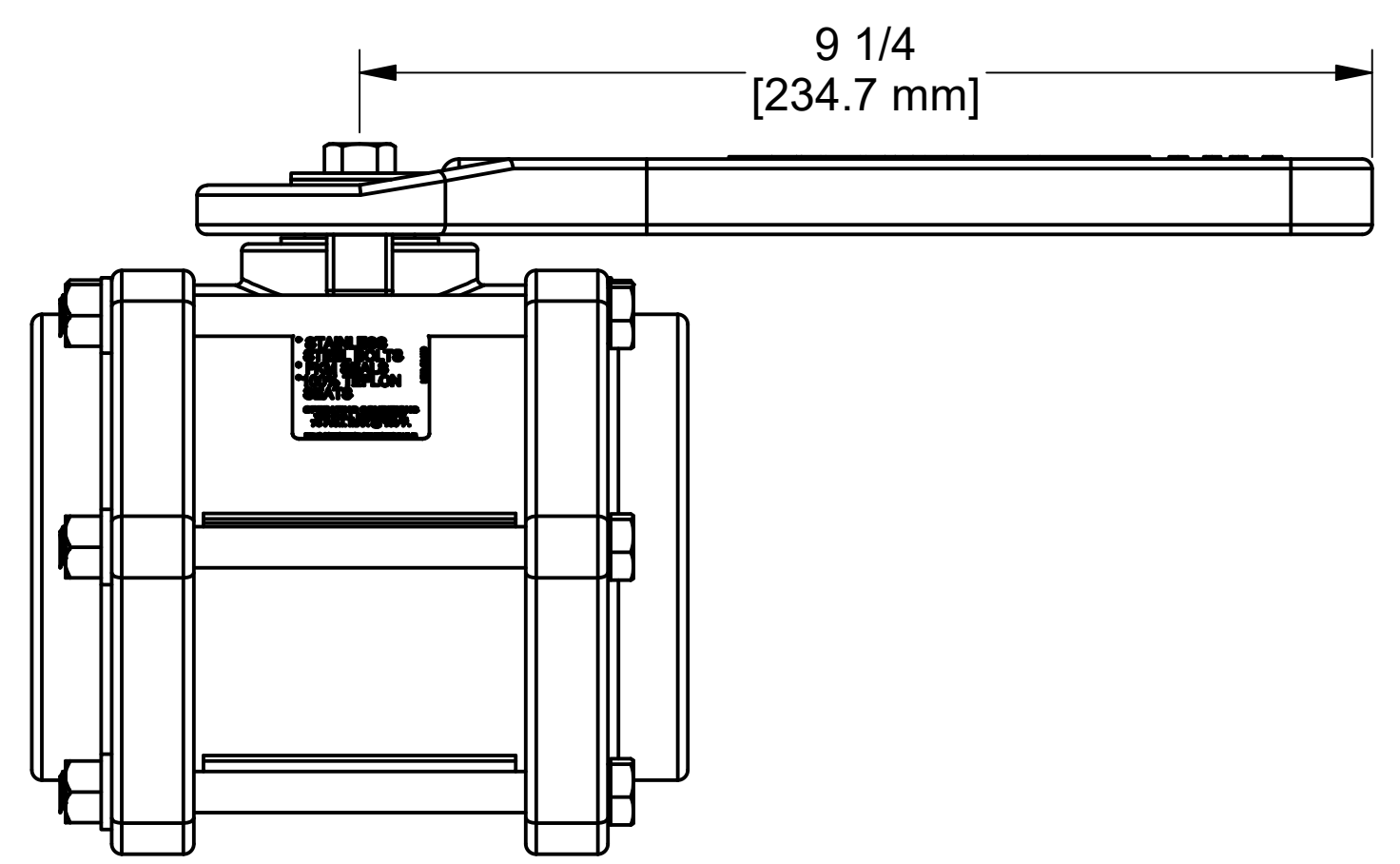
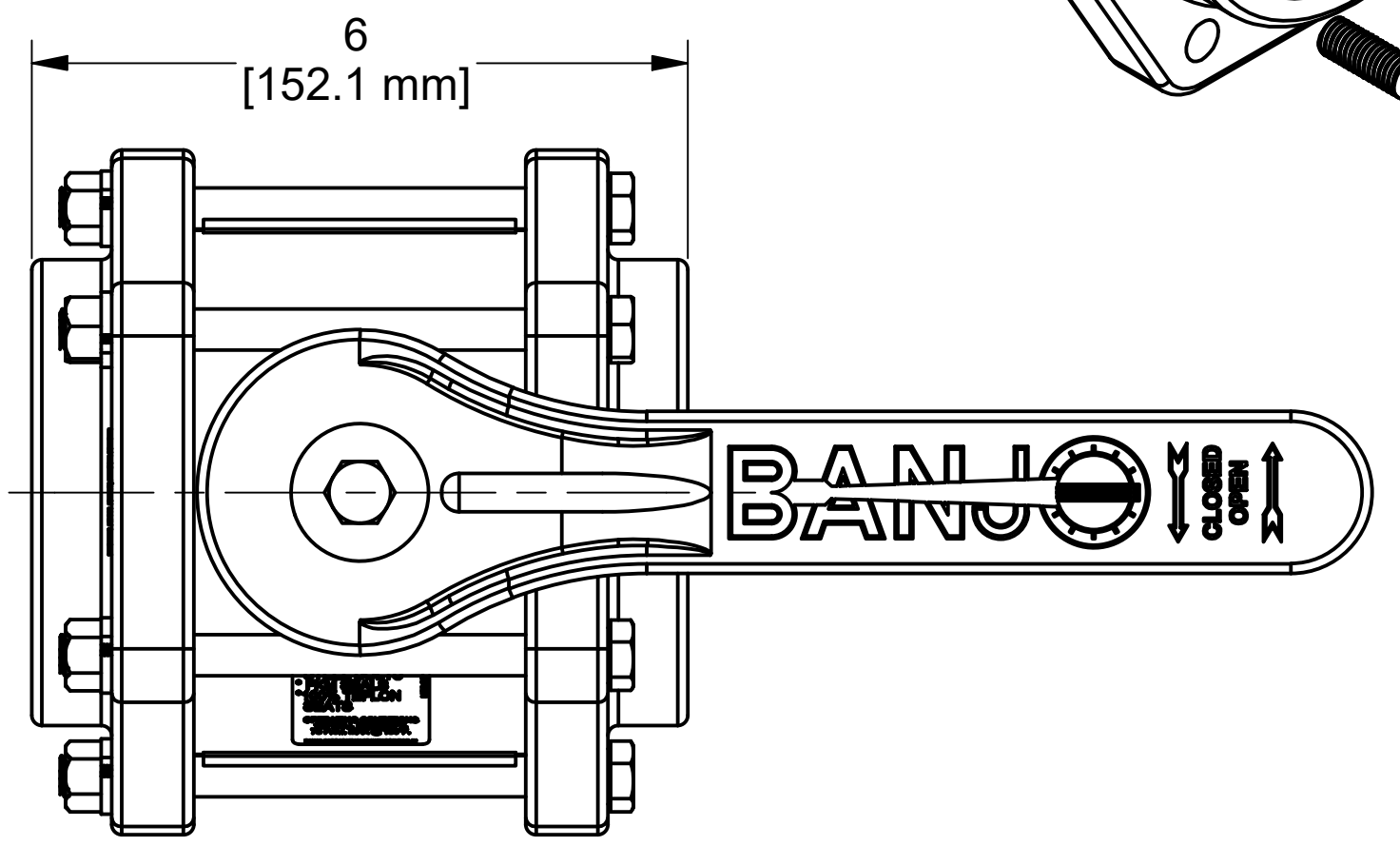
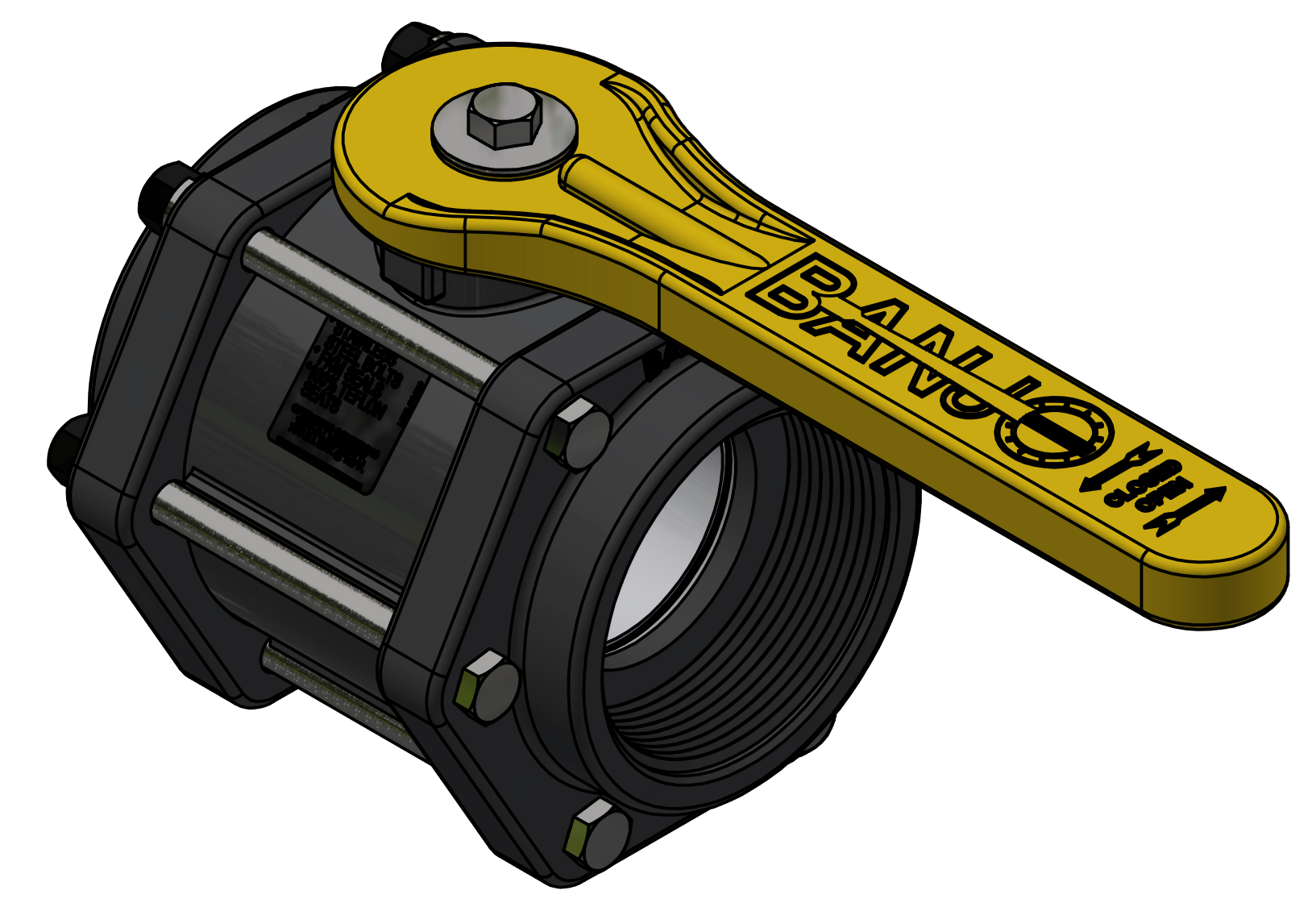

THIS DRAWING AND ALL INFORMATION CONTAINED THEREON ARE THE EXCLUSIVE PROPERTY OF BANJO CORPORATION.

UNLESS SPECIFICALLY NOTED, THIS DRAWING AND ITEMS SHOWN ON THIS DRAWING ARE SUBJECT TO CHANGE AT ANY TIME.

BANJO CORPORATION
 150 BANJO DRIVE, CRAWFORDSVILLE, IN 47933
 WEB SITE: WWW.BANJO.CORP.COM
 E-MAIL: BANJOSALES@IDEXCORP.COM

DESCRIPTION
3" BALL VALVE ASSEMBLY

PART NUMBER
V300