

Parts List			
ITEM	QTY	PART NUMBER	DESCRIPTION
1	1	211FPTX	2" NPT Yellow Cap
2	1	C25PFSLE113	Foil Seal 0.035" C25 FSLE 1-13 59mm
3	1	V22275GV	VALVE GASKET
4	1	V22283C	MALE COLLAR HALF
5	1	V22283D	FEMALE COLLAR HALF
6	1	VL001FC	GREEN AG COMPLIANT LABEL
7	1	VL1008	Check Valve Equipped Decal
8	1	VS20209	SPRING-LOK SEAL
9	1	WS20002	Pin
10	1	WS20153	2" Handle for W Valve
11	2	WS20163	2-115 O-ring, FKM
12	1	WS20255T	2" TUMBLED VALVE BALL
13	1	WS22396BC	BALL CHECK ENDPLATE
14	1	WSF20264	2" QDC WELD BODY

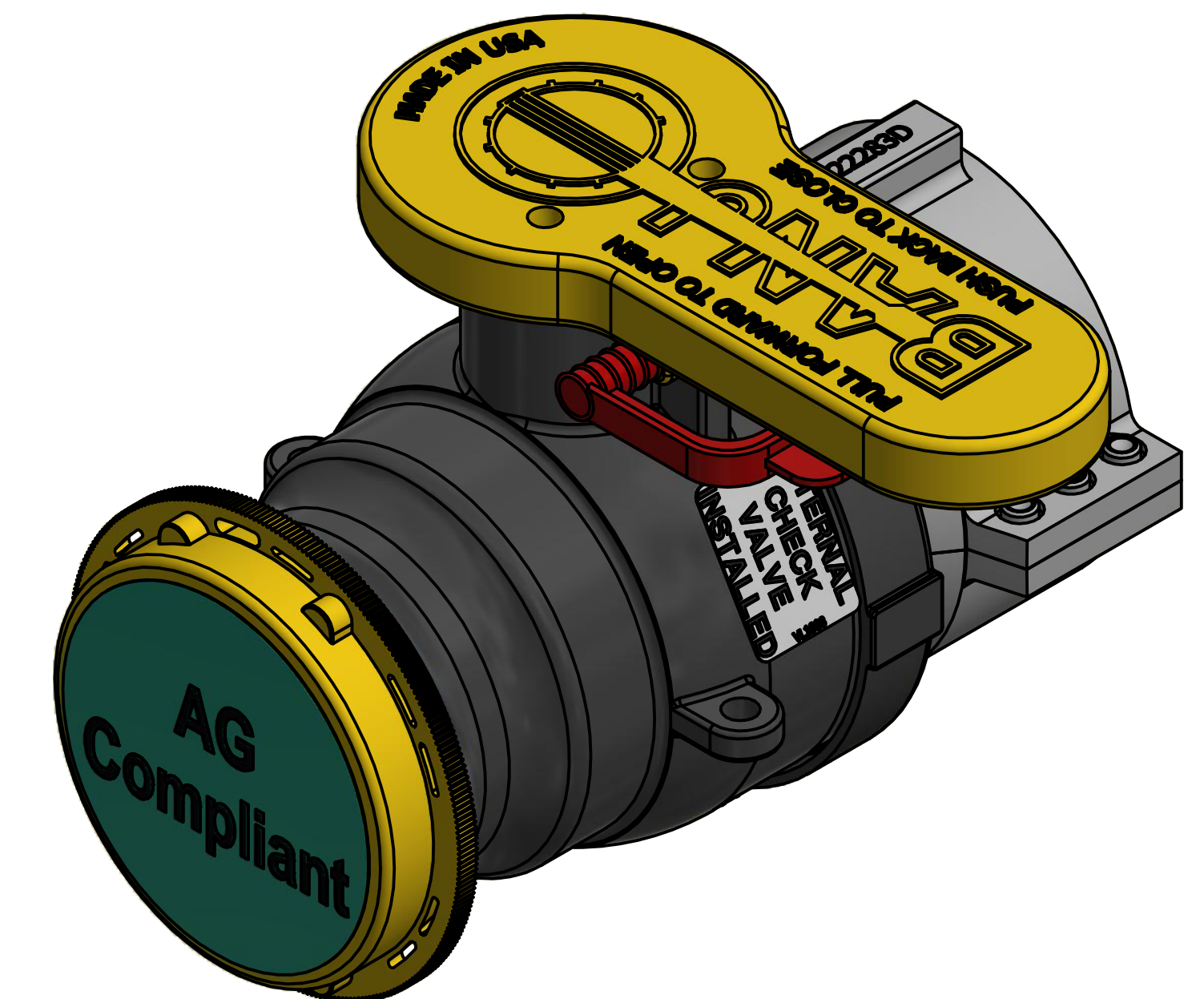

Welded valve. Individual parts shown not available for purchase.

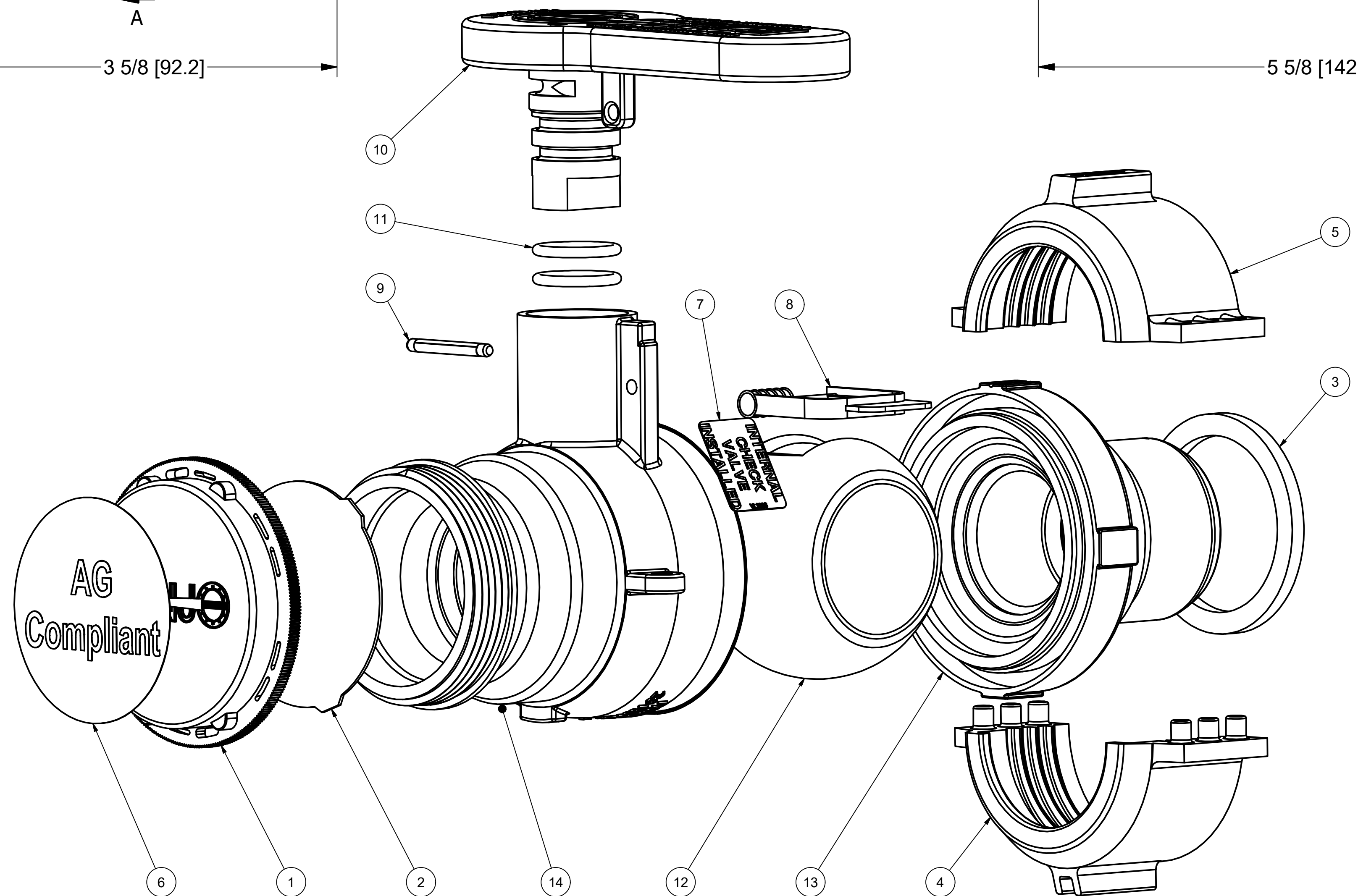

THIS DRAWING AND ALL INFORMATION CONTAINED THEREON ARE THE EXCLUSIVE PROPERTY OF BANJO CORPORATION.
UNLESS SPECIFICALLY NOTED, THIS DRAWING AND ITEMS SHOWN ON THIS DRAWING ARE SUBJECT TO CHANGE AT ANY TIME.

BANJO CORPORATION
150 BANJO DRIVE, CRAWFORDSVILLE, IN 47933
WEB SITE: WWW.BANJO.CORP.COM
E-MAIL: BANJOSALES@DEXCORP.COM

DESCRIPTION
2"OUTLET X COLLAR STBY W/FLAP CHECK

PART NUMBER
WFC230254